

Exxact Double Socket Outlet Screwless Light

User Manual

WDE002190, WDE003390, WDE004390
07/2019



Legal Information

The information provided in this document contains general descriptions, technical characteristics and/or recommendations related to products/solutions.

This document is not intended as a substitute for a detailed study or operational and site-specific development or schematic plan. It is not to be used for determining suitability or reliability of the products/solutions for specific user applications. It is the duty of any such user to perform or have any professional expert of its choice (integrator, specifier or the like) perform the appropriate and comprehensive risk analysis, evaluation and testing of the products/solutions with respect to the relevant specific application or use thereof.

The Schneider Electric brand and any trademarks of Schneider Electric SE and its subsidiaries referred to in this document are the property of Schneider Electric SE or its subsidiaries. All other brands may be trademarks of their respective owner.



This document and its content are protected under applicable copyright laws and provided for informative use only. No part of this document may be reproduced or transmitted in any form or by any means (electronic, mechanical, photocopying, recording, or otherwise), for any purpose, without the prior written permission of Schneider Electric.

Schneider Electric does not grant any right or license for commercial use of the document or its content, except for a non-exclusive and personal license to consult it on an "as is" basis.

Schneider Electric reserves the right to make changes or updates with respect to or in the content of this document or the format thereof, at any time without notice.

To the extent permitted by applicable law, no responsibility or liability is assumed by Schneider Electric and its subsidiaries for any errors or omissions in the informational content of this document, as well as any non-intended use or misuse of the content thereof.

Table of Contents

Safety information	5
Product overview	7
Package contents	8
Dimension drawing	8
Exploded-view drawing	9
Installing the product	10
Choosing the installation location	10
Wiring the product	10
Simple connection	11
Loop-through connection	11
Mounting the product	11
Operating the product.....	15
Operating the push button	16
Modes of operation	17
 Guide light mode	17
 Night light mode	17
 OFF mode	18
Detection range	19
Maintaining the product.....	20
Technical data	21
WEEE directive	22

Safety information

Important information

Read these instructions carefully and look at the equipment to become familiar with the device before trying to install, operate, service, or maintain it. The following special messages may appear throughout this manual or on the equipment to warn of potential hazards or to call attention to information that clarifies or simplifies a procedure.



The addition of either symbol to a “Danger” or “Warning” safety label indicates that an electrical hazard exists which will result in personal injury if the instructions are not followed.



This is the safety alert symbol. It is used to alert you to potential personal injury hazards. Obey all safety messages that accompany this symbol to avoid possible injury or death.

DANGER

DANGER indicates a hazardous situation which, if not avoided, **will result in** death or serious injury.

Failure to follow these instructions will result in death or serious injury.

WARNING

WARNING indicates a hazardous situation which, if not avoided, **could result in** death or serious injury.

CAUTION

CAUTION indicates a hazardous situation which, if not avoided, **could result in** minor or moderate injury.

NOTICE

NOTICE is used to address practices not related to physical injury.

For your safety

DANGER

HAZARD OF ELECTRIC SHOCK, EXPLOSION, OR ARC FLASH

Safe electrical installation must be carried out only by qualified electrical personnel. Qualified electrical personnel must prove profound knowledge in the following areas:

- Connecting to installation networks
- Connecting several electrical devices
- Laying electrical cables
- Safety standards, local wiring rules, and regulations

Failure to follow these instructions will result in death or serious injury.

Product overview

Exxact Double Socket Outlet Screwless Light (referred to as *product*) is equipped with:

- 2 socket outlets (16 A max shared on both)
- Passive Infrared (PIR) motion sensor
- LED lamp

On connecting the product to the mains, the two socket outlets, motion sensor, and the LED lamp are energized.

The product has three modes of operation:

- Guide light mode
- Night light mode
- OFF mode

The motion sensor switches on the LED lamp with a brightness of 15 lm if movement is detected and the ambient light is less than 20 lux; except when the product is in OFF mode.

NOTE: The motion sensor does not control the functioning of the socket outlets.

For more information, see [Modes of operation](#).

The  push-button enables you to switch between the modes. When there is a mode change, the corresponding mode indicator LED glows green for 20 s.

Applications

- In the Guide light mode:
 - Acts as a guiding light to illuminate dark corridors, staircases and so on.
- In the Night light mode:
 - Serves as a temporary dim light in bedrooms, for children to feel secure while falling asleep.

Package contents

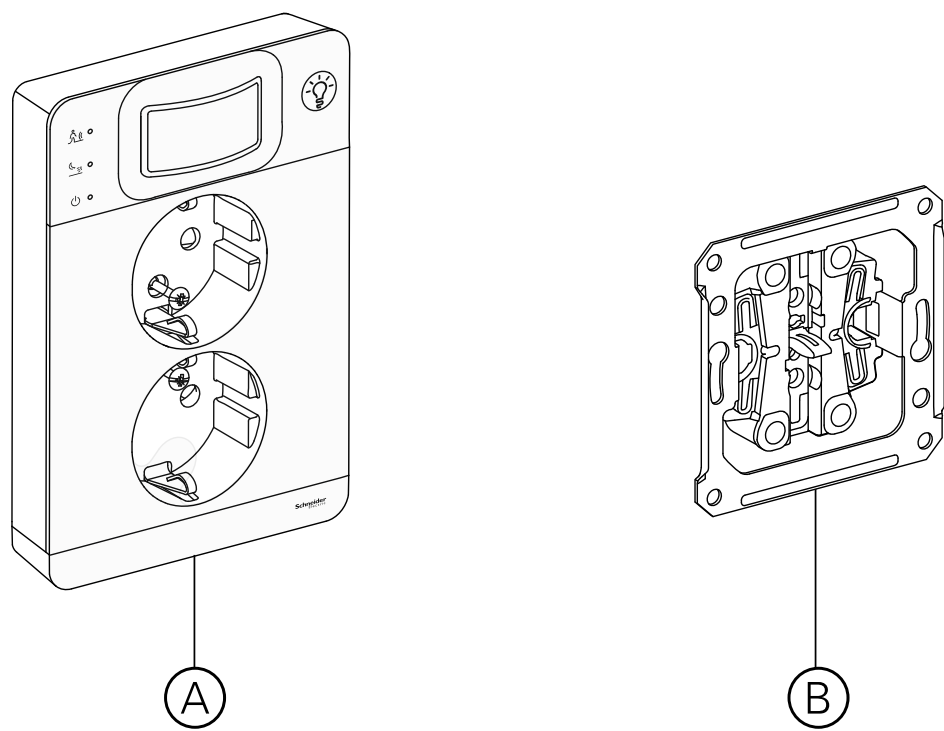

A	Exxact Double Socket Outlet Screwless Light
B	Wall-insert with screwless terminals

Dimension drawing

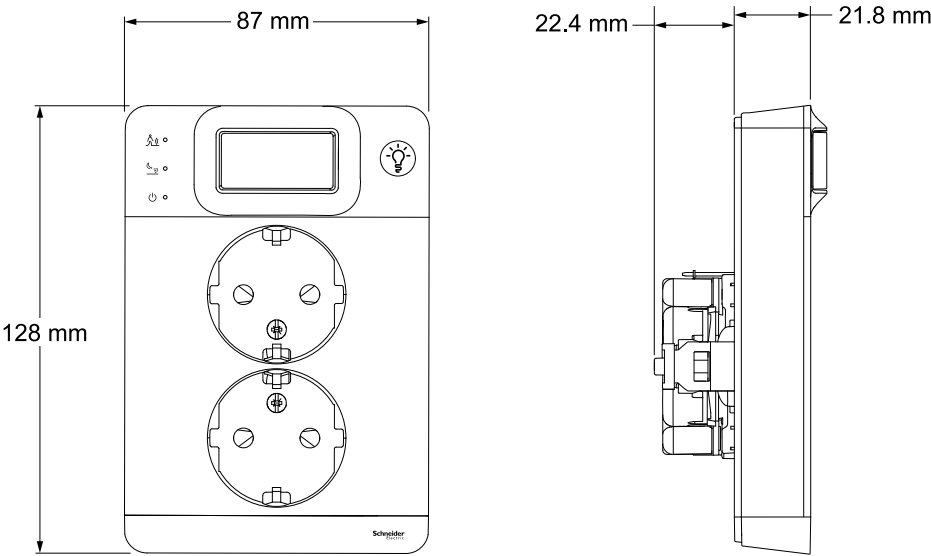

Exploded-view drawing

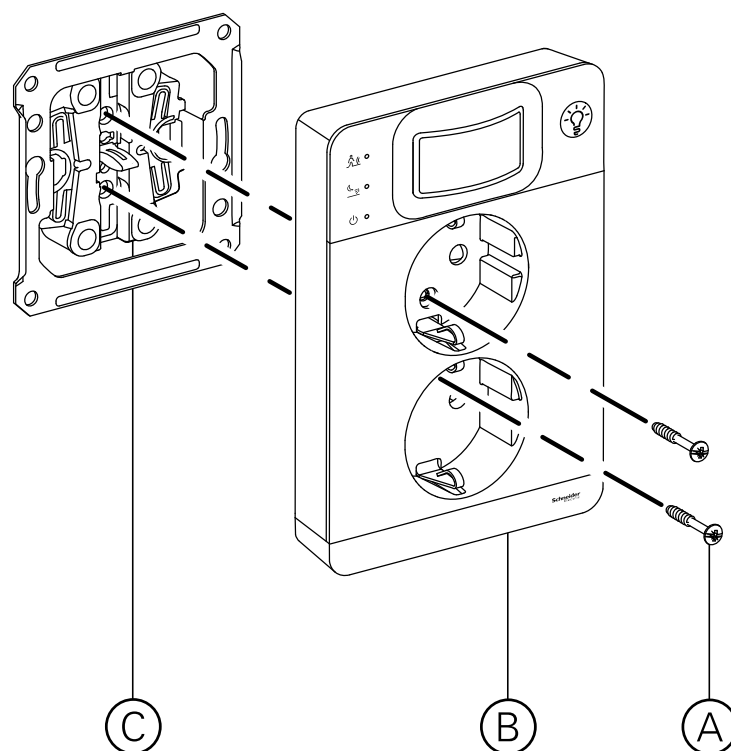

A	Screws
B	Exxact Double Socket Outlet Screwless Light
C	Wall-insert with screwless terminals

Installing the product

Choosing the installation location

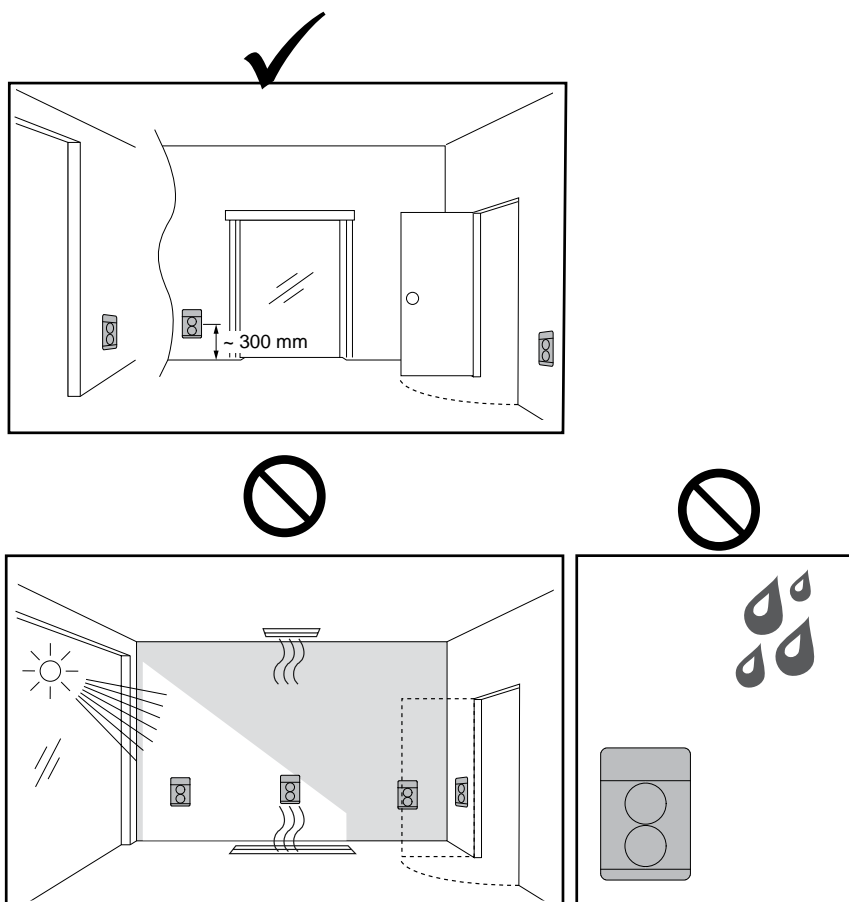

NOTICE

- We recommend a mounting height of minimum 300 mm from the floor.
- The product is designed for indoor installation (IP20).
- Make sure that the product is installed at locations with no exposure to water, direct light, and devices that radiate heat.

Failure to follow these instructions can result in equipment damage.

Wiring the product

Clamping connection capacity

	1 x 1.5...2 x 2.5 mm ² solid cable(s)
	1 x 1.5...2 x 2.5 mm ² flexible stranded cable(s)
	Wire stripping length

Simple connection

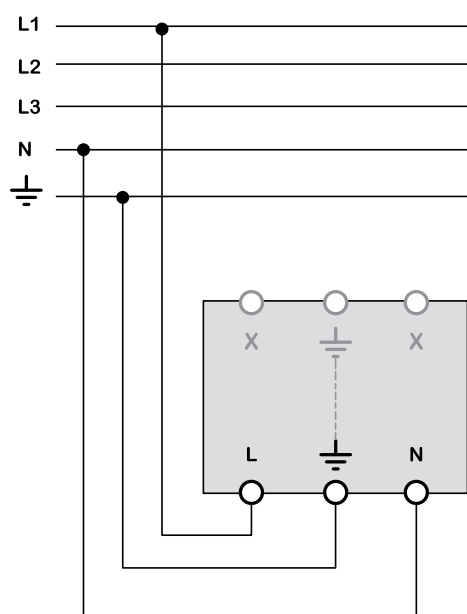

The wall-insert has three screwless terminals at the bottom – Live (L), Neutral (N) and Earth (⊥) with a 2-wire entry for each terminal.

Loop-through connection

The wall-insert has two screwless loop terminals (X) and an Earth (⊥) terminal at the top that can be used to extend cables. These terminals are isolated from the rest of the socket and serve as a replacement for loose terminal blocks.

Mounting the product

Wall box adjustment: If applicable, adjust the threaded-screw ring in the wall box such that the outer edge of the threaded-screw ring aligns with the surface of the wall.

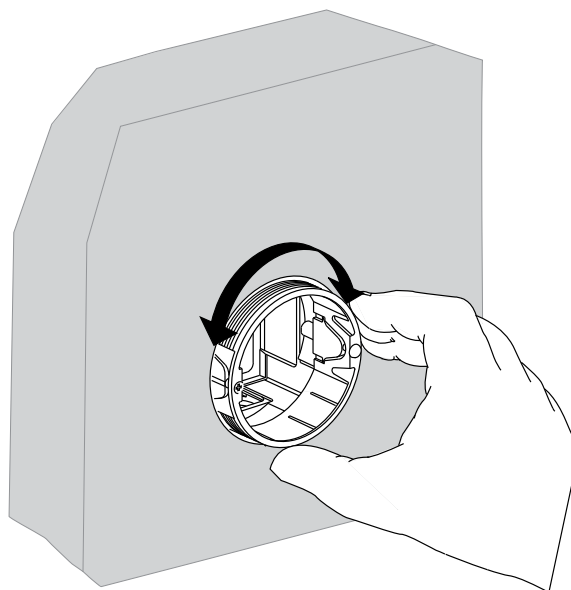

NOTE: This step is important to avoid possible deformation of the wall-insert frame while mounting it into the wall box.

1. Mount the wall-insert into the wall box, with a maximum tightening torque of 0.33 Nm for the screws.

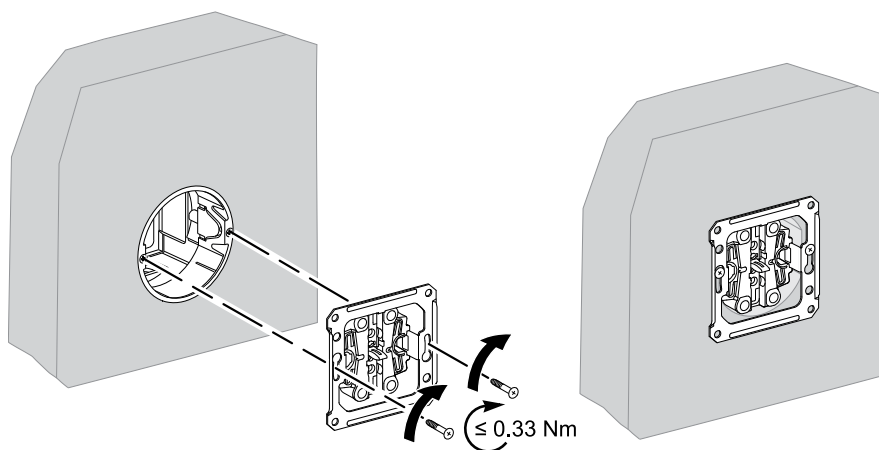

NOTE: Optional fixing mode by claw kit. (WDE002395)

2. Remove the protection cap that covers the contact pins on the rear side of the product, before mounting it into the wall-insert.

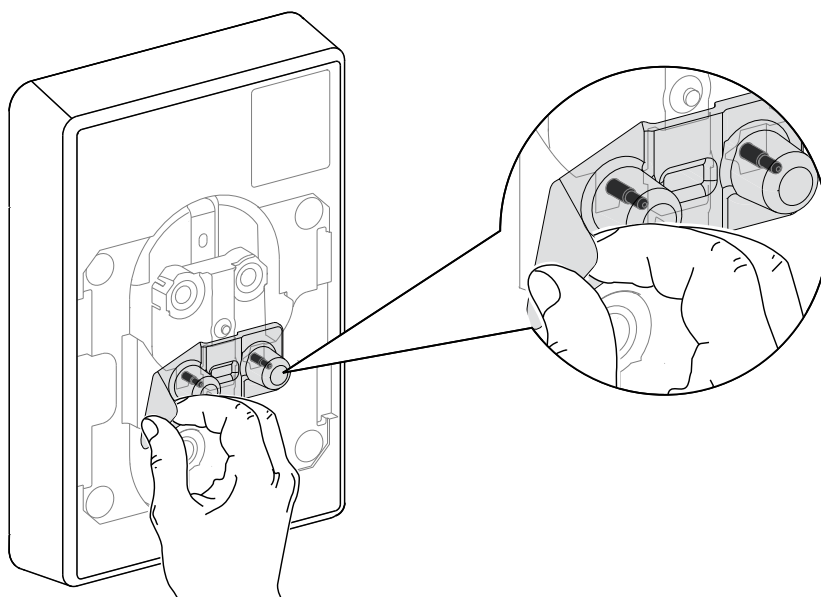

NOTE: Any damage to the contact pins; for example, bending, breaking, or deformation, will interfere with the functioning of the product.

NOTICE

DAMAGE TO THE CONTACT PINS

- Handle the product carefully to avoid any damage to the contact pins.
- Make sure that the contact pins do not get damaged while mounting the product into the wall-insert.

Failure to follow these instructions can result in equipment damage.

3. Mount the product into the wall-insert using screws.

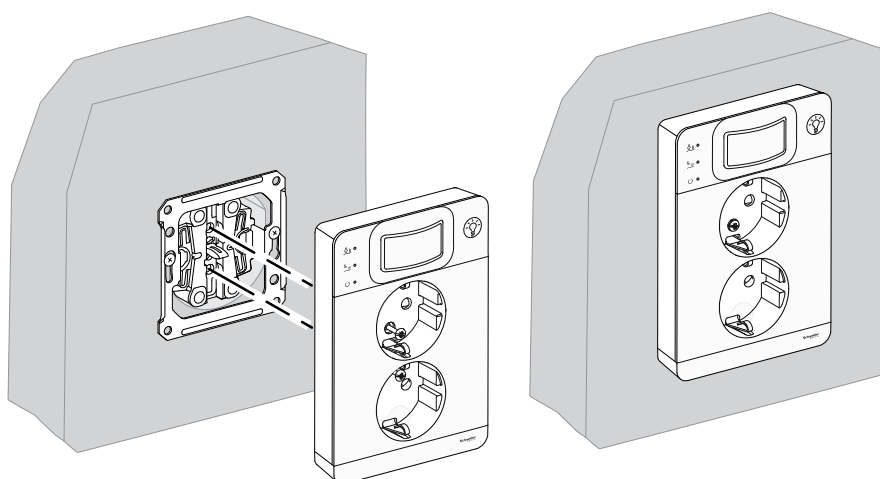

4. Remove the protective film covering the surface of the product.

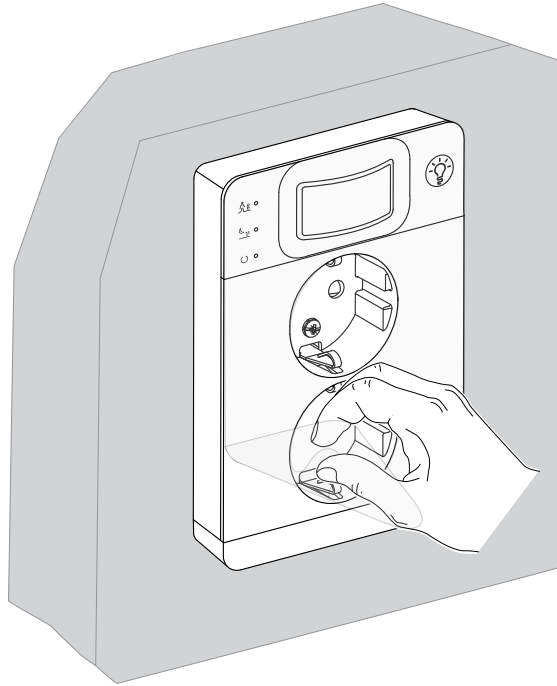

Operating the product

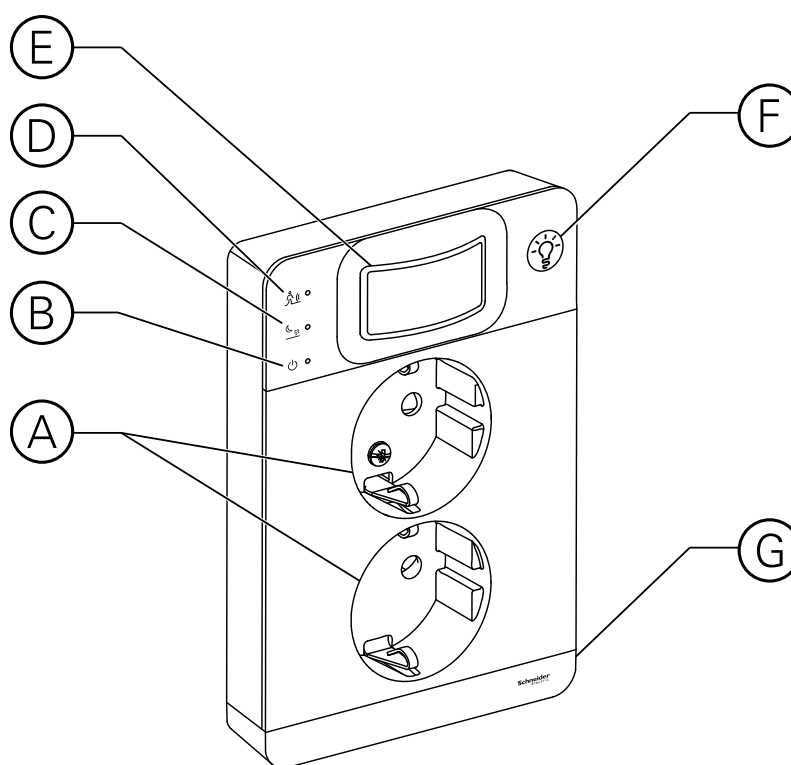

A	Socket outlets
B	OFF mode indicator LED
C	Night light indicator LED
D	Guide light indicator LED
E	PIR motion sensor
F	Push-button
G	LED lamp

Powering-on the product

When the product is powered-on for the first time:

- 3 mode indicator LEDs glow green for 1 min. and
- the LED lamp is illuminated at 15 lm for 1 min.

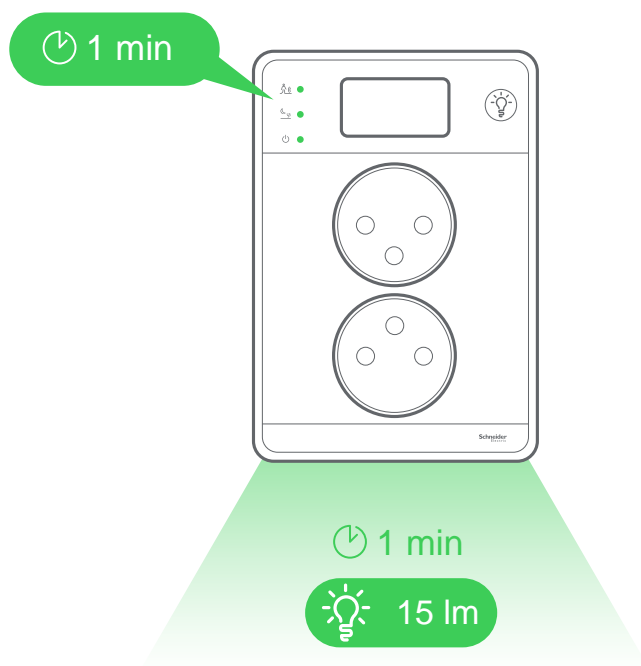

Operating the push button

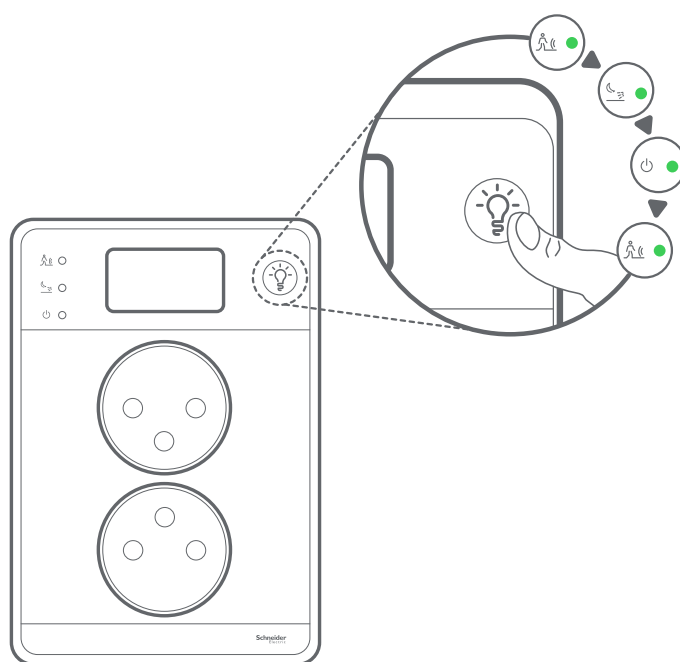



The push-button enables you to switch between Guide light, Night light and OFF modes.

Press the push-button once to change the existing mode.

NOTE: The default mode (Guide light mode) is restored each time the product is powered on.

Modes of operation

The product operates in three modes:

	Guide light mode
	Night light mode
	OFF mode

Guide light mode

In this mode, the LED lamp automatically illuminates dark spaces on detecting movement. It is especially useful for lighting your way during the night, without causing disturbance.

Selection: Default mode. You can manually select this mode by pressing the push-button. See [Operating the push button](#).

Indication: Guide light indicator LED  glows green for 20 s.

Behavior of the LED lamp: During this mode, the LED lamp is in off condition. When the motion sensor detects movement, and if the ambient light is less than 20 lux, the LED lamp is switched on and glows at 15 lm for 30 s.

NOTE: If the ambient light is more than 20 lux, the motion sensor does not turn on the LED lamp.

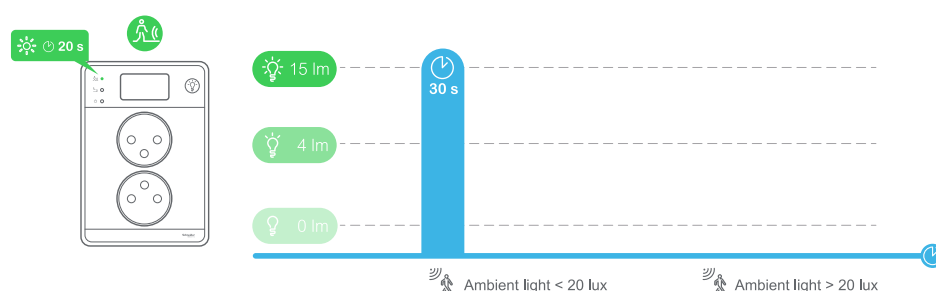

Night light mode

This mode is useful if you want a dim light; especially in the children's room before they fall asleep.

Selection: You can manually select this mode by pressing the push-button (see [Operating the push button](#))

Indication: Night light indicator LED  glows green for 20 s.

Duration: 1 hour.

NOTE: After 1 hour, Guide light mode (default mode) is restored.

Behavior of the LED lamp: During this mode, the LED lamp is switched on with a brightness of 4 lm. If the motion sensor detects movement, and if the ambient light is less than 20 lux, the brightness of the LED lamp is increased to 15 lm for 30 s and then restored to 4 lm.

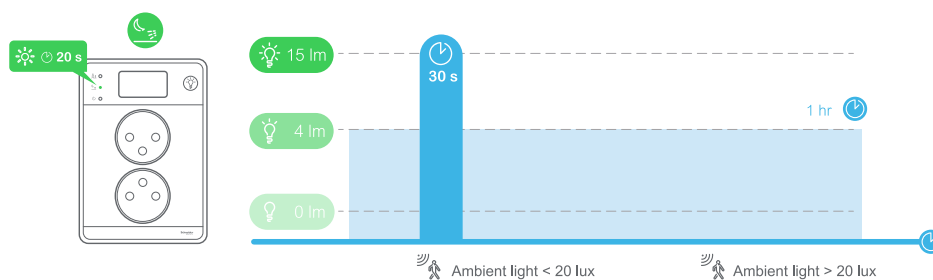

OFF mode

This mode enables you to completely switch off the LED lamp; particularly at night.

Selection: You can select this mode by pressing the push-button (see Operating the push button.)

Indication: OFF mode indicator LED  glows green for 20 s.

Behavior of the LED lamp: The LED lamp remains switched off irrespective of whether movement is detected or not.

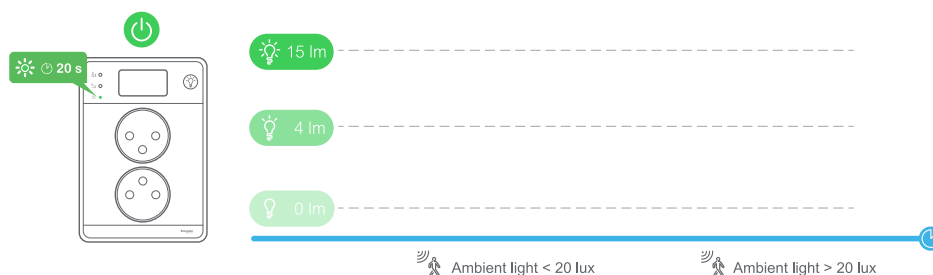

Detection range

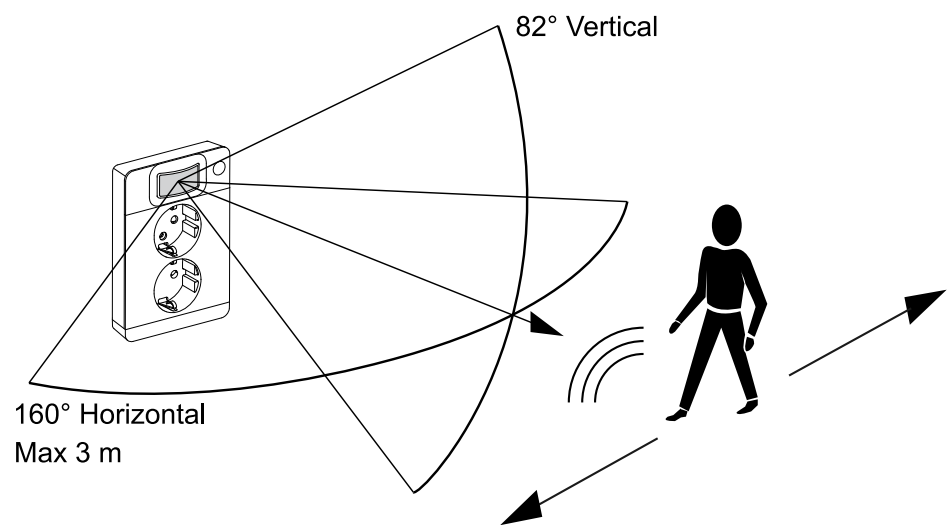

Maintaining the product

It is recommended to clean the surface of the product as required with a soft, clean and dry cloth.

<i>NOTICE</i>
DAMAGE TO THE PLASTIC PARTS Do not use acetone or trichloroethylene to clean the product. Corrosive cleaning agents may damage the plastic parts. Failure to follow these instructions can result in equipment damage.

Technical data

Socket Outlet	
Socket number	2
Output poles configuration	2P + E with shutters
DSO operating voltage	250 V AC – 50/60 Hz
DSO rated current	16 A
PIR motion sensor	
Ambient light range	< 20 lux
Motion detection range	<ul style="list-style-type: none"> • 160° horizontal / 82° vertical • Maximum 3 m x 2 m (front vs side)
LED lamp	
Service life¹	10 000 hr
Power consumption	<ul style="list-style-type: none"> • Night light mode: 50 mW • Guide light mode: 150 mW
IP rating	IP20
IK rating	IK04
Operating temperature	-5 to 40 °C
Stand-by power consumption	0.5 W
Standards	<ul style="list-style-type: none"> • IEC 60884-1 • IEC 60598-1 and IEC 60598-2-1 • IEC 61347-1 and IEC 61347-2-13 • SS 428 08 34 • SFS 5610
Certifications	<ul style="list-style-type: none"> • FIMKO • SEMKO • CE
EU Directives	<ul style="list-style-type: none"> • 2004/108/EC - Electromagnetic Compatibility • 2006/95/EC - Low voltage directive • 2009/125/EC - Eco-Design RoHS REACH

1. The light source of this luminaire is not replaceable; when the light source reaches its end of life the whole luminaire shall be replaced.

WEEE directive



Dispose of the device separately from household waste at an official collection point.

Professional recycling protects people and the environment against potential negative effects.

Schneider Electric
35 rue Joseph Monier
92500 Rueil Malmaison
France

Customer Care Numbers:
Sweden: 0771-360370 (+46 771360370), Finland: 010 446 615 (+358
10 446 615)

www.schneider-electric.com

As standards, specifications, and design change from time to time,
please ask for confirmation of the information given in this publication.

© 2019 – 2019 Schneider Electric. All rights reserved.

MFR3940104