

Exxact Double Socket Outlet Screwless USB, 15 W

User Manual

WDE002195, WDE003395, WDE004395
05/2021



Legal Information

The Schneider Electric brand and any trademarks of Schneider Electric SE and its subsidiaries referred to in this guide are the property of Schneider Electric SE or its subsidiaries. All other brands may be trademarks of their respective owners.

This guide and its content are protected under applicable copyright laws and furnished for informational use only. No part of this guide may be reproduced or transmitted in any form or by any means (electronic, mechanical, photocopying, recording, or otherwise), for any purpose, without the prior written permission of Schneider Electric.

Schneider Electric does not grant any right or license for commercial use of the guide or its content, except for a non-exclusive and personal license to consult it on an "as is" basis. Schneider Electric products and equipment should be installed, operated, serviced, and maintained only by qualified personnel.

As standards, specifications, and designs change from time to time, information contained in this guide may be subject to change without notice.

To the extent permitted by applicable law, no responsibility or liability is assumed by Schneider Electric and its subsidiaries for any errors or omissions in the informational content of this material or consequences arising out of or resulting from the use of the information contained herein.

Table of Contents

Safety information	5
Product overview	7
Package contents	7
Dimension drawing	8
Exploded drawing	8
Installing the product	9
Choosing the installation location	9
Wiring the product	9
Simple connection	10
Loop-through connection	10
Mounting the product	10
Operating the product.....	14
Maintaining the product.....	15
Technical data	16
WEEE directive	17

Safety information

Important information

Read these instructions carefully and look at the equipment to become familiar with the device before trying to install, operate, service, or maintain it. The following special messages may appear throughout this manual or on the equipment to warn of potential hazards or to call attention to information that clarifies or simplifies a procedure.



The addition of either symbol to a “Danger” or “Warning” safety label indicates that an electrical hazard exists which will result in personal injury if the instructions are not followed.



This is the safety alert symbol. It is used to alert you to potential personal injury hazards. Obey all safety messages that accompany this symbol to avoid possible injury or death.

DANGER

DANGER indicates a hazardous situation which, if not avoided, **will result in** death or serious injury.

Failure to follow these instructions will result in death or serious injury.

WARNING

WARNING indicates a hazardous situation which, if not avoided, **could result in** death or serious injury.

CAUTION

CAUTION indicates a hazardous situation which, if not avoided, **could result in** minor or moderate injury.

NOTICE

NOTICE is used to address practices not related to physical injury.

For your safety

DANGER

HAZARD OF ELECTRIC SHOCK, EXPLOSION, OR ARC FLASH

Safe electrical installation must be carried out only by qualified electrical personnel. Qualified electrical personnel must prove profound knowledge in the following areas:

- Connecting to installation networks
- Connecting several electrical devices
- Laying electrical cables
- Safety standards, local wiring rules, and regulations

Failure to follow these instructions will result in death or serious injury.

Product overview

The Double Socket Outlet with 15 W USB charging ports and screwless terminals (referred to as *product*) consists of:

- Two socket outlets (maximum 16 A shared on both)
- Two USB charging ports (Type A and Type C, maximum 15 W shared on both)

On connecting the product to the mains, the socket outlets and the USB ports are energized.

The USB ports charge devices such as mobile phones, tablets, MP3 players and laptops. Up to two devices can be charged simultaneously. The USB LEDs indicate the charging status of the connected device(s).

Package contents

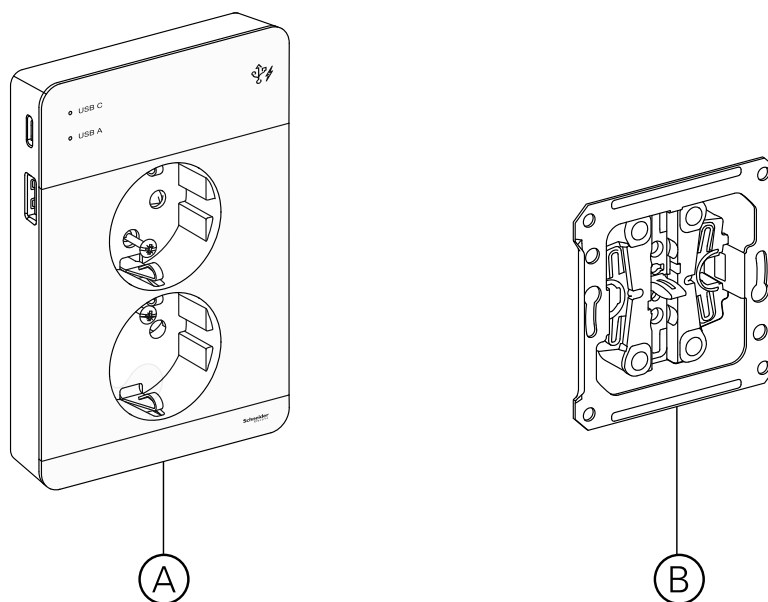

A	Double Socket Outlet Screwless USB (Type A and Type C, 15 W)
B	Wall-insert with screwless terminals

Dimension drawing

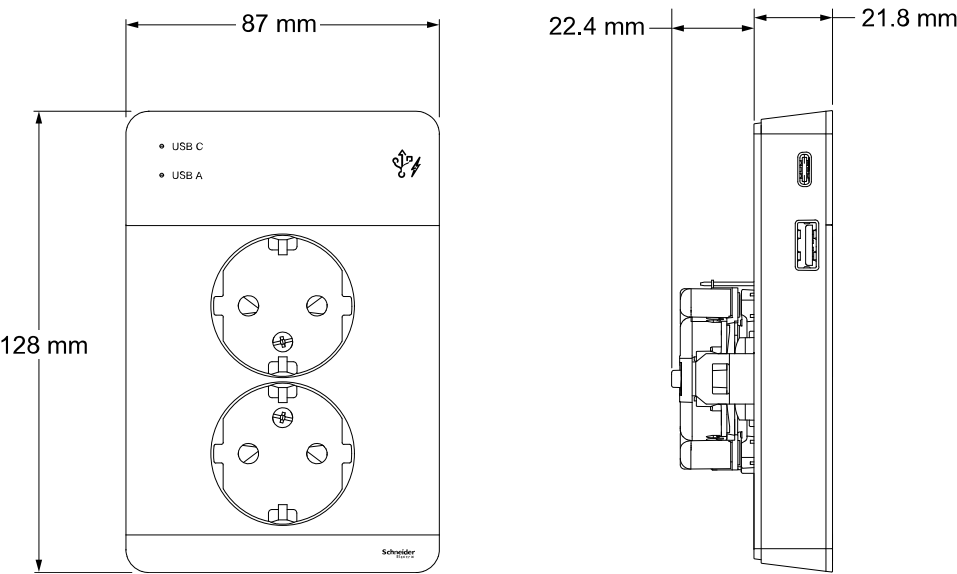

Exploded drawing

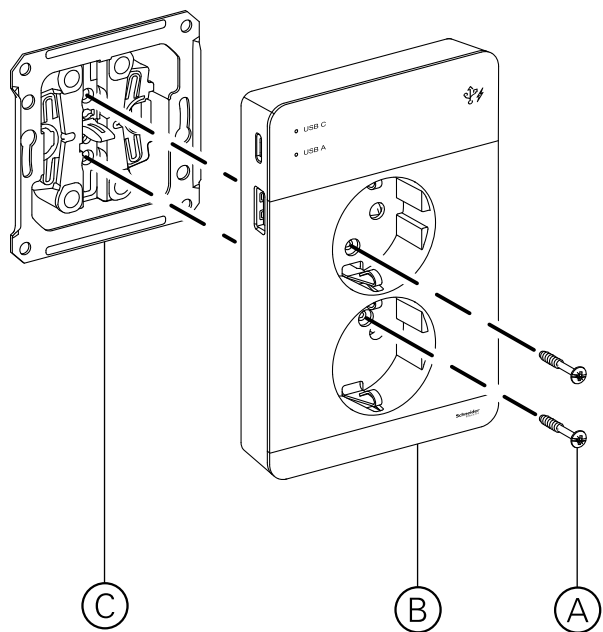

A	Screws
B	Double Socket Outlet (DSO) with USB
C	Wall-insert with screwless terminals

Installing the product

Choosing the installation location

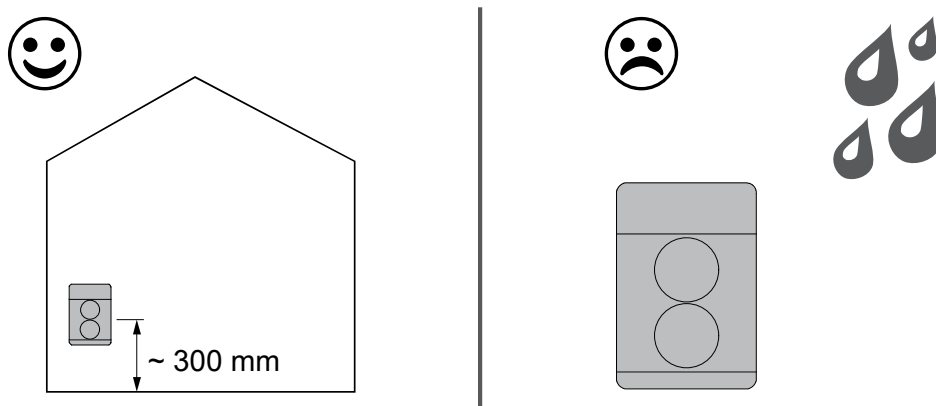



NOTICE

- We recommend a mounting height of minimum 300 mm from the floor.
- The product is designed for indoor installation (IP20).

Failure to follow these instructions can result in equipment damage.

Wiring the product

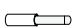
Clamping connection capacity

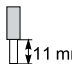
	1 x 1.5...2 x 2.5 mm ² solid cable(s)
	1 x 1.5...2 x 2.5 mm ² flexible stranded cable(s)
	Wire stripping length

Simple connection

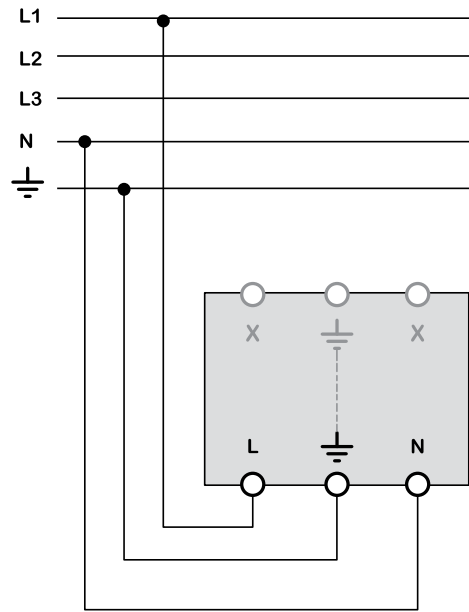

The wall-insert has three screwless terminals at the bottom – Live (L), Neutral (N) and Earth (\perp) with a 2-wire entry for each terminal.

Loop-through connection

The wall-insert has two screwless loop terminals (X) and an Earth (\perp) terminal at the top that can be used to extend cables. These terminals are isolated from the rest of the socket and serve as a replacement for loose terminal blocks.

Mounting the product

Wall box adjustment: If applicable, adjust the threaded-screw ring in the wall box such that the outer edge of the threaded-screw ring aligns with the surface of the wall.

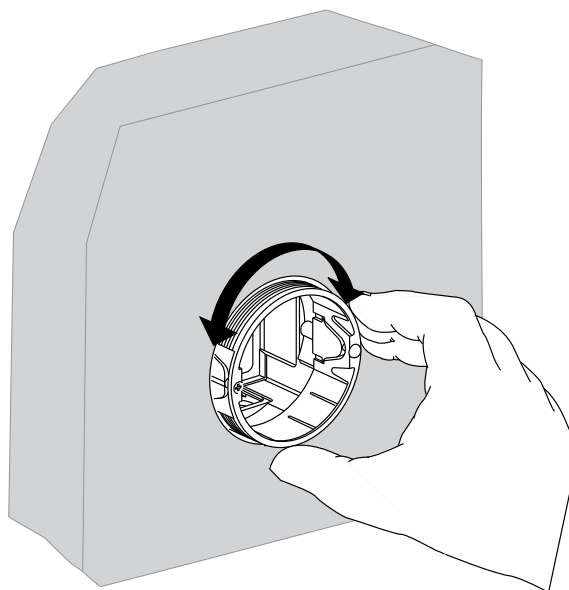

NOTE: This step is important to avoid possible deformation of the wall-insert frame while mounting into the wall box.

1. Mount the wall-insert into the wall box, with a maximum tightening torque of 0.33 Nm for the screws.

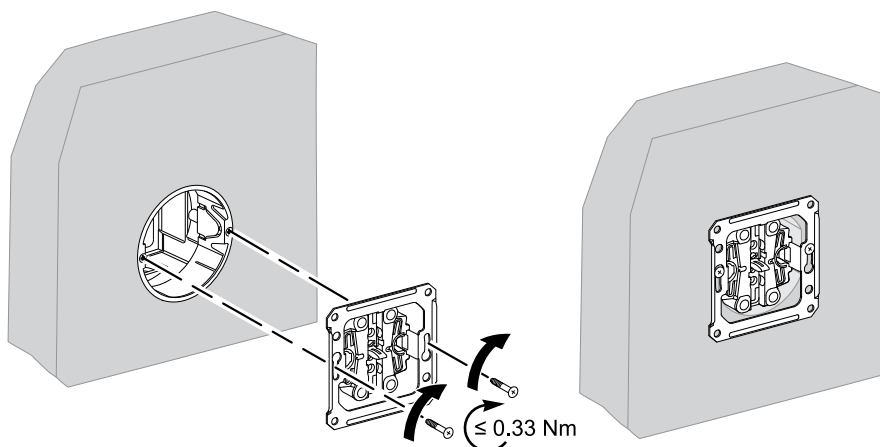

NOTE: Optional fixing mode by claw kit. (WDE002395)

2. Remove the protection cap that covers the contact pins on the rear side of the product, before mounting it into the wall-insert.

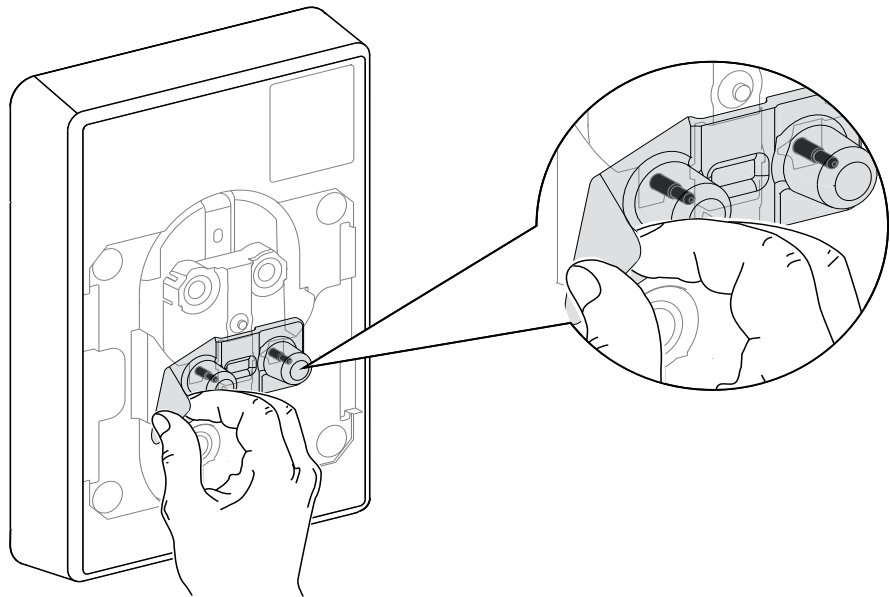

NOTE: Any damage to the contact pins; for example, bending, breaking, or deformation, will interfere with the functioning of the product.

NOTICE

DAMAGE TO THE CONTACT PINS

- Handle the product carefully to avoid any damage to the contact pins.
- Make sure that the contact pins do not get damaged while mounting the product into the wall-insert.

Failure to follow these instructions can result in equipment damage.

3. Mount the product into the wall-insert using screws.

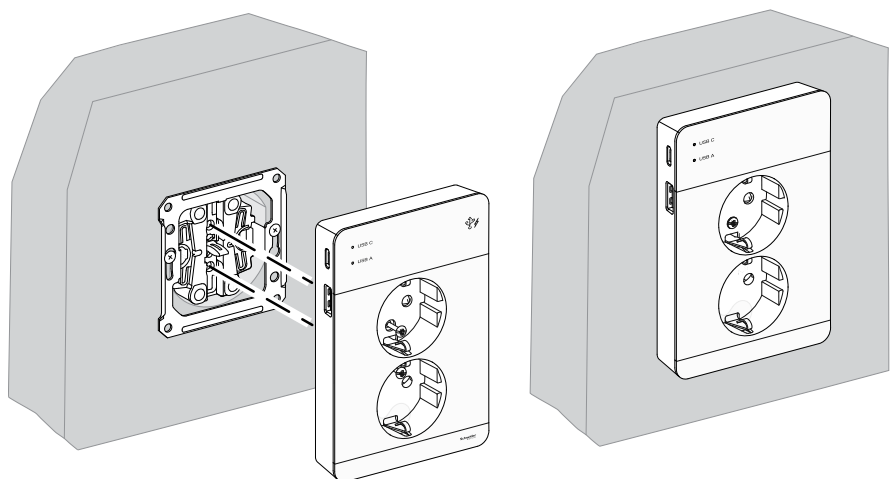

4. Remove the protective film covering the surface of the product.

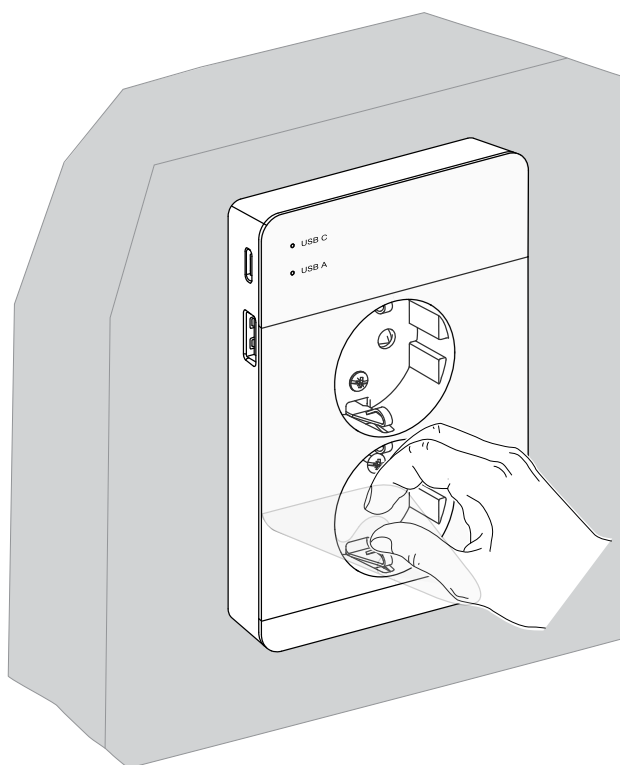

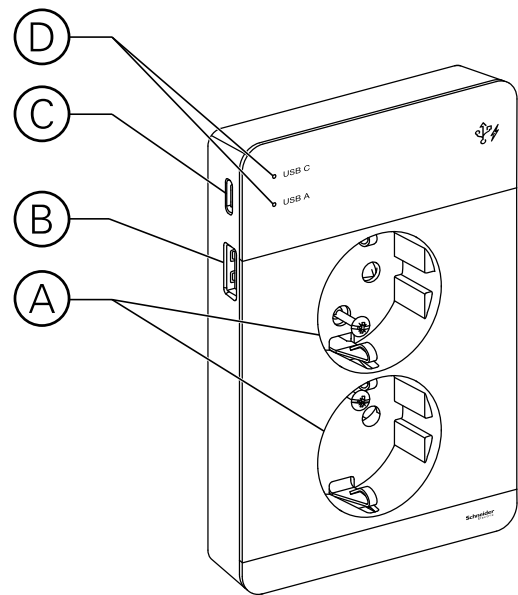

Operating the product



A	Socket outlets
B	USB Type A
C	USB Type C
D	USB LED indicators

When a device is connected to the USB port(s) for charging, the USB LED indicators indicate the charging status.

LED indication	Status
	When the device is charging, the LED glows in orange color.
	When the device is 100% charged, the LED is off. NOTE: Sometimes the LED flickers when the device is 100% charged because the device is consuming some current.

Maintaining the product

It is recommended to clean the surface of the product as required with a soft, clean and dry cloth.

<i>NOTICE</i>
DAMAGE TO THE PLASTIC PARTS Do not use acetone or trichloroethylene to clean the product. Corrosive cleaning agents may damage the plastic parts. Failure to follow these instructions can result in equipment damage.

Technical data

Double Socket Outlet	
Socket number	2
Output poles configuration	2P + E with shutters
DSO operating voltage	250 V AC – 50/60 Hz
DSO rated current	16 A
USB (Type A and Type C)	
USB input voltage	250 V AC – 50/60 Hz
USB output voltage	5.0 V DC +7% / -5%
USB rated input current	0.5 A
Maximum load current and power (Type A)	2.4 A (12.0 W)
Maximum load current and power (Type C)	3.0 A (15.0 W)
Maximum load sharing between Type A and Type C	3.0 A (15.0 W)
No load power consumption	< 0.3 W
Full load efficiency	> 82%
Average active efficiency*	> 80%
Efficiency at low load (10%)**	> 75%
Type A compatibility	Apple, Samsung, BC 1.2.
Type C compatibility	Type-C specification, BC 1.2 and its previous versions.
* Average active efficiencies at 25%, 50%, 75% and 100% for the maximum output power (15.0 W).	
** Efficiency at 10% of the maximum output power (15.0 W).	
Service life	30 000 hr
IP rating	IP20
IK rating	IK04
Operating temperature	0 to 40 °C
Standards	<ul style="list-style-type: none"> • IEC 60884-1 • IEC62368-1 • SS 428 08 34 • SFS 5610 • IEC/EN61558-2-16 for transformer only
Certifications	<ul style="list-style-type: none"> • FIMKO • SEMKO • CE
EU Directives	<ul style="list-style-type: none"> • 2004/108/EC - Electromagnetic Compatibility • 2006/95/EC - Low voltage directive • 2009/125/EC - Eco-Design RoHS REACH

WEEE directive



Dispose of the device separately from household waste at an official collection point.

Professional recycling protects people and the environment against potential negative effects.

Schneider Electric
35 rue Joseph Monier
92500 Rueil Malmaison
France

Customer Care Numbers:
Sweden: 0771-360370 (+46 771360370), Finland: 010 446 615 (+358
10 446 615)

www.se.com

As standards, specifications, and design change from time to time,
please ask for confirmation of the information given in this publication.

© 2021 – Schneider Electric. All rights reserved.

MFR2580802