

Galaxy VXL

Backfeed Protection Cabinet

Receiving and Unpacking

GVXLOPT001

Latest updates are available on the Schneider Electric website
10/2025

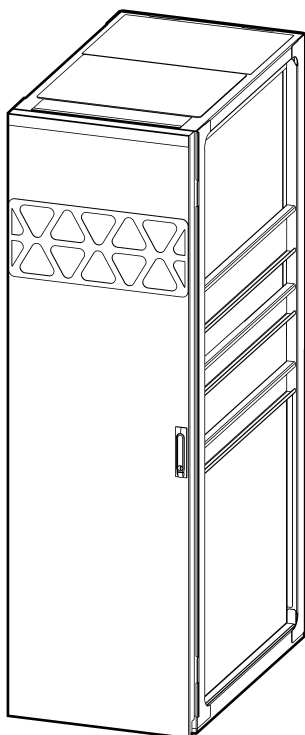

Legal Information

The information provided in this document contains general descriptions, technical characteristics and/or recommendations related to products/solutions.

This document is not intended as a substitute for a detailed study or operational and site-specific development or schematic plan. It is not to be used for determining suitability or reliability of the products/solutions for specific user applications. It is the duty of any such user to perform or have any professional expert of its choice (integrator, specifier or the like) perform the appropriate and comprehensive risk analysis, evaluation and testing of the products/solutions with respect to the relevant specific application or use thereof.

The Schneider Electric brand and any trademarks of Schneider Electric SE and its subsidiaries referred to in this document are the property of Schneider Electric SE or its subsidiaries. All other brands may be trademarks of their respective owner.

This document and its content are protected under applicable copyright laws and provided for informative use only. No part of this document may be reproduced or transmitted in any form or by any means (electronic, mechanical, photocopying, recording, or otherwise), for any purpose, without the prior written permission of Schneider Electric.

Schneider Electric does not grant any right or license for commercial use of the document or its content, except for a non-exclusive and personal license to consult it on an "as is" basis.

Schneider Electric reserves the right to make changes or updates with respect to or in the content of this document or the format thereof, at any time without notice.

To the extent permitted by applicable law, no responsibility or liability is assumed by Schneider Electric and its subsidiaries for any errors or omissions in the informational content of this document, as well as any non-intended use or misuse of the content thereof.

Table of Contents

Important Safety Instructions — SAVE THESE
INSTRUCTIONS5
 Storage Conditions7
 Backfeed Protection Cabinet Shipping Weights and Dimensions7
 Receiving.....8
Remove the Backfeed Protection Cabinet from the Pallet9

Important Safety Instructions — SAVE THESE INSTRUCTIONS

Read these instructions carefully and look at the equipment to become familiar with it before trying to install, operate, service or maintain it. The following safety messages may appear throughout this manual or on the equipment to warn of potential hazards or to call attention to information that clarifies or simplifies a procedure.



The addition of this symbol to a “Danger” or “Warning” safety message indicates that an electrical hazard exists which will result in personal injury if the instructions are not followed.



This is the safety alert symbol. It is used to alert you to potential personal injury hazards. Obey all safety messages with this symbol to avoid possible injury or death.

DANGER

DANGER indicates a hazardous situation which, if not avoided, **will result in death or serious injury.**

Failure to follow these instructions will result in death or serious injury.

WARNING

WARNING indicates a hazardous situation which, if not avoided, **could result in death or serious injury.**

Failure to follow these instructions can result in death, serious injury, or equipment damage.

CAUTION

CAUTION indicates a hazardous situation which, if not avoided, **could result in minor or moderate injury.**

Failure to follow these instructions can result in injury or equipment damage.

NOTICE

NOTICE is used to address practices not related to physical injury. The safety alert symbol shall not be used with this type of safety message.

Failure to follow these instructions can result in equipment damage.

Please Note



Electrical equipment should only be installed, operated, serviced, and maintained by qualified personnel. No responsibility is assumed by Schneider Electric for any consequences arising out of the use of this material.

A qualified person is one who has skills and knowledge related to the construction, installation, and operation of electrical equipment and has received safety training to recognize and avoid the hazards involved.

Per IEC 62040-1: "Uninterruptible power systems (UPS) -- Part 1: Safety Requirements," this equipment, including battery access, must be inspected, installed and maintained by a skilled person.

The skilled person is a person with relevant education and experience to enable him or her to perceive risks and to avoid hazards which the equipment can create (reference IEC 62040-1, section 3.102).

Storage Conditions

		
Storage temperature: -25 °C to 55 °C for systems without batteries.	Relative humidity: 0-95% non-condensing	Elevation: 0-15000 m

Backfeed Protection Cabinet Shipping Weights and Dimensions

Commercial reference	Weight kg	Height mm	Width mm	Depth mm
GVXLOPT001	341	2150	1000	1200

Receiving

External Inspection

When the shipment arrives, inspect the shipping materials for any signs of damage or mishandling. Check tilt and/or impact indicators. Do not attempt to install the system if any damage is apparent. If any damage is noted, contact Schneider Electric customer support and file a damage claim with the shipping agency within 24 hours of receipt.

Compare the components of the shipment with the bill of lading. Report any missing items to the carrier and to Schneider Electric customer support immediately.

Verify that labelled units match the order confirmation.

Remove the Backfeed Protection Cabinet from the Pallet

1. Move the backfeed protection cabinet as close as possible to the final location with a pallet truck or a forklift before unpacking.
2. Remove the packaging.
3. Remove the ramp.

Rear View of the Backfeed Protection Cabinet

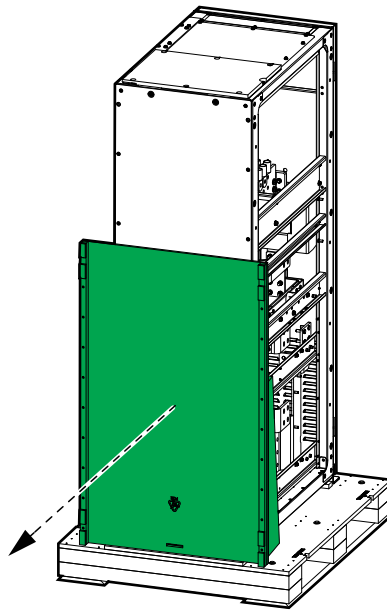

4. Open the front door.

- Remove the front transportation bracket. Reinstall the six M8x30 screws on the cabinet.

NOTE: Save the front transportation bracket as it is reused for seismic anchoring. Refer to the backfeed protection cabinet installation manual for details.

Front View of the Backfeed Protection Cabinet

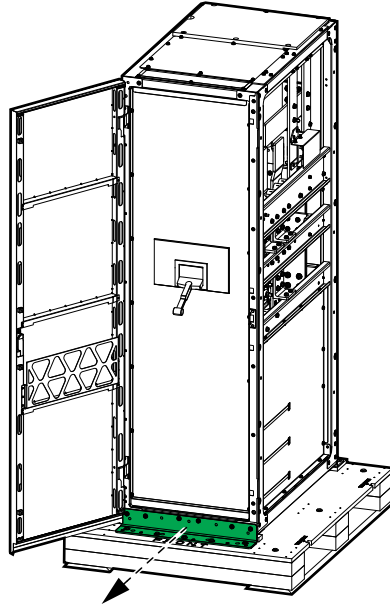

Front View of the Backfeed Protection Cabinet

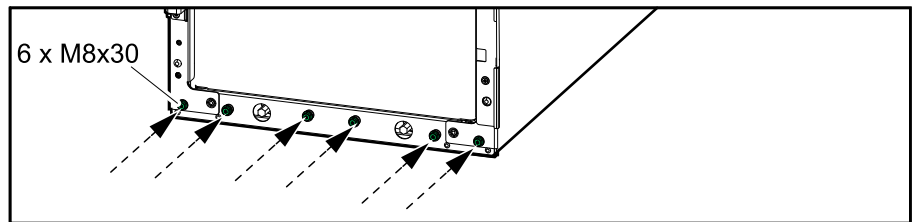

- Close and lock the front door.
- Remove the rear transportation bracket and the wood plate from the pallet. Attach the ramp to the rear of the pallet.

NOTE: Save the rear transportation bracket as it is reused for seismic anchoring. Refer to the backfeed protection cabinet installation manual for details.

Rear View of the Backfeed Protection Cabinet

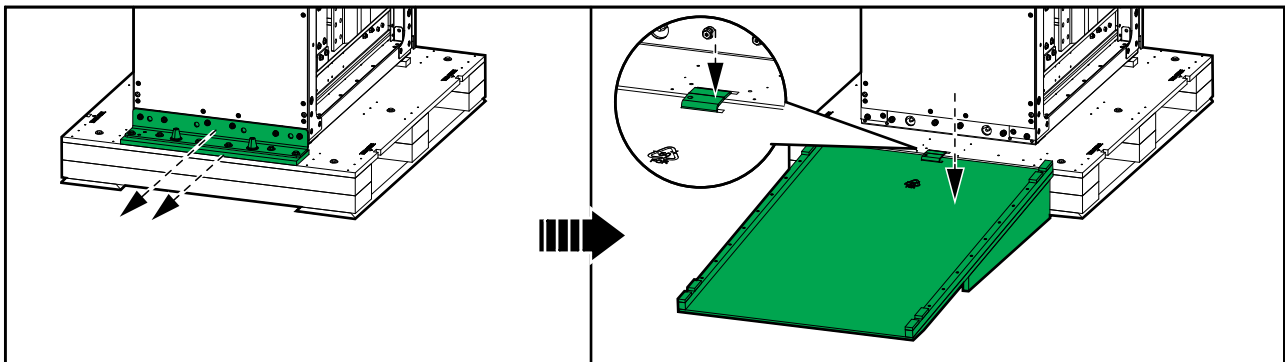

- Roll the backfeed protection cabinet carefully down the ramp.

⚠ CAUTION

HAZARD OF PERSONAL INJURY

- Make a clear path in front of the ramp.
- Do not stand in front of the ramp while rolling the backfeed protection cabinet down the ramp.

Failure to follow these instructions can result in injury or equipment damage.

Rear View of the Backfeed Protection Cabinet

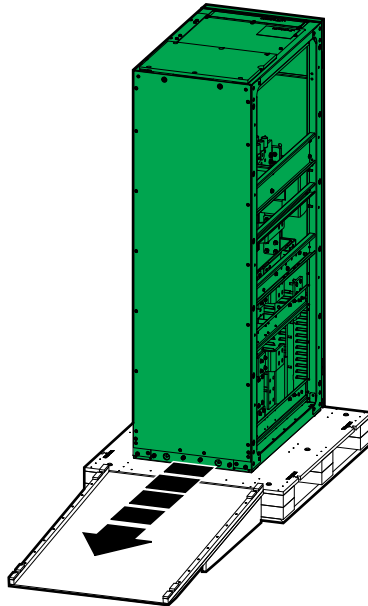

- Roll the backfeed protection cabinet to the final location.

⚠ WARNING

TIPPING HAZARD

- Only roll the backfeed protection cabinet over even floors.
- Move at a slow pace and pay close attention on the floor conditions and the balance of the backfeed protection cabinet.

Failure to follow these instructions can result in death, serious injury, or equipment damage.

- Cover the backfeed protection cabinet with the packaging bags until time of installation. Store manuals and documentation in the documentation compartment in the backfeed protection cabinet door.

Schneider Electric
35 rue Joseph Monier
92500 Rueil Malmaison
France

www.se.com



As standards, specifications, and design change from time to time, please ask for confirmation of the information given in this publication.

© 2025 – 2025 Schneider Electric. All rights reserved.

990-55771-001