

Link150 Ethernet Gateway

Firmware Release Notes

EcoStruxure offers simple, cost-effective serial-to-Ethernet connectivity.

05/2025

DOCA0182EN-07

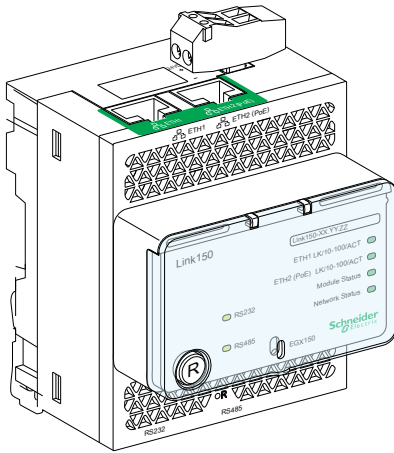

Legal Information

The information provided in this document contains general descriptions, technical characteristics and/or recommendations related to products/solutions.

This document is not intended as a substitute for a detailed study or operational and site-specific development or schematic plan. It is not to be used for determining suitability or reliability of the products/solutions for specific user applications. It is the duty of any such user to perform or have any professional expert of its choice (integrator, specifier or the like) perform the appropriate and comprehensive risk analysis, evaluation and testing of the products/solutions with respect to the relevant specific application or use thereof.

The Schneider Electric brand and any trademarks of Schneider Electric SE and its subsidiaries referred to in this document are the property of Schneider Electric SE or its subsidiaries. All other brands may be trademarks of their respective owner.

This document and its content are protected under applicable copyright laws and provided for informative use only. No part of this document may be reproduced or transmitted in any form or by any means (electronic, mechanical, photocopying, recording, or otherwise), for any purpose, without the prior written permission of Schneider Electric.

Schneider Electric does not grant any right or license for commercial use of the document or its content, except for a non-exclusive and personal license to consult it on an "as is" basis.

Schneider Electric reserves the right to make changes or updates with respect to or in the content of this document or the format thereof, at any time without notice.

To the extent permitted by applicable law, no responsibility or liability is assumed by Schneider Electric and its subsidiaries for any errors or omissions in the informational content of this document, as well as any non-intended use or misuse of the content thereof.

Table of Contents

Introduction	5
EcoStruxure Master Range	5
Link150 Ethernet Gateway	5
Firmware Release History	5
Firmware Update Policy	5
Firmware Upgrade via Firmware Upgrade Tool	7
Firmware Versions	8
Firmware Version 005.003.007	8
Firmware Version 005.003.003	8
Firmware Version 005.002.005	8
Firmware Version 005.001.024	8
Firmware Version 005.001.022	9
Firmware Version 005.001.019	9
Firmware Version 005.001.018	9
Firmware Version 005.001.015	9
Firmware Version 005.000.029	10
Related Documents	11

Introduction

PacT Series Master Range

Future-proof your installation with Schneider Electric's low voltage and medium-voltage PacT Series. Built on legendary Schneider Electric innovation, the PacT Series comprises world-class circuit breakers, switches, residual current devices and fuses, for all standard and specific applications. Experience robust performance with PacT Series within the EcoStruxure-ready switchgear, from 16 to 6300 A in low-voltage and up to 40.5 kV in medium-voltage.

EcoStruxure Master Range

EcoStruxure is Schneider Electric's IoT-enabled, plug-and-play, open, interoperable architecture and platform, in Homes, Buildings, Data Centers, Infrastructure and Industries. Innovation at Every Level from Connected Products to Edge Control, and Apps, Analytics and Services.

Link150 Ethernet Gateway

Link150 Ethernet gateway is a communication device that provides connectivity between Ethernet (Modbus TCP/IP) and Modbus serial line devices.

It allows:

- Modbus TCP/IP clients to access information from serial slave devices
- Serial master devices to access information from slave devices distributed across an Ethernet network.

Firmware Release History

Date	Firmware version	Availability
May 2025	005.003.007	Release for manufacturing
July 2024	005.003.003	Obsolete
May 2022	005.002.005	Obsolete
June 2021	005.001.024	Obsolete
April 2021	005.001.022	Obsolete
December 2020	005.001.019	Obsolete
October 2020	005.001.018	Obsolete
December 2019	005.001.015	Obsolete
February 2019	005.000.029	Obsolete

Firmware Update Policy

If the latest features of a firmware update are not required, it is not mandatory to update the firmware of a device. However, potential cybersecurity vulnerabilities are regularly addressed and update is recommended.

Use this release note to determine whether an update to the latest version of the Link150 firmware is interesting or relevant for your application.

Firmware Upgrade via Firmware Upgrade Tool

The Link150 Firmware Upgrade Tool provides the software solution to update the Link150 gateway to the latest firmware version irrespective of the initial version.

The tool is included inside the Link150 firmware update (v5.3.7) package, available as a ZIP file. Once extracted, the Mass Upgrade tool can be used to initiate the firmware upgrade.

You can download the latest version of this tool from the Schneider Electric website: https://www.se.com/in/en/download/document/FW_v5.3.7/. For the latest version number of the tool, refer DOCA0304EN – Link 150 Ethernet Gateway Firmware Upgrade Tool Release Notes.

The firmware update procedure is detailed in DOCA0223EN – *Link150 Ethernet Gateway Firmware Upgrade Tool – User Guide*.

Firmware Versions

Firmware Version 005.003.007

Security updates

- Quality improvement on TLS1.2, Only this version of TLS is supported by this Gateway.

Firmware Version 005.003.003

Security updates

- General cybersecurity and performance improvements.

Firmware Version 005.002.005

Security Updates

- General Security Improvements.
- Product supports Encrypted Firmware upgrade only.

Quality

- Modbus Timeouts Performance Improvements.
- Added Client Connection Timeout and Message Timeout Configuration.
- Modbus Request queue size has been increased from 4 to 10.

Firmware Version 005.001.024

Security Updates

- Removed the support for TLS 1.0 and TLS 1.1.
- Disabled the TCP option **Timestamp**.
- Included the Treck TCP stack patch for IPv6 vulnerabilities.

New Features

Added the user certificate management feature.

Firmware Version 005.001.022

New Features

- Added the configurable Modbus port numbers for remote device connections in Modbus Slave mode.
- Added a feature to disable the Ethernet port not in use.
- Added the security updates in support of SNMP default configurations.

Firmware Version 005.001.019

Bugs Fixed

IP configuration was not possible for some devices according to their MAC address.

Firmware Version 005.001.018

Security Updates

Treck TCP/IP Vulnerabilities (Ripple20) was fixed. Refer to [SEVD-2020-175-01](#) Schneider Electric Security Notification – Treck TCP/IP Vulnerabilities (Ripple20).

NOTE: Link150 gateway with firmware version 005.001.018 cannot be downgraded to older version of firmware (up to version 005.001.015).

Firmware Version 005.001.015

Security Updates

- Security updates in support of:
 - Self-signed certificate
 - Link150 gateway in **HTTPS Enabled** mode by default
 - RBAC-User Account Management supported with Admin and Guest pre-defined roles
- Removed the FTP feature for better security

New Features

Added the following features:

- New user interface layout in the webpages
- RSTP feature
- Firmware update supported through webpage for version 005.001.015

NOTE:

- Firmware version 005.001.015 is not backward compatible with existing User Account Management. By updating to firmware version 005.001.015, user will lose all the user account settings.
- Connection of Modbus TCP/IP cannot be configured from firmware version 005.001.015, and supports up to 32 address.
- Link150 gateway with firmware version 005.001.015 cannot be downgraded to older version of firmware (up to version 005.000.029).

Firmware Version 005.000.029

Bugs Fixed

- Connectivity with PME software for ION connection was improved.
- Modbus slave ID in response to exceptions in Modbus ASCII was corrected.

Related Documents

The following table lists the documents that are compatible with a Link150 gateway with the latest firmware version:

Title of documentation	Publication date	Reference number
Link150 Ethernet Gateway – User Guide	05/2025	DOCA110EN-08
Link150 Ethernet Gateway – Instruction Sheet	11/2021	NHA50221-04
Link150 Ethernet Gateway Firmware Upgrade Tool – User Guide	05/2025	DOCA0223EN-02

You can download these technical publications and other technical information from the website at <https://www.se.com/en/download>.

Schneider Electric
35 rue Joseph Monier
92500 Rueil Malmaison
France

+ 33 (0) 1 41 29 70 00

www.se.com

As standards, specifications, and design change from time to time, please ask for confirmation of the information given in this publication.

© 2025 Schneider Electric. All rights reserved.

DOCA0182EN-06