

SysM/SysD - Connected Push-button Module, 1-gang/2-gang

Device user guide

Information about features and functionality of the device.

03/2025



Legal Information

The information provided in this document contains general descriptions, technical characteristics and/or recommendations related to products/solutions.

This document is not intended as a substitute for a detailed study or operational and site-specific development or schematic plan. It is not to be used for determining suitability or reliability of the products/solutions for specific user applications. It is the duty of any such user to perform or have any professional expert of its choice (integrator, specifier or the like) perform the appropriate and comprehensive risk analysis, evaluation and testing of the products/solutions with respect to the relevant specific application or use thereof.

The Schneider Electric brand and any trademarks of Schneider Electric SE and its subsidiaries referred to in this document are the property of Schneider Electric SE or its subsidiaries. All other brands may be trademarks of their respective owner.

This document and its content are protected under applicable copyright laws and provided for informative use only. No part of this document may be reproduced or transmitted in any form or by any means (electronic, mechanical, photocopying, recording, or otherwise), for any purpose, without the prior written permission of Schneider Electric.

Schneider Electric does not grant any right or license for commercial use of the document or its content, except for a non-exclusive and personal license to consult it on an "as is" basis.

Schneider Electric reserves the right to make changes or updates with respect to or in the content of this document or the format thereof, at any time without notice.

To the extent permitted by applicable law, no responsibility or liability is assumed by Schneider Electric and its subsidiaries for any errors or omissions in the informational content of this document, as well as any non-intended use or misuse of the content thereof.

Table of Contents

Safety Information.....	4
SysM/SysD - Connected Push-button Module, 1-gang/2-gang	5
For your safety	6
About the device.....	6
Installing the device	7
Quick Home Connect.....	8
Pairing Wireless Switch with Push-button Module.....	9
Using the Wireless switch in Quick Home Connect	10
Resetting the Device in Quick Home Connect	13
LED Indications in Quick Home Connect.....	13
Troubleshooting in Quick Home Connect	13
Pairing the device with the Wiser Gateway	14
Pairing device manually.....	15
Pairing device with auto scan.....	17
Configuring the device	18
Changing the device icon	18
Renaming the device	19
Changing the device location	19
Using the device.....	20
Manual operation	20
Switch.....	21
Dimmer	24
Managing dimmer settings.....	26
Shutter control	30
Creating a moment	36
Editing a moment.....	37
Deleting a moment.....	37
Creating an automation	38
Example of an automation	41
Editing an automation.....	42
Deleting an automation	42
Removing the device	43
Resetting the device	43
LED Indication.....	44
Troubleshooting	45
Technical Data	45
Compliance	46
Product Environmental Data.....	46
EU Declaration of Conformity	47
Trademarks.....	47

Safety Information

Important Information

Read these instructions carefully and look at the equipment to become familiar with the device before trying to install, operate, service, or maintain it. The following special messages may appear throughout this manual or on the equipment to warn of potential hazards or to call attention to information that clarifies or simplifies a procedure.



The addition of either symbol to a “Danger” or “Warning” safety label indicates that an electrical hazard exists which will result in personal injury if the instructions are not followed.



This is the safety alert symbol. It is used to alert you to potential personal injury hazards. Obey all safety messages that accompany this symbol to avoid possible injury or death.

DANGER

DANGER indicates a hazardous situation which, if not avoided, **will result in** death or serious injury.

Failure to follow these instructions will result in death or serious injury.

WARNING

WARNING indicates a hazardous situation which, if not avoided, **could result in** death or serious injury.

CAUTION

CAUTION indicates a hazardous situation which, if not avoided, **could result in** minor or moderate injury.

NOTICE

NOTICE is used to address practices not related to physical injury.

SysM/SysD - Connected Push-button Module, 1-gang/2-gang

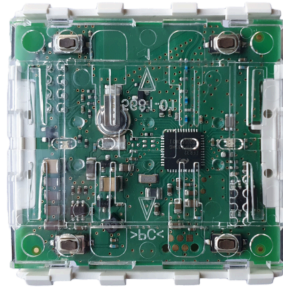

MTN5116-0300 (System M: Connected Push-button Module, 1-gang)

MTN5126-0300 (System M: Connected Push-button Module, 2-gang)

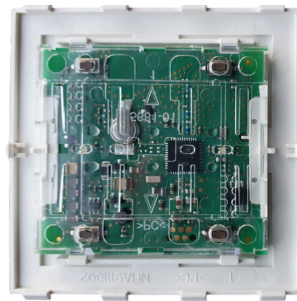

MTN5116-6000 (System Design: Connected Push-button Module, 1-gang)

MTN5126-6000 (System Design: Connected Push-button Module, 2-gang)

For your safety

NOTICE

RISK OF DAMAGE TO DEVICE

Always operate the product in compliance with the specified technical data.

Failure to follow these instructions can result in equipment damage.

About the device

The Connected push-button module, 1-gang/2-gang (hereinafter referred to as a **Push-button module**) allows you to carry out various functions, depending on the insert, such as switching, dimming and controlling the shutter.

The Push-button module can be completed with:

- corresponding 1-gang or 2-gang rockers
- Frame in the corresponding design
- corresponding inserts for switch, dimmer, and shutter or blind control

Insert		Supported Gang	
		1 Gang	2 Gang
Switch	Relay switch inserts	✓	✓
Dimmer	Universal dimmer inserts	✓	✓
	1-10 V insert	✓	X
	DALI insert	✓	X
Shutter	Blind control insert	✓	X

Features of a push-button module

- The Push-button module supports functionality such as switching, dimming and shutter control.
- With the Wiser app, you can combine the settings of one or more devices to form a Moment or an Automation.
- You can create a schedule for the various device functions in an easy manner as per your specific requirements for comfort and convenience.

1-gang, combination of:

- A. Insert
- B. Frame
- C. Push-button module
- D. Rocker

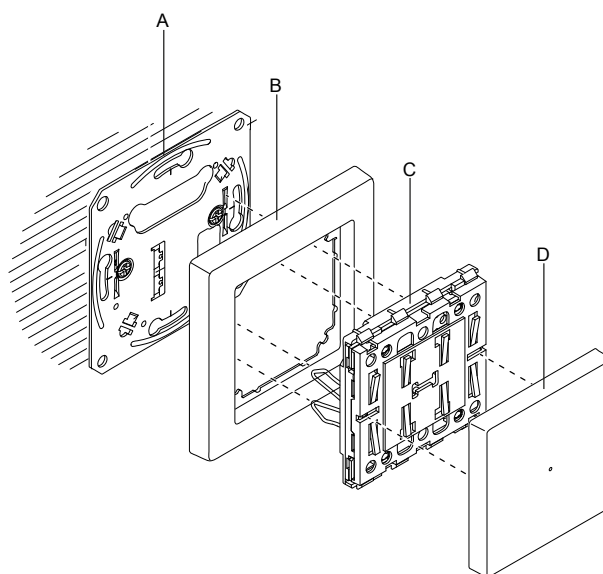

TIP: 1-gang switch shown above with 1-channel insert, 1-gang push-button module, 1-gang rocker and frame, for 2-gang switch choose 2-channel insert, 2-gang push-button module, 2-gang rockers, and it's frame.

NOTE:

- This device user guide shows pairing, configuration and other features of the 1-gang switch, dimmer, and shutter or blind control. The same can be done for the 2-gang supported device.
- The 1 gang push-button module can only be combined with 1 gang insert, and 2-gang push-button module only with 2 gang insert. No combination of 1 gang push-button module with 2 gang insert.

Installing the device

Refer to the installation instruction supplied with this product.
See SysM/SysD - Connected Push-button Module, 1-gang/2-gang.

Quick Home Connect

Quick Home Connect is a wireless connectivity solution for Zigbee devices without the need for a Hub/Gateway or smartphone application. Quick Home Connect is your starting point for wireless home automation. It performs functions like switching, dimming and shutter control using the Connected Wireless Switch (hereinafter referred to as Wireless switch) via a Zigbee network.

The **Wireless switch** is a battery-powered wireless push-button switch that is used to control Zigbee devices (such as dimmer, shutter, switch, and socket) within the same Zigbee network.

Limitations

- Quick Home Connect serves only as a room control solution.
- With a 1-gang Wireless switch, you cannot mix lighting and shutter control. However, with a 2-gang Wireless switch, you can assign one gang for dimming/switching and the other for shutter control, or vice versa.
- This solution does not support remote control, smartphone app usage, or scheduling features.

Pairing Wireless Switch with Push-button Module

1. Short press the upper push button 5 times in quick succession on the Wireless switch.

The status LED blinks green.

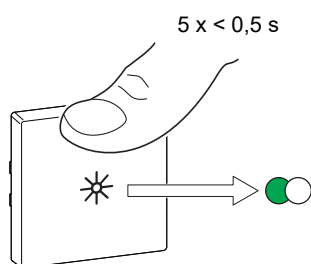

2. Short press the push-button module 5 times in quick succession.

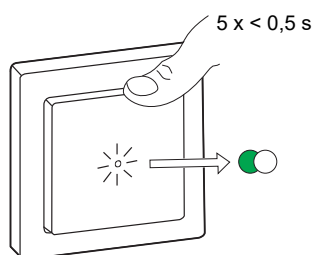

Upon successful pairing, the green LED on the Wireless switch and the push-button module will stop blinking. When the push-button module is connected to the relay or dimmer insert, the connected light blinks for a few times. Similarly, if the push-button module is connected to the shutter insert, the shutter moves up and down for a few times.

You can also use the following scenarios to pair a Wireless switch with a push-button module:

- **1-gang Wireless switch (B) with 1-gang push-button module (A):** Pair the Wireless switch with the push-button module.

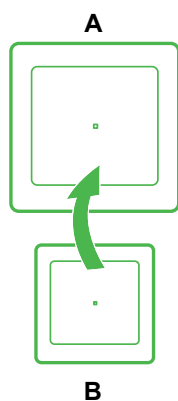

- **1-gang Wireless switch (B) with 2-gang push-button module (A):** Pair the Wireless switch with either the left or right push-button module. You can also pair another rocker of the push-button module with another Wireless switch.

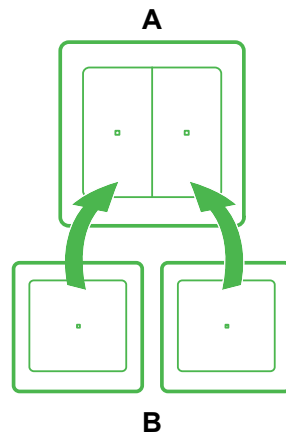

- **2-gang Wireless switch (B) with 1-gang push-button module (A):** Pair either the left or right Wireless switch with the push-button module. You can also pair another rocker of the Wireless switch with another push-button module.

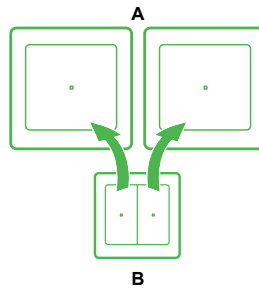

- **2-gang Wireless switch (B) with 2-gang push-button module (A):** Pair the left Wireless switch with either the left or right push-button module, or the right Wireless switch with either the left or right push-button module.

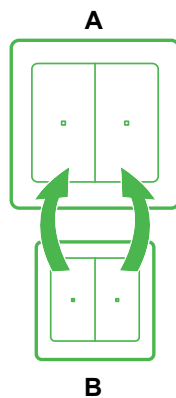

Using the Wireless switch in Quick Home Connect

Operating a Dimmer

You can switch the dimmer ON/OFF and adjust its brightness using the paired Wireless switch.

- Short press the top or bottom of the Wireless switch (< 0,5 s) to turn ON/OFF the connected load (A).

- Long press the top or bottom of the Wireless switch ($> 0,5$ s) to increase or decrease the brightness of the connected load (B).

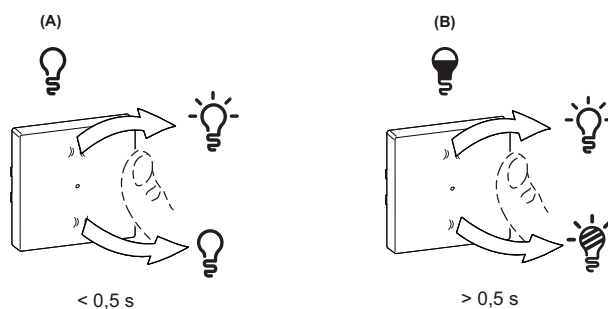

Operating a Relay Switch

You can turn the light ON/OFF using the paired Wireless switch. Short press the top or bottom of the Wireless switch ($< 0,5$ s) to turn ON/OFF the light.

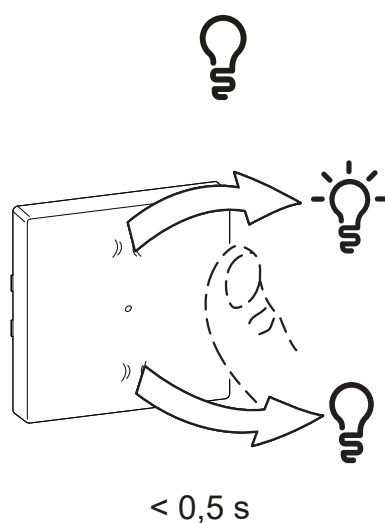

Operating a Shades Control

You can operate the shades control using the Wireless switch.

- Long press the Wireless switch ($> 0,5$ s) to move the shades control up or down.
 - Press to open the shades control (A)
 - Press to close the shades control (B)

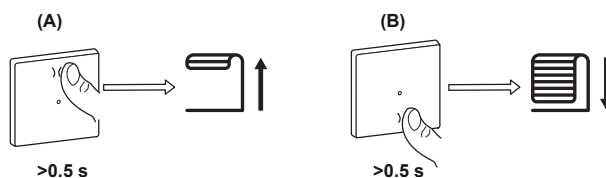

- Short press the top or bottom of the Wireless switch ($< 0,5$ s) to stop the moving shades control (C).

- Short press the top or bottom of the Wireless switch (< 0,5 s) to adjust the slat position (D).

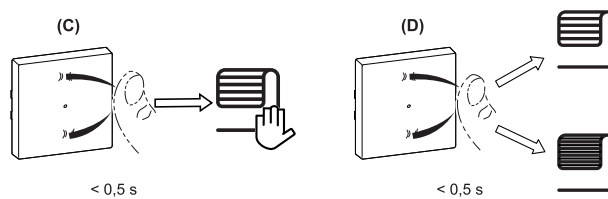

Operating a Push-button Module

Refer to the following topics for operating information with the Wireless switch:

- Operating a dimmer, page 10
- Operating a relay switch, page 11
- Operating a shades control, page 11

Resetting the Device in Quick Home Connect

It is necessary to reset the devices in the following scenarios:



- Unpair the device in Quick Home Connect:
- Refer to
 - Resetting the Wireless switch
 - Resetting the Push-button module

When reset is done successfully. The Wireless switch and device returns to factory default.

- Integrating into Wiser System
 - If you wish to integrate the devices into Wiser System, reset all the devices in Quick Home Connect and refer to pairing the device with Wiser Hub/Gateway.

LED Indications in Quick Home Connect

Pairing the device in Quick Home Connect

User Action	LED Indication	Status
Press the push button 5 times in quick succession.	LED blinks green, once per second. 	Pairing mode is active for 60 seconds. When pairing is completed, LED stops blinking. 

Troubleshooting in Quick Home Connect

Symptom	Possible cause	Solution
LED displays amber on the device.	Pairing not completed and returned to factory default.	Pair the Wireless switch and the device again. Refer to <ul style="list-style-type: none"> • Push-button module, page 9
Wireless switch not able to control the device reliably.	The Wireless switch and the device are too far away from each other.	Place the Wireless switch in a position closer to the device.
	The Wireless switch lost pairing.	Pair the device again. Refer to <ul style="list-style-type: none"> • Push-button module, page 9
	The Wireless switch battery is discharged.	Replace the battery of the Wireless switch

Scenario	Procedure
Control multiple devices with one Wireless switch.	To control multiple devices with a single Wireless switch, start by pairing it with one device. Then, use the same Wireless switch to pair with additional devices. NOTE: You can pair up to 7 devices to a single Wireless switch.
1-gang FLS with devices (relay switch, dimmer, shutter control, or socket outlet).	Pair the Wireless switch with any of the devices (relay switch, dimmer, shutter control, or socket outlet).
2-gang FLS with devices (relay switch, dimmer, shutter control, or socket outlet).	Pair either left or right Wireless switch with any of the devices (relay switch, dimmer, shutter control, or socket outlet). You can also pair another rocker of the Wireless switch with another device.

Pairing the device with the Wiser Gateway

Using the Wiser app, pair your device with the **Gateway/Hub** to access and control the device. You can either add the device manually or do an auto-scan to pair it.

Pairing device manually

You can pair the device to Wiser system manually with or without installed code.

1. On the **Home** page, tap **+**.
2. Tap , select the **Wiser Hub** on the slide-up menu.
3. Select an option to add the device (A):
 - **Add Device with Install Code**
 - **Add Device without Install Code**

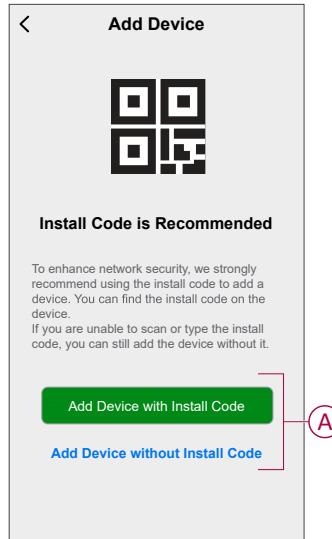

TIP: It is highly recommended to add the device with install code.

4. To pair the device with install code, tap **Add Device with Install Code** to display the slide-up menu. Select any one of the options (B):
 - **Scan Install Code** - you can scan the device for the install code. Position your camera to scan the QR code or barcode available on the device.
 - **Enter Install Code Manually** - you can manually enter the install code on the device.

After adding the device with Install Code, proceed to **Step 6**.

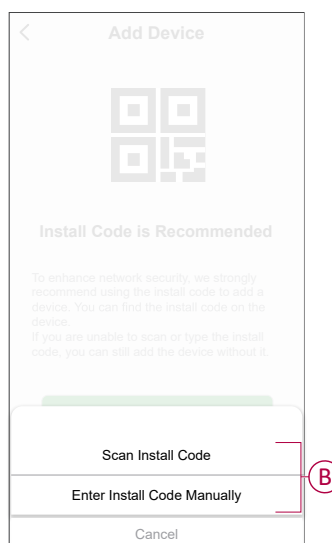

5. To pair the device without install code, tap **Add Device without Install Code**.

6. Short press at the right top corner 3 times.

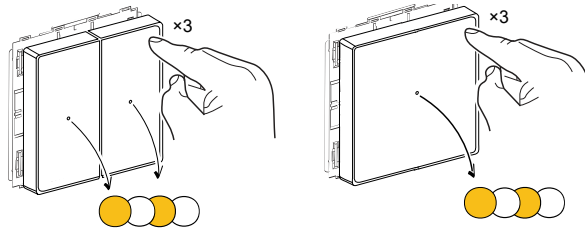

LED blinks orange.

7. In the app, select **Confirm that the LED is blinking (C)** and tap **Start configuration**.

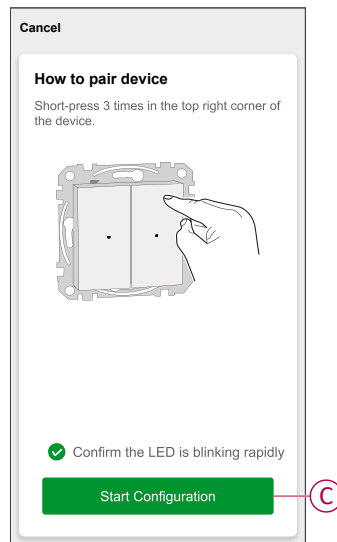

8. After a few seconds, a solid green LED indicates that the device is successfully paired to the Gateway/Hub

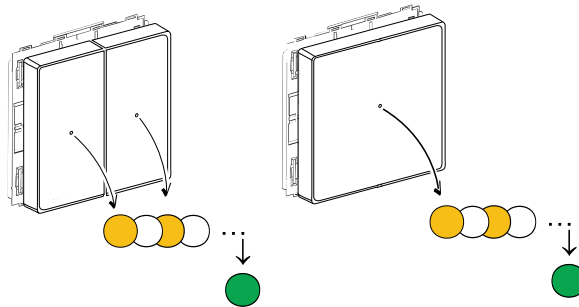

9. Once the device is added in the app, tap **Done**.

Pairing device with auto scan

Pairing the device with auto scan automatically discovers the device when the corresponding device is powered On.

1. On the **Home** page, tap **+**.
2. Tap **Auto scan** > **Confirm** > **Start scanning**.
3. If you have one hub proceed to step 5, if you have multiple hubs then proceed to step 4.
4. Tap **Select hub** and select the **Wiser Hub** from the slide-up menu.
5. Short press the top right key 3 times to start the pairing process.
Wait for a few seconds until the device search is completed.

NOTE: If you want to pair multiple devices at once, perform step 5 on each device and wait for a few seconds.

6. Select **1G Switch** and tap **Next**.

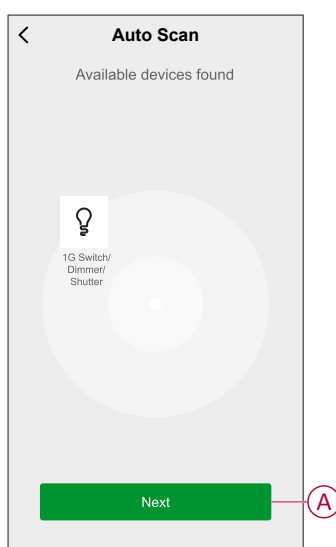



7. Tap **Done** once the device is added successfully.

NOTE: Pairing the device is shown with a 1-gang device as an example. The same process is applicable for the other 1G/2G Switch, Dimmer, and Shutter.

Configuring the device

Changing the device icon

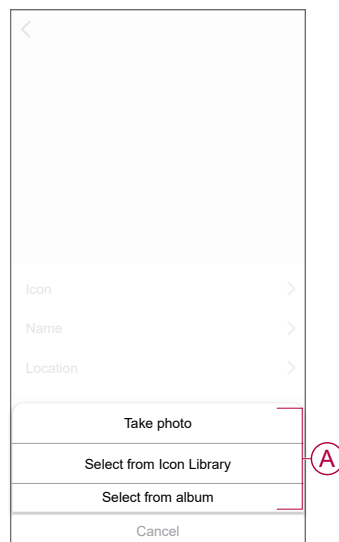

You can change the device icon using the Wiser app.

1. On the **Home** page, select the device for which you wish to change the icon.
2. At the top-right corner of the screen, tap .
3. Tap edit  next to the device name.
4. Tap **Icon** to view the menu.
5. In the slide-up menu, select any one of the following (A) to change the device icon:
 - **Take photo**: Allows you to take a photo with your mobile camera.
 - **Select from Icon Library**: Allows you to select an icon from the app library.
 - **Select from album**: Allows you to select a photo from the mobile gallery.



Renaming the device

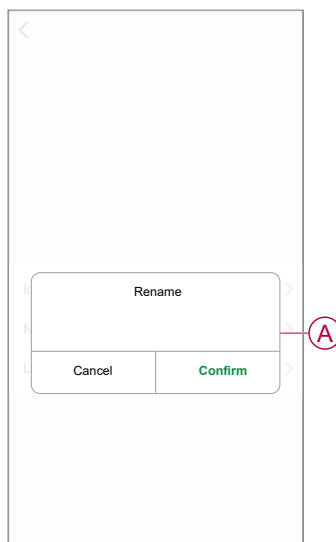

You can rename the device using the Wiser app.

1. On the **Home** page, select the device for which you wish to rename.
2. At the top-right corner of the screen, tap .
3. Tap edit  next to the device name.
4. Tap **Name**, enter the new name (A) and then tap **Confirm**.



Changing the device location

You can change the device location using the Wiser app.

1. On the **Home** page, select the device for which you wish to change the location.
2. At the top-right corner of the screen, tap .
3. Tap edit  next to the device name.
4. Tap **Location**.
5. Select the desired location from the list (A) and then tap **Save**.

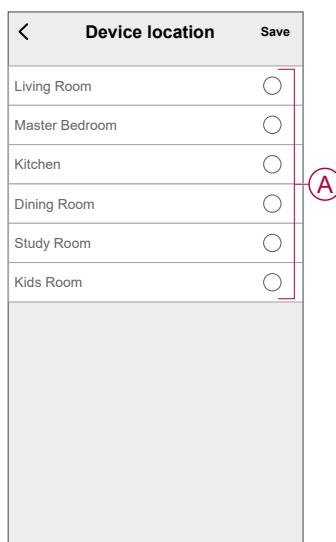

Using the device

Manual operation

You can control the switch, dimmer, and shutter manually using the push-button.

Switch: With the switch insert 1 rocker, you can switch the load on/off.

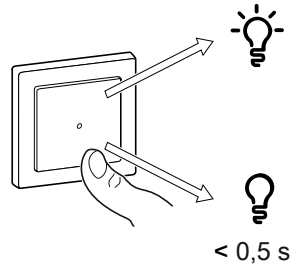

Dimmer: With the dimmer insert 1 rocker,, you can switch the light on/off and dim the lights.

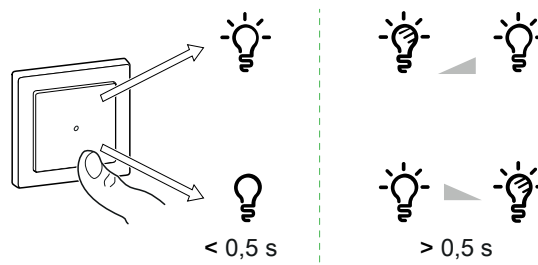

Shutter: With the shutter insert, you can move the shutter up or down and adjust the slat position.

- Long press ($> 0,5$ s) to move the blind up or down (A).
 - Press (\wedge) to open the blind.
 - Press (\vee) to close the blind.
- **Shutter:** Short press ($< 0,5$ s) to stop the moving blind (B).
- **Shutter with tilting slats:** Short press ($< 0,5$ s) to adjust the slat position (C).

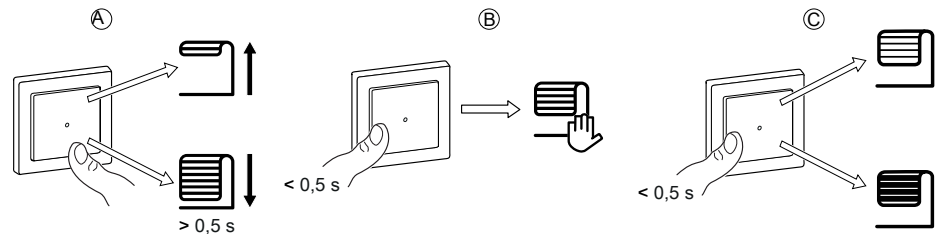

Switch

On the **Home** page, tap **All devices** > **1G Switch** to access the control panel.

On the control panel page, you can see the following:

- The current state of the Switch (A)
- Schedule, page 22 (B)
- Settings, page 23 (C)

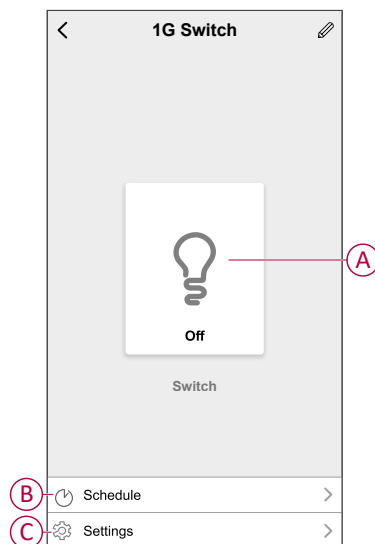

Switching on/off the device using app

By using the Wiser app, you can switch on/off the device.

On the **Home** page, tap the power button (A) to switch on/off the 1G Switch.

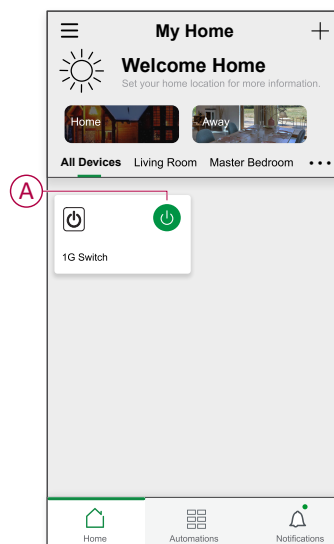

You can also navigate to the control panel, page 21 of the device and tap  to switch on/off.

NOTE: The control panel shows the current state of the Switch.

Creating a schedule

The switch can be controlled and triggered by a schedule. Once the schedule is set, your system will follow the active schedule. You can create or modify the schedules at any time.

1. On the **Home** page, tap **All devices > 1G Switch**.
2. Tap **Schedule > Add schedule** to add a schedule.
3. Set the time (A).
4. Tap **Repeat** (B) to select the days you want to set the schedule.
5. Tap **Note** (C), enter the note and tap **Confirm**.
6. Tap the toggle switch (D) to turn On the **Notification** for the schedule. The app will send a notification when the task is executed at the time of schedule.
7. Tap **Switch** (E) and select one of the options:
 - **On** - Turns on the Switch on the scheduled time
 - **Off** - Turns off the Switch on the scheduled time

The screenshot shows the 'Add Schedule' screen. At the top, there is a back arrow, the title 'Add Schedule', and a 'Save' button. Below the title is a time picker (A) with AM/PM and hour/minute fields. Below the time picker is a 'Repeat' section (B) with a dropdown menu. Below the 'Repeat' section is a 'Note' section (C) with a text input field. Below the 'Note' section is a 'Notification' toggle switch (D). Below the 'Notification' toggle switch is a 'Switch' section (E) with a dropdown menu. At the bottom, there is a note: 'Note - The Schedule works according to the time zone where device is located.'

8. Tap **Save**.

Backlight mode

You can select the LED indicator mode for easy identification of the device status.

1. On the **Home** page, tap **All devices** > **1G Switch**.
2. On the device control panel page, tap **Settings**.
3. Tap **Backlight Mode** (A) and select any one of the following:
 - **Reverse with Load** - The LED on the switch is turned on when the device is turned off.
 - **Consistent with Load** - The LED on the switch is turned on when the device is turned on.
 - **Always Off** - The LED on the switch is always turned off.
 - **Always On** - The LED on the switch is always turned on.

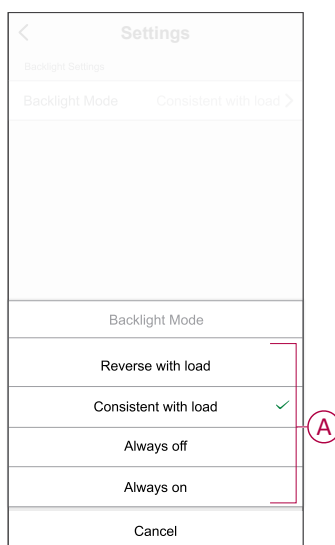

For information on LED color during each modes, refer to LED Indication, page 44.

Dimmer

On the **Home** page, tap **All devices** > **1G Dimmer** to access the control panel.

On the control panel page, you can see the following:

- The current state of the Dimmer (A)
- Sliding bar to adjust the brightness (B)
- The current brightness percentage (C)
- Schedule (D)
- Settings, page 26 (E)

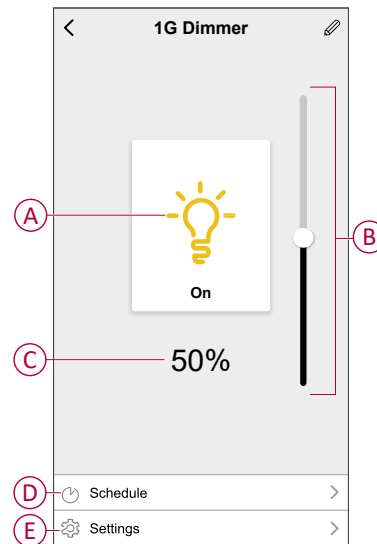

Switching/Dimming the device using app

You can switch on/off and increase/decrease the brightness of the device.

Switch on/off the device

To switch on/off the device:

- On the **Home** page, tap the power button (A) to switch on/off the dimmer.

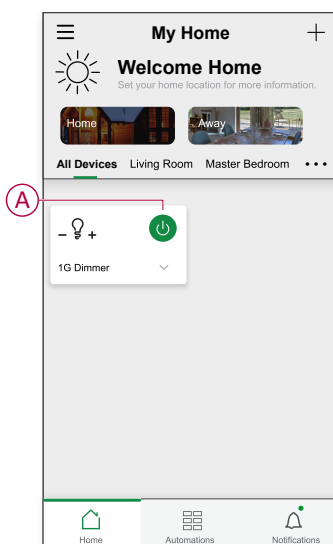

- You can also navigate to the control panel, page 24 of the device and tap  to switch on/off the dimmer.

NOTE: The control panel shows the current state of the dimmer.

Adjusting the brightness of the device

To increase/decrease the brightness of the device:

- On the **Home** page, tap the ▼ (B) for common function and drag the slider to adjust the brightness of the dimmer.

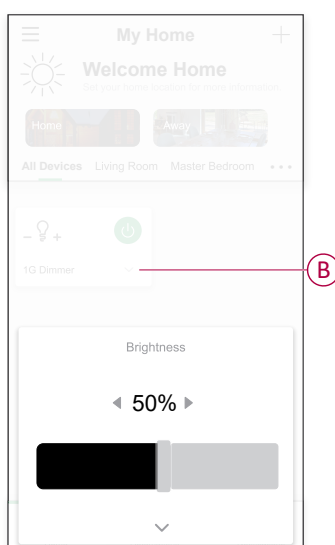

- You can navigate to the control panel, page 24 of the device and drag the sliding bar up/down to increase/decrease the brightness.

NOTE: The control panel shows the current brightness percentage of the dimmer.

Creating a schedule

Using a schedule, you can control and trigger the dimmer. The system will follow the active schedule once it has been set. You can create or modify schedules at any time.

1. On the **Home** page, tap **All devices > 1G Dimmer**.
2. Tap **Schedule > Add schedule** to add a schedule.
3. Set the time (A).
4. Tap **Repeat** (B) to select the days you want to set the schedule.
5. Tap **Note** (C), enter the note and tap **Confirm**.
6. Tap the toggle switch (D) to turn on the **Notification** for the schedule. The app will send a notification when the task is executed at the time of schedule.
7. In the 1G Dimmer section, drag the **sliding bar** (E) to do one of the following:
 - **100%**: turns on the dimmer with maximum brightness on the scheduled time.
 - **Off**: turns off the dimmer on the scheduled time.
 - Drag the sliding bar anywhere in between to turn on the dimmer with a set brightness level on the scheduled time

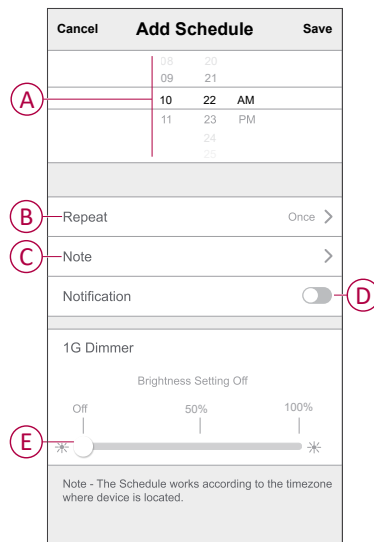

8. Tap **Save**.

Managing dimmer settings

Using The Wiser app, you can manage the dimmer modes and settings.

Follow the steps to access the dimmer settings:

1. On the **Home** page, tap **All devices > 1G Dimmer**.
2. On the device control panel page, tap **Settings**.

Dimming mode

You can change the dimming mode in the app if you have problems with light flickering. This improves the dimming quality.

Tap **Dimming Mode** (A) and select either of the following:

- **Auto** - When any other load is connected to the dimmer (e.g. filament bulb).
- **RL-LED** - When a LED is connected to the dimmer.

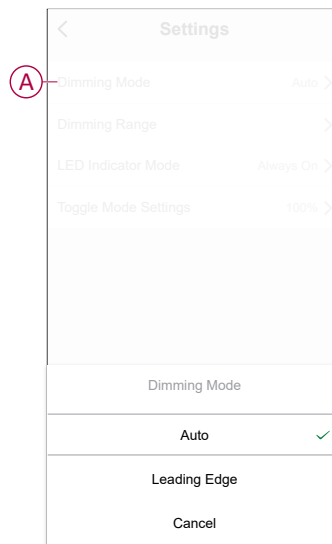

Dimming range

You can restrict the maximum and minimum brightness of the load connected to the device. This is done to avoid flickering and switching off the LED.

Tap **Dimming Range** (B) and do either or both of the following:

- **Min Brightness** - Drag the sliding bar to restrict the minimum brightness.

TIP: If you set the minimum brightness to the right most position on this sliding bar, then the load glows at the minimum brightness even if you drag the sliding bar to the lowest value in the control panel, page 24.

- **Max Brightness** - Drag the sliding bar to restrict the maximum brightness.

TIP: If you set the maximum brightness to the left most position on this sliding bar, then the load glows at the maximum brightness even if you drag the sliding bar to the highest value in the control panel, page 24.

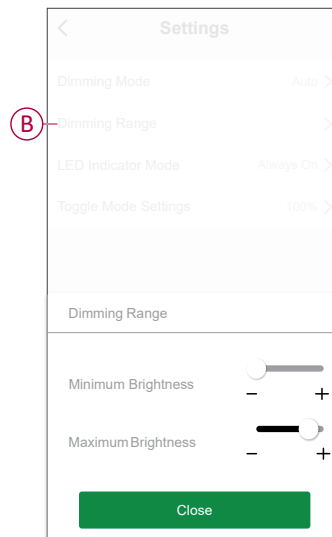

Backlight mode

You can select the LED indicator mode for easy identification of the device status.

Tap **Backlight Mode** (C) and select any one of the following:

- **Reverse With Load** - The LED on the dimmer is turned on when the device is turned off.
- **Consistent With Load** - The LED on the dimmer is turned on when the device is turned on.
- **Always Off** - The LED on the dimmer is always turned off.
- **Always On** - The LED on the dimmer is always turned on.

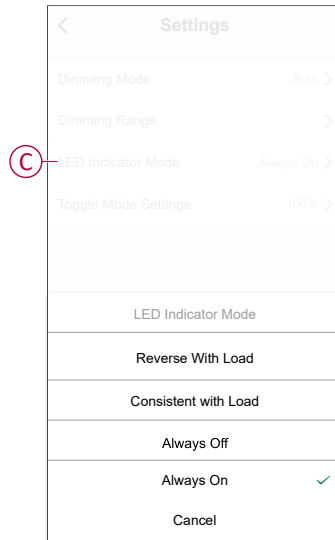

For information on LED color during each modes, refer to [LED indication](#), page 44.

Toggle mode setting

Using this setting, the device will remember the last state of the device.

Tap **Toggle Mode Setting** (D) and select any one of the following:

- **100%** - The LED glows at maximum brightness every time it is turned on.
- **Last Level** (Memory Function) - The LED glows at the previously set brightness level every time it is turned on.

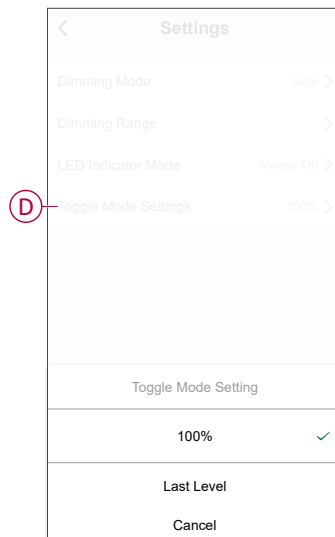

Shutter control

NOTE: Shutter will function only with 1-gang Push-button module only.

On the **Home** page, tap **All devices > 1G Shutter** to access the control panel.

On the control panel page, you can see the following:

- The current state of the device (A)
- Control button (B)
- Slat position control (C)
- Schedule, page 35 (D)
- Settings, page 31 (E)

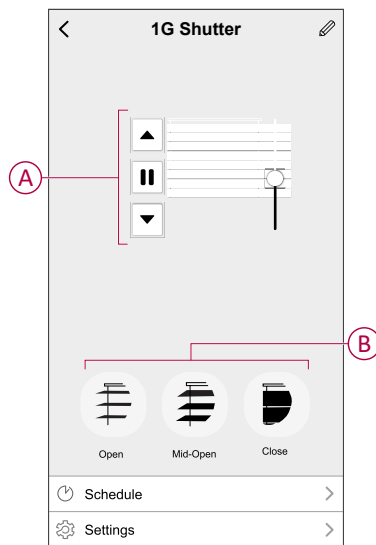

Calibration

The shutter control is supplied in an uncalibrated state. Each shutter motors vary in the speed at which they open and close (edge to edge). Therefore, the opening/closing time of the shutter must be determined in the app.

NOTE:

- Before using this device for the first time, it must be calibrated, or you can adjust its duration manually.
- Do not use the shutter either manually or on the app during calibration to avoid interruption.

Shutter calibrating

To calibrate the run time manually:

1. On the device control panel page, tap **Settings > Open/Close Duration**.
2. On the slide-up menu, you can set the run time manually using **+/-** button or using the sliding bar (A) and then tap **Confirm**.

NOTE: To determine the default run time, record the time it takes to fully open/close the shutter (edge to edge).

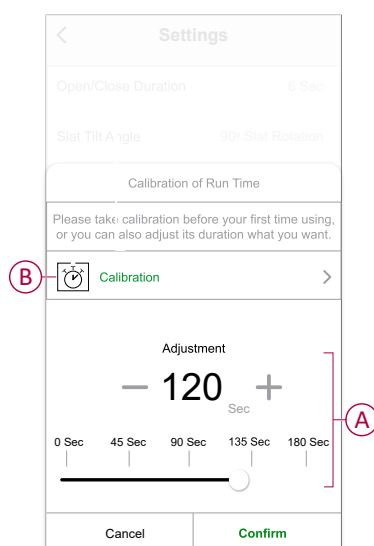

To calibrate the run time using app:

1. In **Settings > Open/Close Duration**, tap **Calibration (B)**.

2. On the slide-up menu, select the calibration start point (C):
 - **Start from the top:** The shutter will move from top to bottom (closing).
 - **Start From the bottom:** The shutter will move from bottom to top (opening).

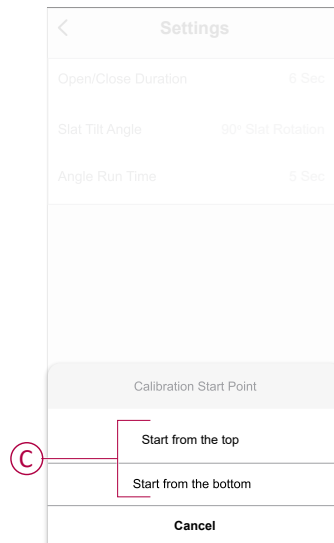

3. Wait until the shutter reaches its starting point and then tap **Start**.
4. Tap **Done (D)** once the shutter reaches other end.

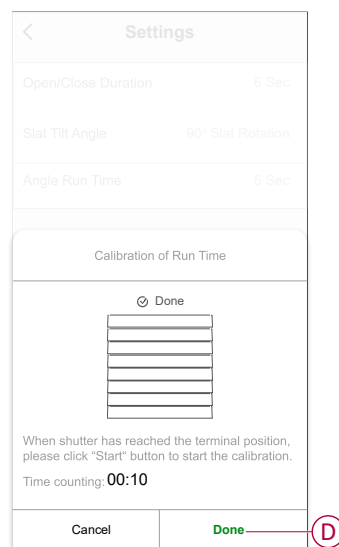

The app displays the progress of calibration.

5. Once the process is complete, tap **Tilt Calibration** on the pop-up window for **shutter slat calibration**.

Slat tilt angle calibration

To calibrate slat tilt angle:

1. On the **Settings** page, tap **Slat Tilt Angle** for slide-up menu.
2. Select tilt type (A) based on the motor installed and then tap **Confirm**:
 - **90° Slat Rotation**
 - **180° Slat Rotation**
 - **Not Supported**
 - **Blind**

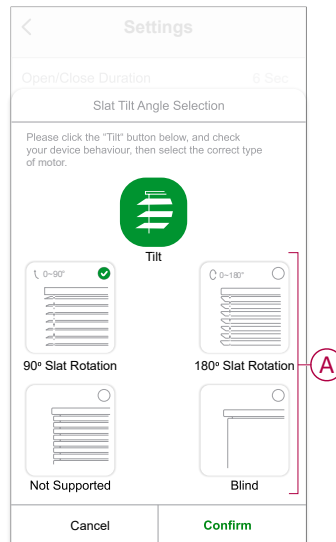

IMPORTANT: If the shutter is installed with a non rotating slat or blind, the calibration process is complete, and no further steps to follow.

3. Read the pop-up notification and tap **Confirm**.
4. Make sure the shutter is in fully closed state and tap **Prepare**.
5. Select the check box (B) and tap **Start**.

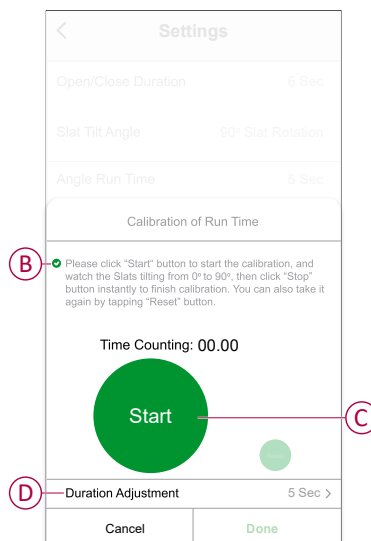

6. Tap **Stop** (C) to finish calibration.

TIP: You can retake the calibration by tapping **Reset**.

7. Tap **Done** once the process is complete.
The app displays the progress of calibration.

TIP: You can set the run time manually by tapping **Duration Adjustment** (D).

Operating the device using app

You can open\close the shutter using the Wiser app.

1. On the **Home** page, Tap **All devices**.
2. In **1G Shutter** Tap on  for slide-up menu.
3. On the slide up menu select **Open/Close** to operate the shutter.

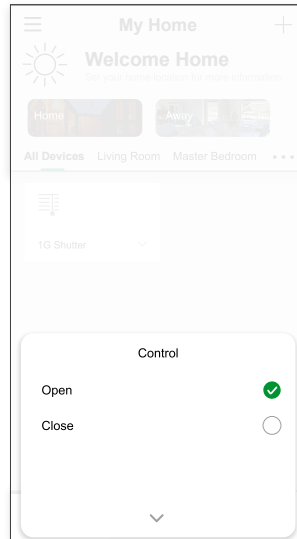

NOTE: You can navigate to the control panel, page 30 of the device to perform the operation. The control panel shows the current state of the device.

Creating a schedule



The device can be fully controlled by schedule. Once the schedule is set, the device operate at a given time.

1. On the **Home** page, Tap **All devices** > **1G Shutter**.
2. Tap **Schedule** > **Add Schedule** to add a schedule.
3. In **Add Schedule** menu, set the time (A).
4. Tap **Repeat** (B) to select the days you want to set the schedule.
5. Tap **Note** (C), enter the note and tap **Confirm**.
6. Tap the toggle switch (D) to turn On the **Notification** for the schedule. The app will send a notification that the scheduled task is executed at the time of schedule.
7. In **Percentage** (E) and drag the sliding bar to adjust or Open/Close the shutter.

8. Tap **Save**.

Creating a moment

A Moment allows you to group multiple actions that are usually done together. Using the Wiser app, you can create moments based on your needs.

1. On the **Home** page, tap .
2. Go to **Moment** > **+** to create a moment.
3. Tap **Edit name** , enter the name of the moment (A) and tap **Confirm**.
TIP: You can choose the cover image that represents your moment by tapping .

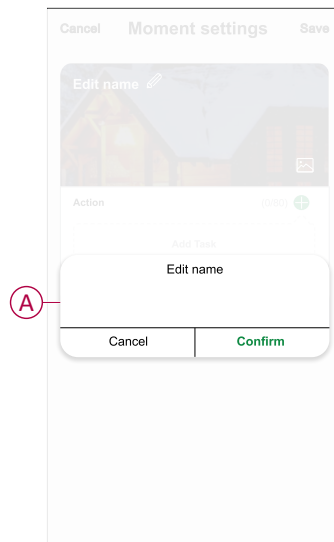

4. In the **Action** section, tap **Add task** (B) to open the slide-up menu.
5. In the **Add task** menu, you can do either or all of the following actions (C):
 - **Run the device** - Select the devices that you want in a moment.
 - **Select Automation** - Select the automation that you want to enable or disable.
 - **Delay** - Set the delay time.

NOTE: You can add one or more actions using .

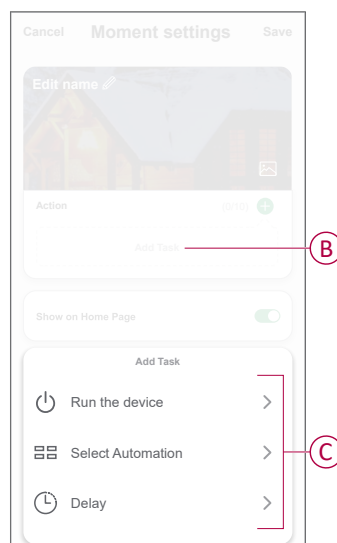

6. Tap **Run the device > 1G Shutter** to select either or all the functions to add in the moment:
 - **Control > Shutter Open / Shutter Close (D).**
 - **Percentage > Set the percentage (E) of moment required.**

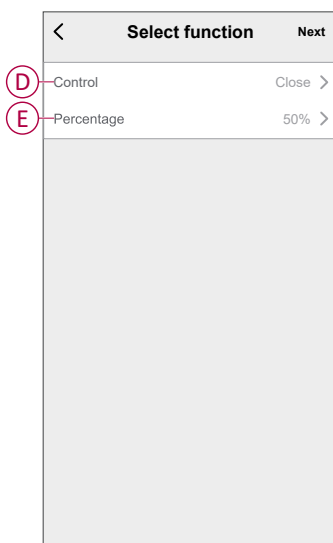

7. Once all the actions are set, tap **Save**.

Editing a moment

1. On the **Moment** tab, locate the moment you want to edit and tap ●●●.
2. On the **Edit** page, you can tap each item (such as dimmer, shutter, delay, temperature, etc.) to change the settings.

TIP:

- You can add one or more actions using .
- To delete an existing action, slide each item towards left and tap **Delete**.

Deleting a moment



To delete a moment:

1. On the **Moment** tab, locate the moment that you want to delete and then tap ●●●.
2. Tap **Delete** and then tap **Ok**.

NOTE: After deleting a moment, the device action can no longer be triggered.

Creating an automation

An automation allows you to group multiple actions that are usually done together, triggered automatically or at scheduled times. By using the Wiserapp, you can create automations based on your needs.

1. On the **Home** page, tap the .
2. Go to **Automation** > **+** to create an automation.
3. Tap **Edit name** , enter the name of the automation (A) and tap **Confirm**.

TIP: You can choose the cover image that represents your automation by tapping .

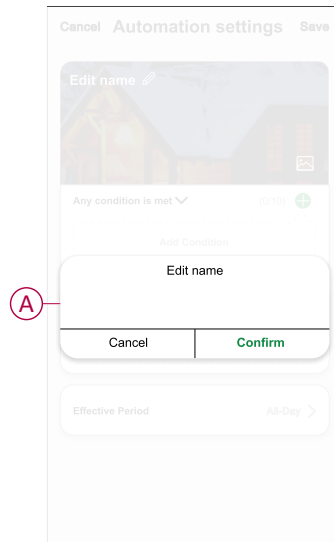

4. Tap **Any condition is met** to select any one of the condition type (B):
 - **All conditions are met** - The automation is triggered when all the conditions are met.
 - **Any condition is met** - The automation is triggered when at least one condition is met.

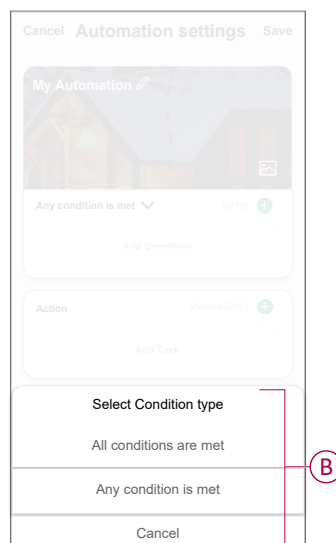

5. Tap **Add Condition** to open the slide-up menu.

6. In the **Add Condition** menu, you can do either or all of the following options (C):

- **When weather changes** - Select the various weather settings.
- **Schedule** - Set the time and day.
- **When device status changes** - Select the device and it's function.

Note: You can add one or more conditions using .

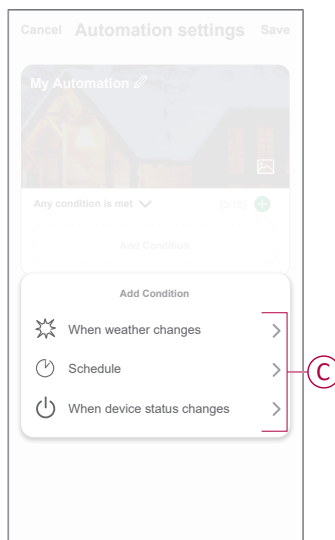

7. Tap **When device status changes > 1G Shutter > Percentage** and update the percentage of closing and opening of shutter

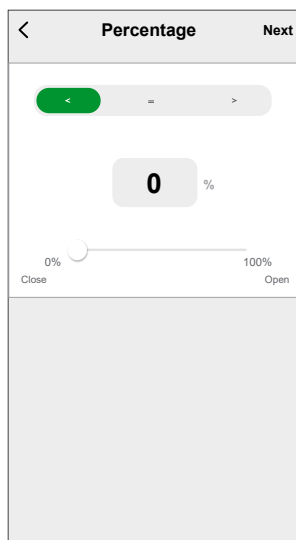

8. Tap **Add task** to open the slide-up menu.

9. In the **Add task** menu, you can do either or all of the following options (D):
- **Run the device** - Select the devices that you want to be triggered.
 - **Moment or Automation** - Select the moment which you want to trigger or select the automation that you want to enable or disable.
 - **Send notification** - Turn on notifications for device conditions.
 - **Delay** - Set the delay time.

NOTE: You can add one or more actions using .

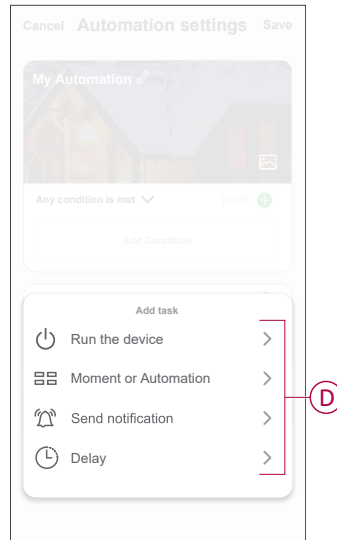

10. Tap on **Effective period** to set the time range for the automation. You can select any one of the following (E):
- **All-day** - 24 hours
 - **Daytime** - From sunrise to sunset
 - **Night** - From sunset to sunrise
 - **Custom** - User defined time period

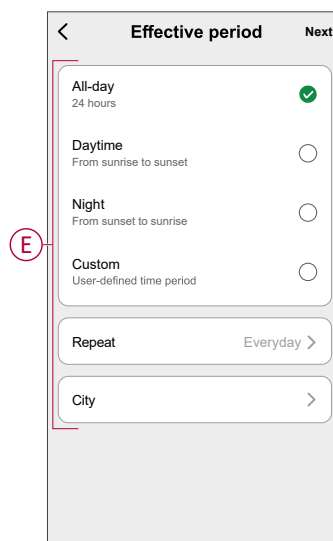



11. Once all the actions and conditions are set, tap **Save**.

Automation is now available under **Automation** tab. Use toggle switch to enable/disable automation.

Example of an automation

This demonstration shows you how to create an automation to open the shutter at the scheduled time.

1. Go to **Automation** > **+** to create an automation.
2. Tap **Edit name** , enter the name of the automation and tap **Confirm**.
TIP: You can choose the cover image that represents your automation by tapping .
3. Tap **Add Condition** > **Schedule**.
 - Tap **Repeat** (A), select the days you want to set the schedule and tap **Save**.
 - Set the time (B) at which the automation must start and tap **Next**.

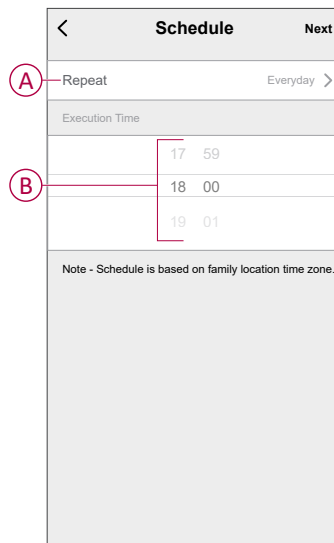

4. Tap **Add task** > **Run the device** > .
5. Tap **Control** > **Shutter Open** (C) and tap **Save**.
6. Tap **Percentage** (D) to update the percentage of shutter opening and tap **Save**.

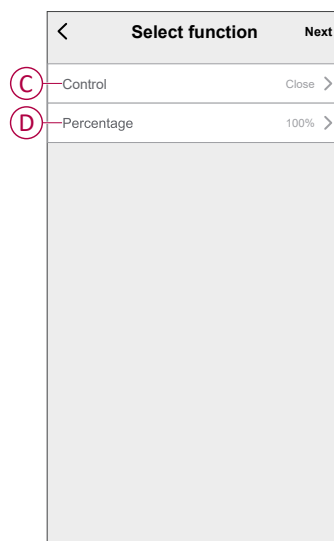

7. Tap **Next**.

8. In the **Automation Settings** page, tap **Save**.

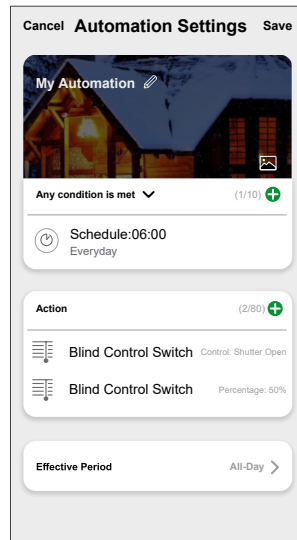

Automation is now available under **Automation** tab. Use toggle switch to enable/disable automation.

Editing an automation

1. On the **Automation** tab, locate the automation you want to edit and tap ●●●.
2. On the **Edit** page, you can tap each item (such as dimmer, shutter, delay, temperature, etc.) to change the settings.

TIP:

- You can add one or more condition or actions using .
- To delete an existing condition or action, slide each item towards left and tap **Delete**.

Deleting an automation

1. On the **Automation** tab, locate the automation that you want to delete and then tap ●●●.
2. Tap **Delete** and then tap **Ok**.

NOTE: After deleting an automation, the device action can no longer be triggered.

Removing the device

You can remove a device from the Wiser system using app.

1. On the **Home** page, select the device for which you wish to remove.
2. At the top-right corner of the screen, tap .
3. Tap **Remove and Factory Reset Device**.

TIP: On the home page, you can tap and hold the device button to remove from Wiser system.

NOTE: By removing the device, you will reset the device. If you still have a problem with the reset, then refer to [resetting the device](#), page 43.

Resetting the device

You can reset the Push-button module to the factory default manually at any time.

Short press the top-center push-button 3 times and hold for 10 seconds to reset the device to the factory default mode.

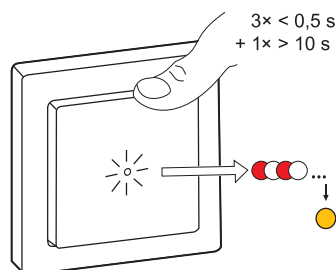



TIP: In case of the 2-gang Push-button module, short press the top-right push-button 3 times and hold for 10 seconds to reset the device to the factory default mode.



NOTE: All data related to configuration, users, and the network are deleted completely.

LED Indication





Pairing

User Action	LED Indication	Status
Press the push-button 3 times	LED blinks amber per second. 	Pairing mode is active for 30 seconds. When pairing is completed, LED glows green for some time before turning off. 

Resetting



User Action	LED Indication	Status
Press the push-button 3 times and hold it down once for > 10 s.	After 10 s, the LED blinks red. 	The device is in reset mode. It is reset to the factory settings after 10 seconds. The device then restarts and the LED blinks green for a few seconds and then stays amber. 

LED Indicator Mode/Backlight Mode

Load Status	ON	OFF
Reverse with load	No LED	
Consistent with load		No LED
Always Off	No LED	No LED
Always On		

Troubleshooting

Symptom	Solution
Switch The device is not ready to pair after the device is removed from the app	Reset to factory default settings.
Dimmer Dimming up not possible	<ul style="list-style-type: none"> Reduce or increase load Allow the pushbutton to cool in case of overheating Change the load (if the load is incompatible with the dimmer)
Switching on not possible	<ul style="list-style-type: none"> Allow the pushbutton to cool in case of overheating Reduce load Change load Check wiring
Flickering at minimum brightness	<ul style="list-style-type: none"> Increase minimum brightness (if flickering still persists, install a 31LCDA load correction device) Change the load (if the minimum brightness is insufficient) Set RL LED mode (it is advised to use 10% of nominal load to avoid overheating of the dimmer)
Flickering	<ul style="list-style-type: none"> Change load Set RL LED mode (it is advised to use 10% of nominal load to avoid overheating of the dimmer)
Only slight dimming capability	<ul style="list-style-type: none"> Change dimming range Set RL LED mode (it is advised to use 10% of nominal load to avoid overheating of the dimmer) Change the load (if the load is incompatible with the dimmer)
Shutter No shutter movement or uncontrolled shutter movement	<ul style="list-style-type: none"> Check power supply Change the load Change wiring

Symptom	Possible cause	Solution
The device is not able to connect with the Hub. After pressing 3 times, the device LED blinks green/red for 30 s.  NOTE: This does not apply to newer Zigbee® model.	Pairing mode has changed.	<ol style="list-style-type: none"> Factory reset the device. After reset, press top right corner of the switch for 4 times and then hold for 20 s, until the LED blinks red.  The device should reboot into the correct mode. After reboot, press 3 times on top right corner of the switch to initiate pairing mode. LED flashes orange. 

Technical Data

Display elements	1, respectively 2 LED (status and orientation)
Operating elements	2, respectively 4 push-buttons
Operating frequency	2405-2480 MHz
Max. radio-frequency power transmitted	< 10 mW
Communication protocol	Zigbee 3.0 certified

Compliance

Product Environmental Data

Find and download comprehensive environmental data about your products, including RoHS compliance and REACH declarations as well as Product Environmental Profile (PEP), End-of-Life instructions (EOL) and much more.

<https://www.se.com/myschneider>



General information about Schneider Environmental Data Program

Click the link below to read about Schneider Electric's Environmental Data Program.

<https://www.se.com/ww/en/about-us/sustainability/environmental-data-program/>



EU Declaration of Conformity

Hereby, Schneider Electric Industries, declares that this product is in compliance with the essential requirements and other relevant provisions of RADIO DIRECTIVE 2014/53/EU. Declaration of conformity can be downloaded on se.com/docs.

Trademarks

This guide makes reference to system and brand names that are trademarks of their relevant owners.

- Zigbee® is a registered trademark of the Connectivity Standards Alliance.
- Apple® and App Store® are brand names or registered trademarks of Apple Inc.
- Google Play™ Store and Android™ are brand names or registered trademarks of Google Inc.
- Wi-Fi® is a registered trademark of Wi-Fi Alliance®.
- Wiser™ is a trademark and the property of Schneider Electric, its subsidiaries and affiliated companies.
- Amazon Alexa™ is a trademark of AMAZON TECHNOLOGIES, INC.
- Google Home™ is a trademark of Google INC.

Other brands and registered trademarks are the property of their respective owners.

Schneider Electric
35 rue Joseph Monier
92500 Rueil Malmaison
France

+ 33 (0) 1 41 29 70 00

www.se.com

As standards, specifications, and design change from time to time, please ask for confirmation of the information given in this publication.

© 2023 – 2025 Schneider Electric. All rights reserved.

DUG_Push-button Module_WSE-02