

SysM/SysD - Connected Single Socket Outlet 16A

Device user guide

Information about features and functionality of the devices

03/2025

Legal Information

The information provided in this document contains general descriptions, technical characteristics and/or recommendations related to products/solutions.

This document is not intended as a substitute for a detailed study or operational and site-specific development or schematic plan. It is not to be used for determining suitability or reliability of the products/solutions for specific user applications. It is the duty of any such user to perform or have any professional expert of its choice (integrator, specifier or the like) perform the appropriate and comprehensive risk analysis, evaluation and testing of the products/solutions with respect to the relevant specific application or use thereof.

The Schneider Electric brand and any trademarks of Schneider Electric SE and its subsidiaries referred to in this document are the property of Schneider Electric SE or its subsidiaries. All other brands may be trademarks of their respective owner.

This document and its content are protected under applicable copyright laws and provided for informative use only. No part of this document may be reproduced or transmitted in any form or by any means (electronic, mechanical, photocopying, recording, or otherwise), for any purpose, without the prior written permission of Schneider Electric.

Schneider Electric does not grant any right or license for commercial use of the document or its content, except for a non-exclusive and personal license to consult it on an "as is" basis.

Schneider Electric reserves the right to make changes or updates with respect to or in the content of this document or the format thereof, at any time without notice.

To the extent permitted by applicable law, no responsibility or liability is assumed by Schneider Electric and its subsidiaries for any errors or omissions in the informational content of this document, as well as any non-intended use or misuse of the content thereof.

Table of Contents

Safety Information.....	4
SysM/SysD - Connected Single Socket Outlet 16A	5
For your safety	5
About the device.....	5
Installing the device	6
Quick Home Connect.....	7
Pairing Wireless Switch with Single Socket OutletSocket Outlet	8
Operating a Socket Outlet.....	8
Resetting the Device in Quick Home Connect	9
LED Indications in Quick Home Connect.....	9
Troubleshooting in Quick Home Connect	9
Pairing the device with the Wiser Gateway	10
Pairing device manually.....	10
Pairing device with auto scan	11
Configuring the device	12
Changing the device icon	12
Renaming the device	13
Changing the device location	13
Removing the device	14
Resetting the device	15
Using the device.....	15
Switching On/Off the device manually.....	16
Switching On/Off the device using app.....	16
Creating a schedule	16
Checking the energy consumption	17
Selecting LED indicator mode	18
Creating a moment	18
Creating an automation	21
LED Indication.....	25
Troubleshooting	26
Technical Data	26
Compliance.....	27
Product Environmental Data.....	27
Trademarks.....	27

Safety Information

Important Information

Read these instructions carefully and look at the equipment to become familiar with the device before trying to install, operate, service, or maintain it. The following special messages may appear throughout this manual or on the equipment to warn of potential hazards or to call attention to information that clarifies or simplifies a procedure.



The addition of either symbol to a “Danger” or “Warning” safety label indicates that an electrical hazard exists which will result in personal injury if the instructions are not followed.



This is the safety alert symbol. It is used to alert you to potential personal injury hazards. Obey all safety messages that accompany this symbol to avoid possible injury or death.

DANGER

DANGER indicates a hazardous situation which, if not avoided, **will result in** death or serious injury.

Failure to follow these instructions will result in death or serious injury.

WARNING

WARNING indicates a hazardous situation which, if not avoided, **could result in** death or serious injury.

CAUTION

CAUTION indicates a hazardous situation which, if not avoided, **could result in** minor or moderate injury.

NOTICE

NOTICE is used to address practices not related to physical injury.

SysM/SysD - Connected Single Socket Outlet 16A



MTN2380-0xxx (System M)



MTN2380-60xx (System Design)

For your safety

⚠ DANGER

HAZARD OF ELECTRIC SHOCK, EXPLOSION, OR ARC FLASH

Safe electrical installation must be carried out only by skilled professionals. Skilled professionals must prove profound knowledge in the following areas:

- Connecting to installation networks.
- Connecting several electrical devices.
- Laying electric cables.
- Safety standards, local wiring rules and regulations.

Failure to follow these instructions will result in death or serious injury.

About the device

The Connected Single Socket Outlet 16A (hereinafter referred to as **Socket Outlet**) is a connected electrical outlet designed to manage and control electrical devices in a convenient and efficient manner. You can remotely control and monitor the energy consumption of the plugged-in load.

The Socket outlet is equipped with a temperature protection mechanism. When the Socket outlet is used with a high load over a long time, the mechanism can switch off the Socket outlet, ensuring overheat protection.

The Socket outlet is equipped with an overload protection mechanism. When the Socket outlet is used with a high load (18 A and high), the mechanism can switch off the Socket outlet, ensuring overload protection.

NOTE:

- The device must not control safety-relevant applications
- Do not mix different load types in the controlled socket
- Do not use multi-sockets in the controlled socket
- Do not use for EV charging

Operating elements

A: Push button with status LED

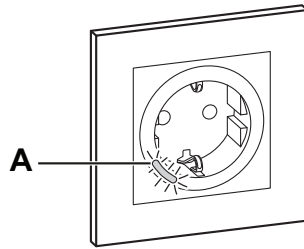

Installing the device

Refer to the installation instruction supplied with this product.

See SysM/SysD - Connected Single Socket Outlet 16A.

Quick Home Connect

Quick Home Connect is a wireless connectivity solution for Zigbee devices without the need for a Hub/Gateway or smartphone application. Quick Home Connect is your starting point for wireless home automation. It performs functions like switching, dimming and shutter control using the Connected Wireless Switch (hereinafter referred to as Wireless switch) via a Zigbee network.

The **Wireless switch** is a battery-powered wireless push-button switch that is used to control Zigbee devices (such as dimmer, shutter, switch, and socket) within the same Zigbee network.

Limitations

- Quick Home Connect serves only as a room control solution.
- With a 1-gang Wireless switch, you cannot mix lighting and shutter control. However, with a 2-gang Wireless switch, you can assign one gang for dimming/switching and the other for shutter control, or vice versa.
- This solution does not support remote control, smartphone app usage, or scheduling features.

Pairing Wireless Switch with Single Socket Outlet

1. Short press the upper push button 5 times in quick succession on the Wireless switch.

The status LED blinks green.

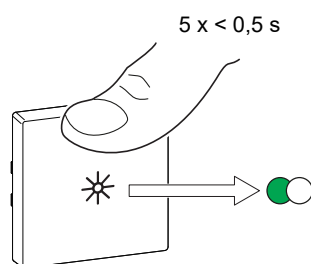

2. Short press the push-button of the Socket Outlet 5 times in quick succession.

The status LED blinks green.

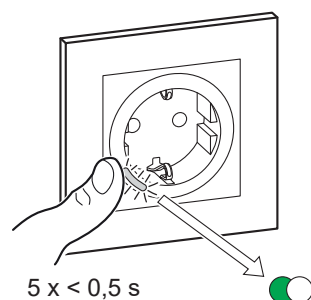

Upon successful pairing, the green LED on the Wireless switch and the Socket Outlet will stop blinking.

Operating a Socket Outlet

Short press the top or bottom of the Wireless switch (< 0,5 s) to turn ON/OFF the socket.

The LED blinks red indicating that the socket outlet is turned On.

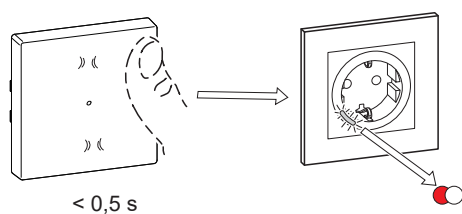

Resetting the Device in Quick Home Connect

It is necessary to reset the devices in the following scenarios:



- Unpair the device in Quick Home Connect:
- Refer to
 - Resetting the Wireless switch
 - Resetting the Socket outlet

When reset is done successfully. The Wireless switch and device returns to factory default.

- Integrating into Wiser System
 - If you wish to integrate the devices into Wiser System, reset all the devices in Quick Home Connect and refer to pairing the device with Wiser Hub/Gateway.

LED Indications in Quick Home Connect

Pairing the device in Quick Home Connect

User Action	LED Indication	Status
Press the push button 5 times in quick succession.	LED blinks green, once per second. 	Pairing mode is active for 60 seconds. When pairing is completed, LED stops blinking. 

Troubleshooting in Quick Home Connect

Symptom	Possible cause	Solution
LED displays amber on the device.	Pairing not completed and returned to factory default.	Pair the Wireless switch and the device again. Refer to <ul style="list-style-type: none"> • Socket outlet, page 8
Wireless switch not able to control the device reliably.	The Wireless switch and the device are too far away from each other.	Place the Wireless switch in a position closer to the device.
	The Wireless switch lost pairing.	Pair the device again. Refer to <ul style="list-style-type: none"> • Socket outlet, page 8
	The Wireless switch battery is discharged.	Replace the battery of the Wireless switch

Scenario	Procedure
Control multiple devices with one Wireless switch.	To control multiple devices with a single Wireless switch, start by pairing it with one device. Then, use the same Wireless switch to pair with additional devices. NOTE: You can pair up to 7 devices to a single Wireless switch.
1-gang FLS with devices (relay switch, dimmer, shutter control, or socket outlet).	Pair the Wireless switch with any of the devices (relay switch, dimmer, shutter control, or socket outlet).
2-gang FLS with devices (relay switch, dimmer, shutter control, or socket outlet).	Pair either left or right Wireless switch with any of the devices (relay switch, dimmer, shutter control, or socket outlet). You can also pair another rocker of the Wireless switch with another device.

Pairing the device with the Wiser Gateway

Using the Wiser app, pair your device with the **Gateway/Hub** to access and control the device. You can either add the device manually or do an auto-scan to pair it.

NOTE: The Socket Outlet shows a non-zero energy consumption value when the device is added to the app if the Socket Outlet was in ON state with a load connected before pairing it to the **Gateway/Hub**.

Pairing device manually

To pair the device manually:

1. On **Home** page, tap **+**.
2. Tap  and select the **Wiser Hub**.
3. Select an option to add the device (A):
 - **Add Device with Install Code**
 - **Add Device without Install Code**

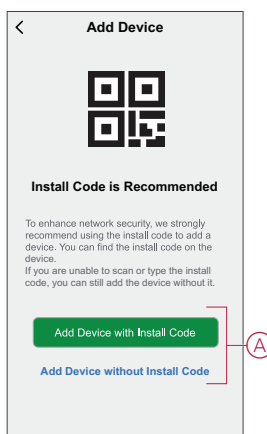

TIP: It is highly recommended to add the device with install code.

4. To pair the device with install code, tap **Add Device with Install Code** to display the slide-up menu. Select any one of the options (B):
 - **Scan Install Code** - you can scan the device for the install code.
 - **Enter Install Code Manually** - you can manually enter the install code from the device.

After pairing the device with install code, proceed to **Step 6**.

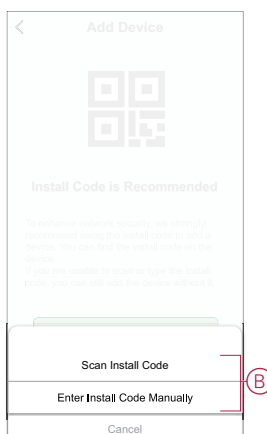

5. To pair the device without install code, tap **Add Device without Install Code**.

6. Short press the push button 3 times ($< 0,5$ s) on the device.

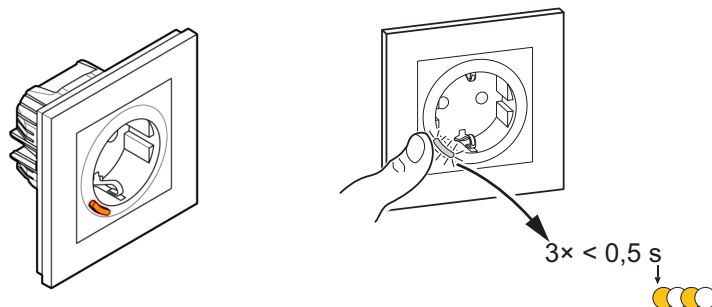

The LED blinks amber.

7. In the app, select **Confirm that the LED is blinking amber** and tap **Start configuration (C)**.

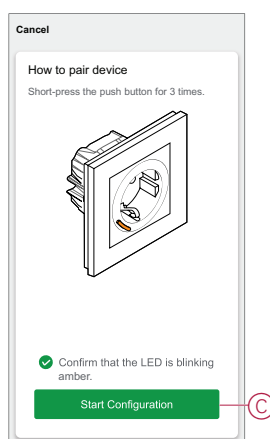

The app displays the progress of connecting the device.

8. After a few seconds, a solid green LED indicates that the device is successfully paired to the Gateway/Hub.

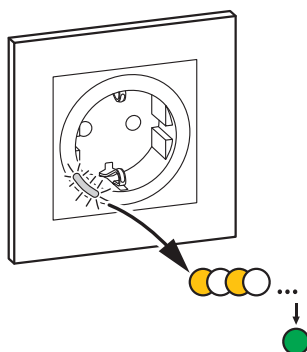

9. Once the device is added in the app, tap **Done**.

Pairing device with auto scan

Pairing the device with auto scan automatically discovers the device when the corresponding device is powered on.

To pair the device:

1. On the **Home** page, tap **+**.
2. Tap **Auto scan** and tap **Confirm**.
3. If you have multiple gateways, do Step 4 or proceed to Step 5.
4. Tap **Select hub** and select the Wiser hub from the slide-up menu.

- Short press the push button 3 times (< 0,5 s).

NOTE:

- The LED blinks amber.
- Wait for a few seconds until the device search is complete.

TIP: If you want to pair multiple devices at once, perform step 5 on each device and wait for a few seconds.

- Tap **Next** (A) and select **Connected Single Socket Outlet 16A**.

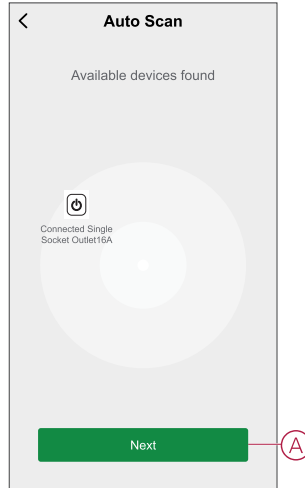



- Once the device is added successfully, tap **Done**.

Configuring the device

Changing the device icon

You can change the device icon using the Wisir app.

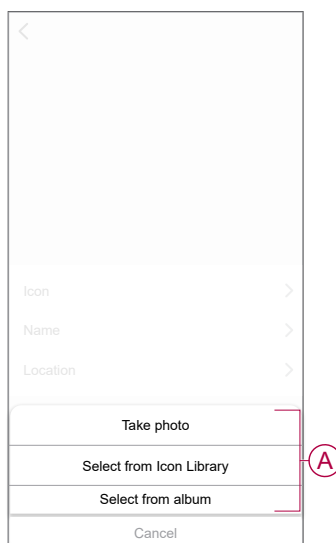

- On the **Home** page, select the device for which you wish to change the icon.
- At the top-right corner of the screen, tap .
- Tap edit  next to the device name.
- Tap **Icon** to view the menu.

5. In the slide-up menu, select any one of the following (A) to change the device icon:
 - **Take photo**: Allows you to take a photo with your mobile camera.
 - **Select from Icon Library**: Allows you to select an icon from the app library.
 - **Select from album**: Allows you to select a photo from the mobile gallery.



Renaming the device

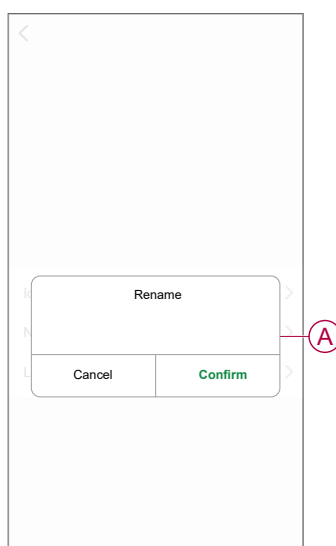

You can rename the device using the Wisers app.

1. On the **Home** page, select the device for which you wish to rename.
2. At the top-right corner of the screen, tap .
3. Tap edit  next to the device name.
4. Tap **Name**, enter the new name (A) and then tap **Confirm**.



Changing the device location

You can change the device location using the Wisers app.

1. On the **Home** page, select the device for which you wish to change the location.
2. At the top-right corner of the screen, tap .
3. Tap edit  next to the device name.
4. Tap **Location**.
5. Select the desired location from the list (A) and then tap **Save**.

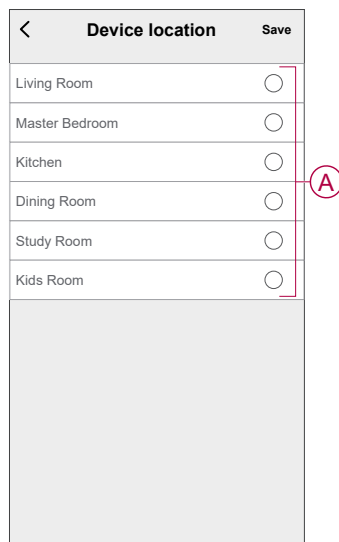

Removing the device

Using the Wiser app, you can remove a device from the device list.
To remove the device:

1. On the **Home** page, tap **All devices > Connected Single Socket Outlet**.
2. Tap  to display more details.
3. Tap **Remove and Factory Reset Device** (A).

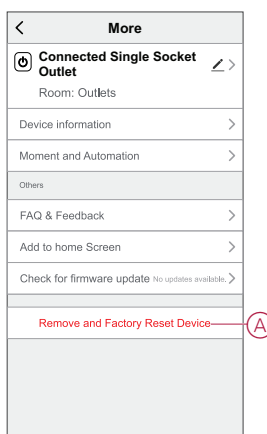

TIP: Alternatively, you can long tap on the **Connected Single Socket Outlet** on the **Home** page to remove the device.

NOTE: By removing the device, you will reset the device. If you still have a problem with the reset, then refer to [resetting the device](#), page 15.

Resetting the device

You can reset the device to factory default manually.
To reset the device:

1. Short press the push button three times (< 0.5 s) and then long press the push button once (> 10 s).
2. After 10 s, LED starts blinking red then release the push button.
The LED stops blinking upon successful reset of the device.
3. The plug restarts and blinks green for a few seconds.

NOTE: After reset, the LED stays amber.

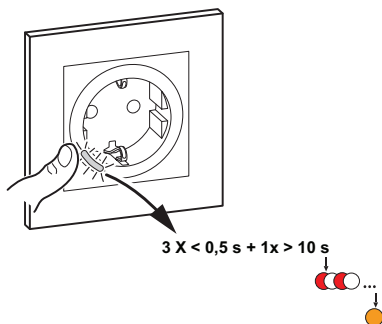

Using the device

The Control Panel allows you to switch the Socket Outlet On and Off and monitor the energy consumption.

On the **Home** page, tap **All devices** > **Connected Single Socket Outlet** to access the control panel.

On the Socket Outlet control panel page, you can see the following:

- Power (W) - The load value of the device connected to the Socket Outlet (A)
- Day (kWh) - The total energy consumption of the device connected to the Socket Outlet per day (B)

NOTE: The total energy consumption per day value will automatically reset to zero at 00:00 hrs everyday.

- The current state of the Socket Outlet (C)
- Schedule, page 16 (D)
- Consumption, page 17 (E)
- Settings, page 18 (F)

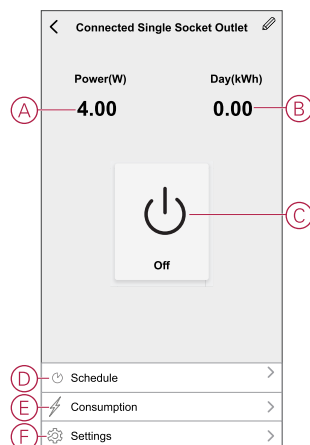

Switching On/Off the device manually

You can switch On/Off the Socket Outlet manually. The Socket Outlet will provide power to the electrical appliance connected to it. Short press the push button on the device once to switch On/Off the Socket Outlet.

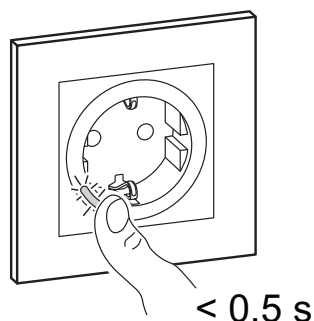

Switching On/Off the device using app

By using the Wiser app, you can switch On/Off the device. To switch the device On/Off:

1. On the **Home** page, tap the power button (A) to switch On/Off the Socket Outlet.

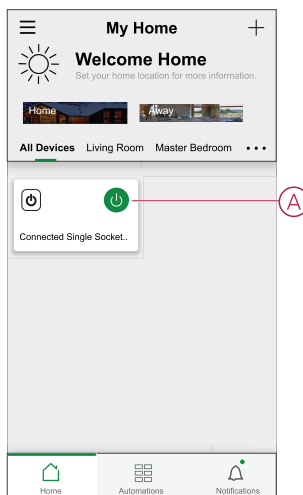

2. Alternatively, you can navigate to the control panel, page 15 of the device and tap  to switch On/Off the Socket Outlet.

NOTE: The control panel shows the current state of the Socket Outlet.

Creating a schedule

The Socket Outlet can be controlled and triggered by a schedule. Once the schedule is set, your system will follow the active schedule. You can create or modify the schedules at any time. To create a schedule:

1. On the **Home** page, tap **All devices > Connected Single Socket Outlet**.
2. Tap **Schedule > Add schedule** to add a schedule.
3. Set the time (A).
4. Tap **Repeat** (B) to select the days you want to set the schedule.

5. Tap **Note** (C), enter the note and tap **Confirm**.
6. Tap the toggle switch (D) to turn On the **Notification** for the schedule. The app will send a notification that the scheduled task is executed at the time of schedule.
7. Tap **Socket** (E) and select one of the options:
 - **On** - Turns On the Socket Outlet on the scheduled time
 - **Off** - Turns Off the Socket Outlet on the scheduled time

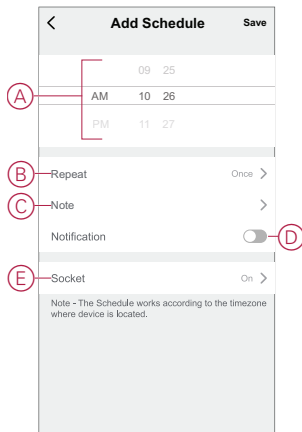

8. Tap **Save**.

Checking the energy consumption

Using the Wiser app, you can monitor the energy consumption of the load connected to the device by accessing the consumption feature.

TIP: You can see the daily real-time energy consumption value of the load connected to the device on the [control panel](#), [page 15](#) of the device.

To check the device energy consumption history:

1. On the **Home** page, tap **All devices** > **Connected Single Socket Outlet**.
2. On the device control panel page, tap **Consumption**.
3. In the **Consumption** page, you can see the total energy consumption and it's changes in Week (A), Month (B), and Year (C) view in the graph.

You can tap each bar on the graph to see the total energy consumed on a particular day/month.

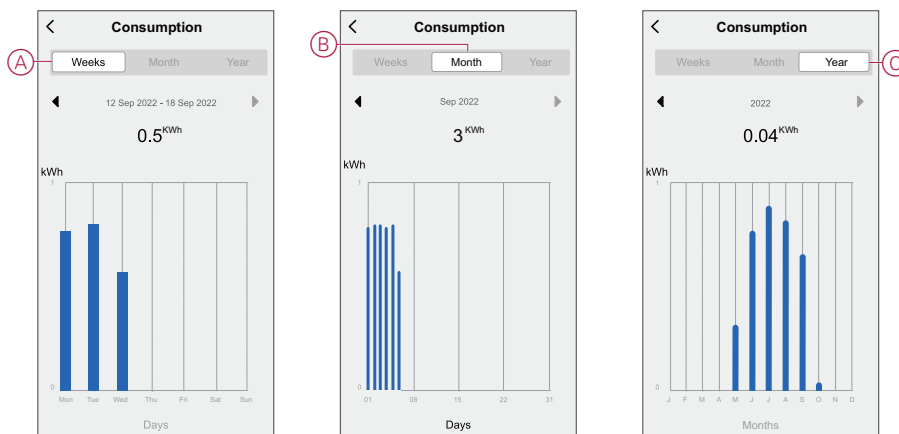

Selecting LED indicator mode

Using the Wiser app, you can select the LED indicator mode for easy identification of the device status.

To set the LED indicator modes:

1. On the **Home** page, tap **All devices > Connected Single Socket Outlet**.
2. On the device control panel page, tap **Settings**.
3. Tap **LED Indicator Mode (A)** and select any one of the following:
 - **Reverse With Load** - The LED on the Socket Outlet is On when the device is Off
 - **Consistent With Load** - The LED on the Socket Outlet is On when the device is On
 - **Always Off** - The LED on the Socket Outlet is always Off
 - **Always On** - The LED on the Socket Outlet is always On

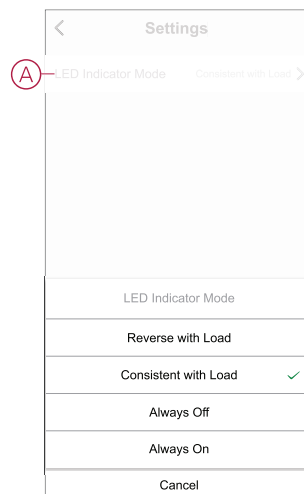

For information on LED color during each modes, refer to **LED Indication**, page 25.

Creating a moment

A Moment allows you to group multiple actions that are usually done together. Using the Wiser app, you can create moments based on your needs (such as movie night).

To create a moment:

1. On the **Home** page, tap .
2. Go to **Moment > +** to create a moment.

3. Tap **Edit name**, enter the name of the moment (A) and tap **Confirm**.

TIP: You can choose the cover image that represents your moment by tapping .

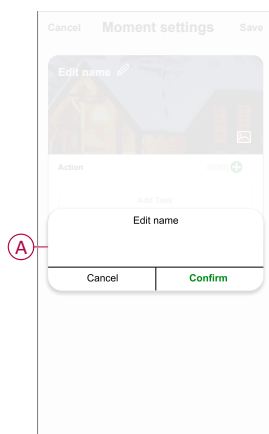

4. In the **Action** section, tap **Add task** (B) to open the slide-up menu.
5. In the **Add task** menu, you can do either or all of the following actions (C):
- **Run the device** - Select the devices that you want in a moment
 - **Select Automation** - Select the automation that you want to enable or disable. Refer to [Creating an automation](#), page 21
 - **Delay** - Set the delay time

NOTE: You can add one or more actions using .

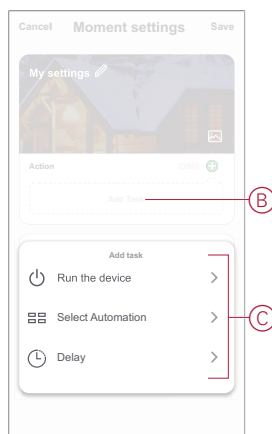

6. Tap **Run the device > Connected Single Socket Outlet > Socket** to select either or all of the functions to add in the moment:
 - **On** - Switch On the Socket Outlet (D)
 - **Off** - Switch Off the Socket Outlet (E)
 - **Reverse Switch** - Toggle the last state of the Socket Outlet (F)

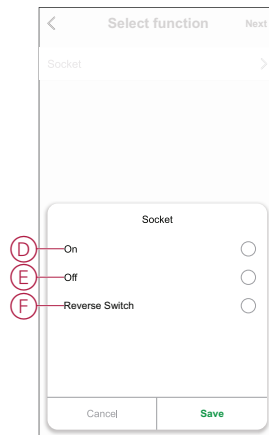

7. Once all the actions are set, tap **Save**.

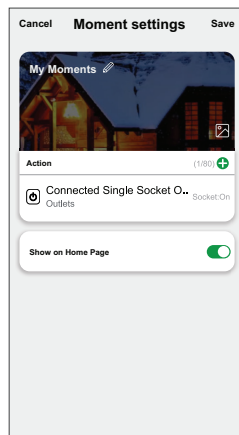

Editing a moment

1. On the **Moment** tab, locate the moment you want to edit and tap ●●●.
2. On the **Edit** page, you can tap each item (such as dimmer, shutter, delay, temperature, etc.) to change the settings.

TIP:

- You can add one or more actions using .
- To delete an existing action, slide each item towards left and tap **Delete**.

Deleting a moment

To delete a moment:

1. On the **Moment** tab, locate the moment that you want to delete and then tap ●●●.
2. Tap **Delete** and then tap **Ok**.

NOTE: After deleting a moment, the device action can no longer be triggered.

Creating an automation

An automation allows you to group multiple actions that are usually done together, triggered automatically or at scheduled times. By using the Wiserapp, you can create automations based on your needs.

To create an automation:

1. On the **Home** page, tap the .
2. Go to **Automation** > **+** to create an automation.
3. Tap **Edit name**, enter the name of the automation (A) and tap **Confirm**.

TIP: You can choose the cover image that represents your automation by tapping .

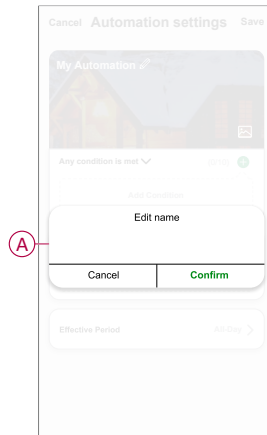

4. Tap **Any condition is met** to select any one of the condition type (B):
 - **All conditions are met** - The automation is triggered when all the conditions are met
 - **Any condition is met** - The automation is triggered when at least one condition is met

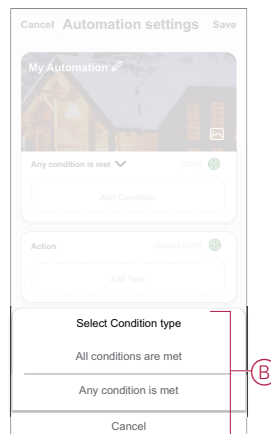

5. Tap **Add Condition** to open the slide-up menu.

6. In the **Add Condition** menu, you can do either or all of the following options (C):
- **When weather changes** - Select the various weather settings
 - **Schedule** - Set the time and day
 - **When device status changes** - Select the device and it's function

Note: You can add one or more conditions using .

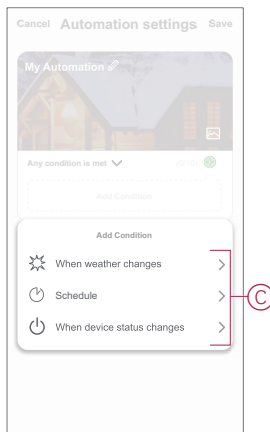

7. Tap **When device status changes** > **Connected Single Socket Outlet** and select either or all the functions:

- **Socket** - Turn On/Off the Socket Outlet (D)
- **Power (W)** - The real-time load value of the connected device (E)
- **Daily Consumption (kWh)** - The total energy consumption value daily (F)
- **Monthly Consumption (kWh)** - The total energy consumption value monthly (G)

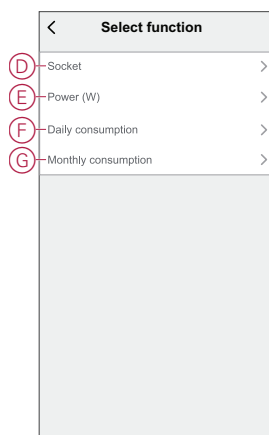

8. Tap **Add task** to open the slide-up menu.

9. In the **Add task** menu, you can do either or all of the following options (H):
- **Run the device** - Select the devices that you want to be triggered
 - **Moment or Automation** - Select the moment which you want to trigger or select the automation that you want to enable or disable
 - **Send notification** - Turn On notification for the automation
 - **Delay** - Set the delay time

NOTE: You can add one or more actions using .

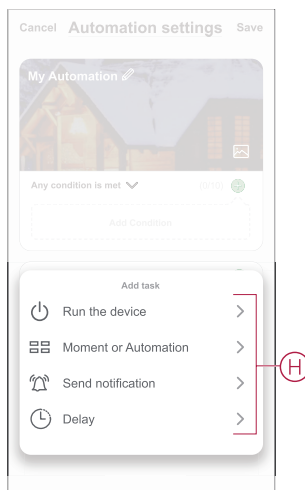

10. Tap on **Effective period** to set the time range for the automation. You can select any one of the following (I):
- **All-day** - 24 hours
 - **Daytime** - From sunrise to sunset
 - **Night** - From sunset to sunrise
 - **Custom** - User defined time period

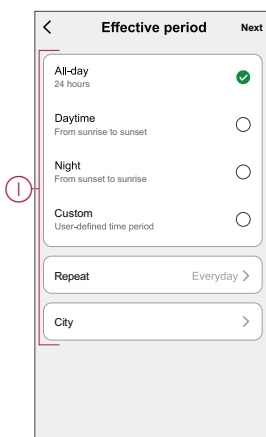

11. Once all the actions and conditions are set, tap **Save**.

Once the automation is saved, it is visible on the **Automation** tab. You can tap the toggle switch on the automation to enable it.

Example of an automation

This demonstration shows you how to create an automation to get notification on your app when the total energy consumption value of the Socket Outlet is 50 kWh.

1. Go to **Automation** > **+** to create an automation.

2. Tap **Edit name**, enter the name of the automation and tap **Confirm**.

TIP: You can choose the cover image that represents your automation by tapping .

3. Tap **Add Condition** > **When device status changes** > **Connected Single Socket Outlet**.

4. Tap **Daily Consumption**, select the total energy consumption value (A) and tap **Next**.

TIP: You can set the energy consumption value as 50 kWh.

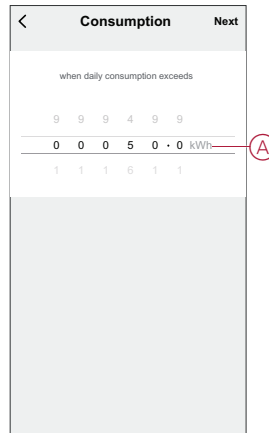

5. Tap **Add task** > **Send notification** and select **Notifications** (B).

6. Tap **Next**.

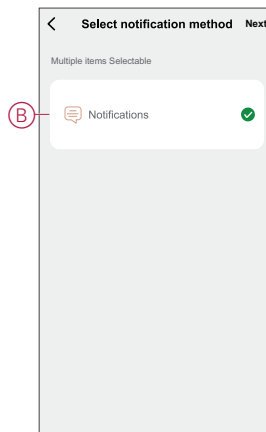

7. In the **Automation Settings** page, tap **Save**.

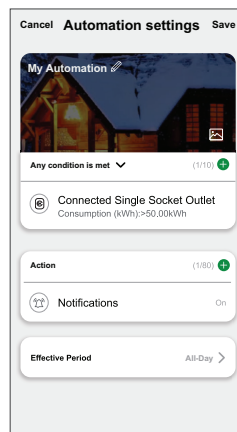

Once the automation is saved, it is visible on the **Automation** tab. You can tap the toggle switch on the automation to enable it.

Push notification will appear on the screen when the automation is triggered. You can also tap on  to access the notification history.

Editing an automation

1. On the **Automation** tab, locate the automation you want to edit and tap ●●●.
2. On the **Edit** page, you can tap each item (such as dimmer, shutter, delay, temperature, etc.) to change the settings.

TIP:

- You can add one or more condition or actions using .
- To delete an existing condition or action, slide each item towards left and tap **Delete**.



Deleting an automation

1. On the **Automation** tab, locate the automation that you want to delete and then tap ●●●.
2. Tap **Delete** and then tap **Ok**.



NOTE: After deleting an automation, the device action can no longer be triggered.

LED Indication





Pairing

User Action	LED Indication	Status
Press the push-button 3 times	LED blinks amber per second. 	Pairing mode is active for 30 seconds. When pairing is completed, LED glows green for some time before turning off. 

Resetting

User Action	LED Indication	Status
Press the push-button 3 times and hold it down once for > 10 s.	After 10 s, the LED blinks red. 	The device is in reset mode. It is reset to the factory settings after 10 seconds. The device then restarts and the LED blinks green for a few seconds and then stays amber. 



LED Indicator Mode/Backlight Mode

Load Status	ON	OFF
Reverse with load	No LED	
Consistent with load		No LED
Always Off	No LED	No LED
Always On		

Troubleshooting

Symptom	Possible cause	Solution
The Socket Outlet is not turning ON.	The Socket Outlet is broken or it could be an alarm if the LED blinks red.	Initially, turn off the socket outlet, disconnect it from the power supply and turn it on after some time. If it still not working, you can replace the socket outlet. For more information about the wiring refer to the installation instructions.
When there is an alarm, the user cannot switch ON the output locally or remotely. LED blinks fast RED.	Clear the Socket Outlet alarms.	To clear the alarm, press and hold the push button for 4 seconds. After 4 seconds, the blinking will stop and the alarm will be cleared. You can use the Socket Outlet again. NOTE: Before clearing the alarm, you must verify the reason for overcurrent fault and thermal fault.

Technical Data

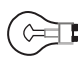
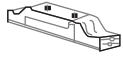
Nominal voltage	AC 230 V ~, 50 Hz		
Nominal power	Load type	Load name	Load value
	 LED	LED	100 W, 125 µF
	 M	Motor	1600 VA, max. 7 A
		Iron core transformer	1500 VA
		Incandescent lamp	2000 W
		Electronic step-down converter	2000 VA
	R	Ohmic load	3680 W
	C	Capacitive load	6 AX, max. 70 µF
	L	Inductive load	16 A, cosφ = 0.6
Standby	Maximum 0.4 W		
Fuse protection	16 A miniature circuit breaker		
Connecting terminals	Terminals for max. 2x 2.5 mm ²		
Operating frequency	2405 - 2480 MHz		
Max. radio-frequency power transmitted	< 10 mW		
IP rating	IP20		
Measuring accuracy	± 1% for loads > 25 W		
Communication protocol	Zigbee 3.0 certified		

Compliance

Product Environmental Data

Find and download comprehensive environmental data about your products, including RoHS compliance and REACH declarations as well as Product Environmental Profile (PEP), End-of-Life instructions (EOLi) and much more.

<https://www.se.com/myschneider>



General information about Schneider Environmental Data Program

Click the link below to read about Schneider Electric's Environmental Data Program.

<https://www.se.com/ww/en/about-us/sustainability/environmental-data-program/>



Trademarks

This guide makes reference to system and brand names that are trademarks of their relevant owners.

- Zigbee® is a registered trademark of the Connectivity Standards Alliance.
- Apple® and App Store® are brand names or registered trademarks of Apple Inc.
- Google Play™ Store and Android™ are brand names or registered trademarks of Google Inc.
- Wi-Fi® is a registered trademark of Wi-Fi Alliance®.
- Wiser™ is a trademark and the property of Schneider Electric, its subsidiaries and affiliated companies.
- Airzone is a trademark of Equip Outdoor Technologies UK Limited.
- Aidoo is a trademark of CORPORACIÓN EMPRESARIAL ALTRA S.L. company.

Other brands and registered trademarks are the property of their respective owners.

Schneider Electric
35 rue Joseph Monier
92500 Rueil Malmaison
France

+ 33 (0) 1 41 29 70 00

www.se.com

As standards, specifications, and design change from time to time, please ask for confirmation of the information given in this publication.

© 2021 – 2024 Schneider Electric. All rights reserved.

DUG_SysM/SysD_SSO_03