

Unica - Connected Blind Control Switch

Device user guide

Information about features and functionality of the devices
02/2024

IMPORTANT: Select your system to access the right user guide

If you have
Wiser Gateway
(CCT501901) and
Wiser app, continue
reading this
device user guide.

Wiser by SE System

WiFer

Schneider
Electric

Wiser app



CCT501901
Wiser Gateway

If you have
Wiser Hub/HubR
2nd Generation
(CCT501801 or
CCTFR6311G2) and
Wiser Home app, then
click here 

Wiser Home System

WiFer

Schneider
Electric

Wiser Home app



CCT501801
Wiser Hub
2nd Generation



CCTFR6311G2
Wiser HubR
2nd Generation

Legal Information

The information provided in this document contains general descriptions, technical characteristics and/or recommendations related to products/solutions.

This document is not intended as a substitute for a detailed study or operational and site-specific development or schematic plan. It is not to be used for determining suitability or reliability of the products/solutions for specific user applications. It is the duty of any such user to perform or have any professional expert of its choice (integrator, specifier or the like) perform the appropriate and comprehensive risk analysis, evaluation and testing of the products/solutions with respect to the relevant specific application or use thereof.

The Schneider Electric brand and any trademarks of Schneider Electric SE and its subsidiaries referred to in this document are the property of Schneider Electric SE or its subsidiaries. All other brands may be trademarks of their respective owner.

This document and its content are protected under applicable copyright laws and provided for informative use only. No part of this document may be reproduced or transmitted in any form or by any means (electronic, mechanical, photocopying, recording, or otherwise), for any purpose, without the prior written permission of Schneider Electric.

Schneider Electric does not grant any right or license for commercial use of the document or its content, except for a non-exclusive and personal license to consult it on an "as is" basis.

Schneider Electric reserves the right to make changes or updates with respect to or in the content of this document or the format thereof, at any time without notice.

To the extent permitted by applicable law, no responsibility or liability is assumed by Schneider Electric and its subsidiaries for any errors or omissions in the informational content of this document, as well as any non-intended use or misuse of the content thereof.

Table of Contents

Safety information	4
Unica - Connected Blind Control Switch	5
For your safety	5
About the device.....	5
Installing the device	6
Pairing the device	6
Pairing device manually.....	6
Pairing device with auto scan	9
Configuring the device	10
Changing the device icon	10
Renaming the device	11
Changing the device location	11
Calibration.....	12
Removing the device	14
Resetting the device	14
Using the device	15
Operating the device manually.....	16
Operating the device using app.....	16
Creating a schedule	17
Creating a moment	18
Creating an automation	20
LED Indication.....	24
Troubleshooting	24
Technical Data	25
Compliance	26
Compliance information for Green Premium products.....	26
Trademarks.....	26

Safety information

Important information

Read these instructions carefully and look at the equipment to become familiar with the device before trying to install, operate, service, or maintain it. The following special messages may appear throughout this manual or on the equipment to warn of potential hazards or to call attention to information that clarifies or simplifies a procedure.



The addition of either symbol to a “Danger” or “Warning” safety label indicates that an electrical hazard exists which will result in personal injury if the instructions are not followed.



This is the safety alert symbol. It is used to alert you to potential personal injury hazards. Obey all safety messages that accompany this symbol to avoid possible injury or death.

DANGER

DANGER indicates a hazardous situation which, if not avoided, **will result in** death or serious injury.

Failure to follow these instructions will result in death or serious injury.

WARNING

WARNING indicates a hazardous situation which, if not avoided, **could result in** death or serious injury.

CAUTION

CAUTION indicates a hazardous situation which, if not avoided, **could result in** minor or moderate injury.

NOTICE

NOTICE is used to address practices not related to physical injury.

Unica - Connected Blind Control Switch

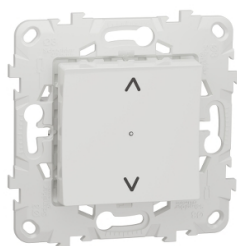

NU5509xx



NU3509xx

For your safety

⚡⚠ DANGER

HAZARD OF ELECTRIC SHOCK, EXPLOSION, OR ARC FLASH

Safe electrical installation must be carried out only by qualified electrical personnel. Qualified electrical personnel must prove profound knowledge in the following areas:

- Connecting to installation networks
- Connecting several electrical devices
- Laying electrical cables
- Safety standards, local wiring rules, and regulations

Failure to follow these instructions will result in death or serious injury.

About the device

You can use the Connected Blind Control Switch (hereinafter referred to as **blind control switch**) to control one blind or roller shutter motor that is equipped with an end position switch.

Control options

Home control using Wiser Home app: To control the blind control switch through the Wiser app you will need the Wiser Gateway. Refer to [Pairing the device](#), page .

Direct operation: The blind control switch can always be controlled directly on-site. You can also connect it with mechanical double push-buttons. Refer to Manual operation, page 16.

Functions

- Protection of the motor against damage.
- Operating with extension units (mechanical double push-button).

Installing the device

Refer to the installation instruction supplied with this product.

See Connected Blind Control Switch

Pairing the device

Using the Wiser app, pair your device with the **Gateway/Hub** to access and control the device. You can either add the device manually or do an auto-scan to pair it.

Pairing device manually

To pair the device manually:

1. On **Home** page, tap **+**.
2. Tap  and select the **Wiser Hub**.
3. Select an option to add the device (A):
 - **Add Device with Install Code**
 - **Add Device without Install Code**

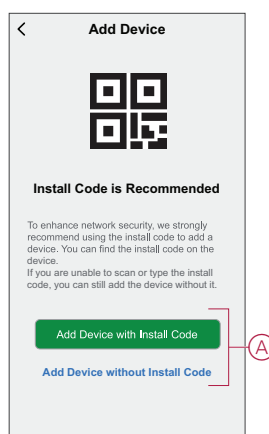

TIP: It is highly recommended to add the device with install code.

4. To pair the device with install code, tap **Add Device with Install Code** to display the slide-up menu. Select any one of the options (B):
 - **Scan Install Code** - you can scan the device for the install code
 - **Enter Install Code Manually** - you can manually enter the install code from the device

After pairing the device with install code, proceed to **Step 6**.

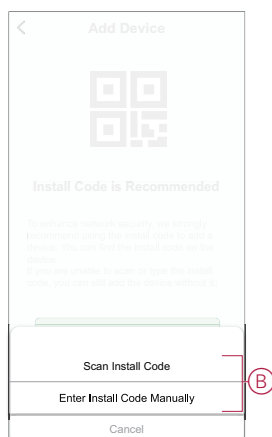

5. To pair the device without install code, tap **Add Device without Install Code**.
6. Short press the UP/OPEN (^) push button 3 times (< 0,5 s).

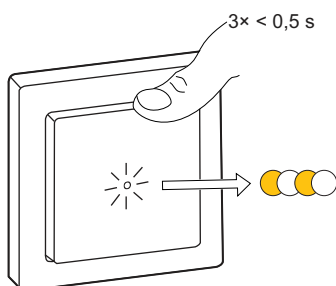

The LED blinks amber.

7. In the app, select **Confirm LED is blinking amber** and tap **Start configuration (C)**.

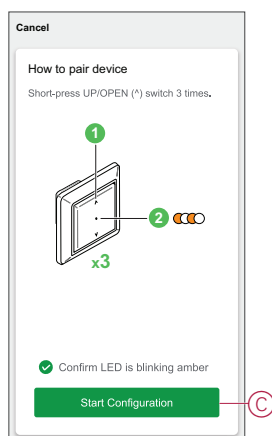

The app displays the progress of connecting the device.

8. After a few seconds, a solid green LED indicates that the device is successfully paired to the **Gateway/Hub**.

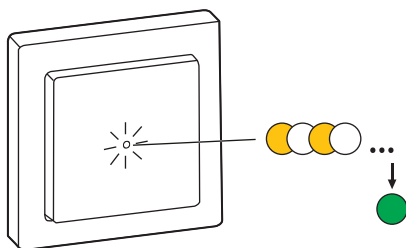

9. After the device is added in the app, tap **Done**.

Pairing device with auto scan

Pairing the device with auto scan automatically discovers the device when the corresponding device is powered on.

To pair the device:

1. On the **Home** page, tap **+**.
2. Tap **Auto scan** and tap **Confirm**.
3. If you have multiple hubs, do Step 4 or proceed to Step 5.
4. Tap **Select hub** and select the Wiser hub from the slide-up menu.
5. Short press the UP/OPEN (^) push button 3 times (< 0,5 s).

NOTE:

- The LED blinks amber.
- Wait for a few seconds until the device search is complete.

6. Tap **Next** (A) and select **Blind Control Switch**.

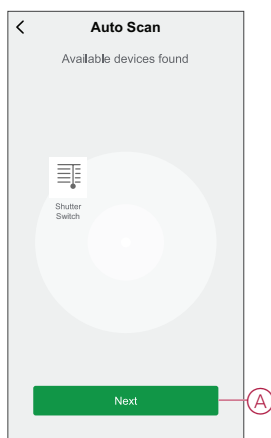



7. Once the device is added successfully, tap **Done**.

Configuring the device

Changing the device icon

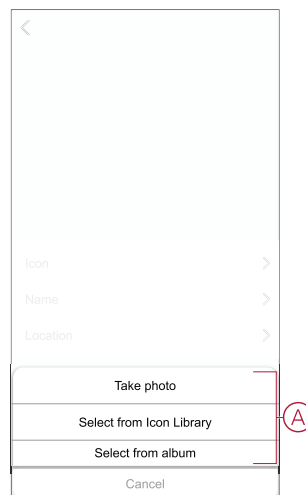

You can change the device icon using the Wiser app.

1. On the **Home** page, select the device for which you wish to change the icon.
2. At the top-right corner of the screen, tap .
3. Tap edit  next to the device name.
4. Tap **Icon** to view the menu.
5. In the slide-up menu, select any one of the following (A) to change the device icon:
 - **Take photo** - allows you to click a photo from the mobile camera.
 - **Select from Icon Library** - allows you to select an icon from the app library.
 - **Select from Album** - allows you to select a photo from the mobile gallery.



Renaming the device

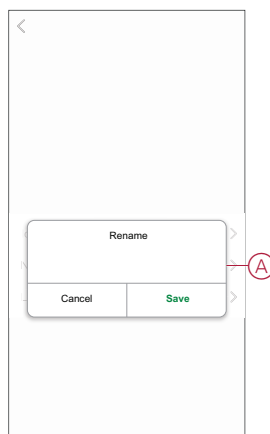

You can rename the device using the Wiser app.

1. On the **Home** page, select the device for which you wish to rename.
2. At the top-right corner of the screen, tap .
3. Tap edit  next to the device name.
4. Tap **Name**, enter the new name (A) and then tap **Save**.



Changing the device location

You can change the device location using the Wiser app.

1. On the **Home** page, select the device for which you wish to change the location.
2. At the top-right corner of the screen, tap .
3. Tap edit  next to the device name.
4. Tap **Location**.
5. Select the desired location from the list (A) and then tap **Save**.

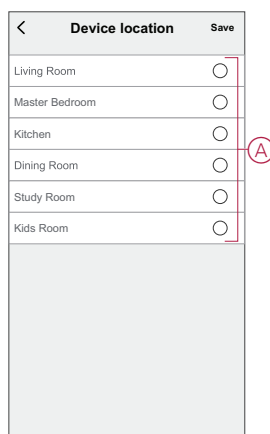

Calibration

The shutter control is supplied in an uncalibrated state. Each shutter motors vary in the speed at which they open and close (edge to edge). Therefore, the opening/closing time of the shutter must be determined in the app.

NOTE:

- Before using this device for the first time, it must be calibrated, or you can adjust its duration manually.
- Do not use the shutter either manually or on the app during calibration to avoid interruption.

Shutter calibrating

To calibrate run time:

1. On the device control panel page, tap **Settings > Open/Close Duration**.
2. On slide-up menu, you can set the run time manually using **+/-** button or using the sliding bar (A) and then tap **Confirm**.

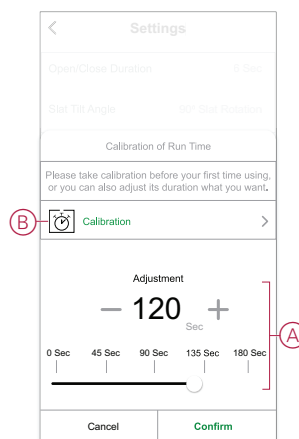

NOTE: To determine the default run time manually, record the time it takes to fully open/close the shutter (edge to edge).

3. To calibrate, tap **Calibration** (B).
4. On the slide-up menu, select the calibration start point:
 - **Start From The Top**: shutter will move from top to bottom (closing).
 - **Start From the Bottom**: shutter will move from bottom to top (opening).
5. Wait until the shutter reaches its starting point and then tap **Start**.
6. Tap **Done** once the shutter reaches other end.
The app displays the progress of calibration.
7. Once the process is complete, tap **Tilt Calibration** on the pop-up window for **Slat Tilt Angle**.

Slat tilt angle calibration

To calibrate slat tilt angle:

1. On the setting page, tap **Slat Tilt Angle** for slide-up menu.
2. Select tilt type (A) based on the motor installed and then tap **Confirm**

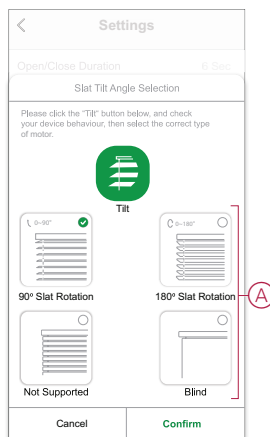

NOTE: If the shutter is installed with a non rotating slat or blind, the calibration process is complete, and no further steps to follow.

3. Read the pop-up notification and tap **Confirm** for slide-up menu.
4. Make sure the shutter is in fully closed state and tap **Prepare**.
5. Select the check box (B) and tap **Start**.

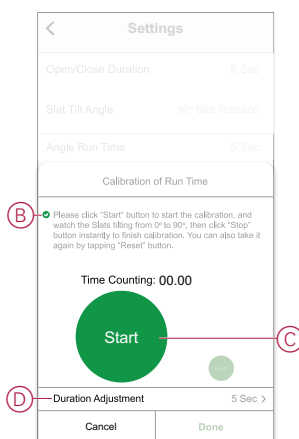

6. Tap **Stop** (C) to finish calibration.

TIP: You can retake the calibration by tapping **Reset**.

7. Tap **Done** once the process is complete.
The app displays the progress of calibration.

TIP: You can set the run time manually by tapping **Duration Adjustment** (D).

Removing the device

Using the Wiser app, you can remove a device from the device list.
To remove the device:

1. On the **Home** page, tap **All devices** > **Blind Control Switch**.
2. Tap  to display more details.
3. Tap **Remove and Factory Reset Device** (A).

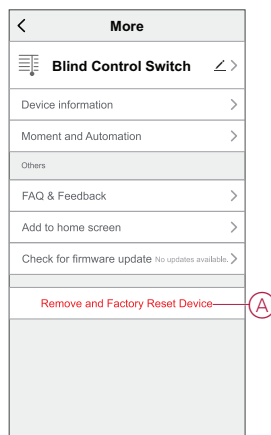

TIP: Alternatively, you can long tap on the **Blind Control Switch** on the **Home** page to remove the device.

NOTE: By removing the device, you will reset the device. If you still have a problem with the reset, then refer to [reset the device](#), page 14.

Resetting the device

You can reset the device to factory default manually.

Short-press the push button three times (<0.5 s) and then long-press the push button once (>10 s).

The LED blinks red after 10 s, and then release the push button.

Upon successful reset, the LED stops blinking. Then, the device restarts and blinks green for a few seconds.

NOTE: After reset, the LED turns amber indicating that it is ready for pairing.

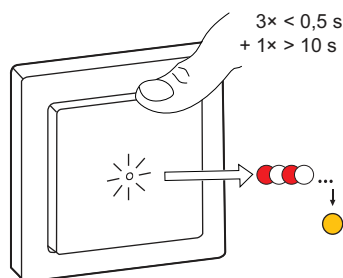

Using the device

The Control Panel allows you to open/close, increase/decrease the height of shade and control various settings.

On the **Home** page, tap **All devices** > **Blind Control Switch** to access the control panel.

On the control panel page, you can see the following:

- The current state of the device (A)
- Control button (B)
- Slat position control (C)
- Schedule, page 17 (D)
- Settings, page (E)

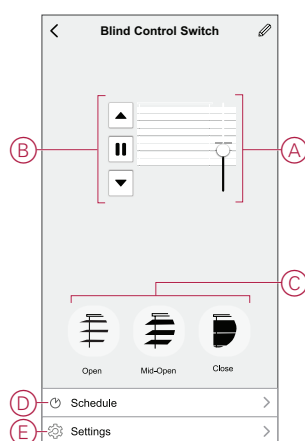

Operating the device manually

You can operate the blind control manually using the blind control switch.

- Long press the blind control switch ($> 0,5$ s) to move the blind up or down (A).
 - Press (Λ) to open the blind.
 - Press (v) to close the blind.
- **Shutter:** Short press ($< 0,5$ s) to stop the moving blind (B).
- **Shutter with tilting slats:** Short press ($< 0,5$ s) to adjust the slat position (C).

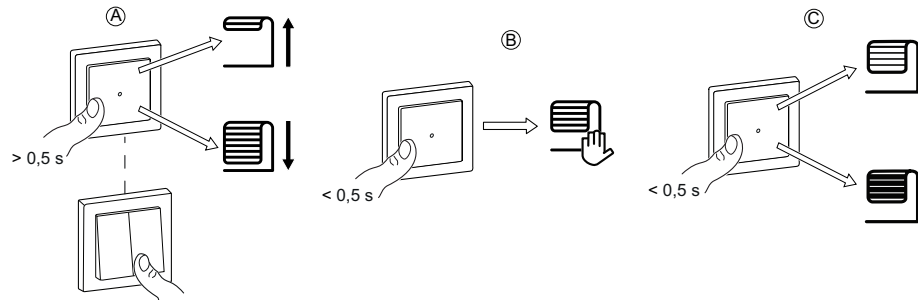

Operating the device using app

By using the Wiser app, you can open\close the blind.
To operate the device.

1. On the **Home** page, Tap **All devices**.
2. In **Blind Control Switch** Tap on **▼**.
3. On the slide up Control menu select **Open/Close** to operate the shutter.

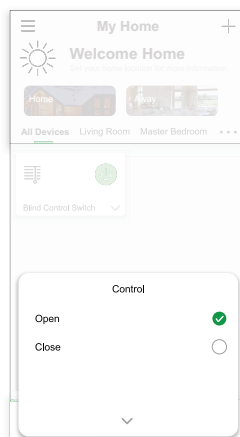

4. Alternatively, you can navigate to the control panel, page 15 of the device to preform the operation.

NOTE: The control panel shows the current state of the device.

Creating a schedule

The devices can be fully controlled by schedule. Once the schedule is set, the devices operate at a given time.

To create a schedule:

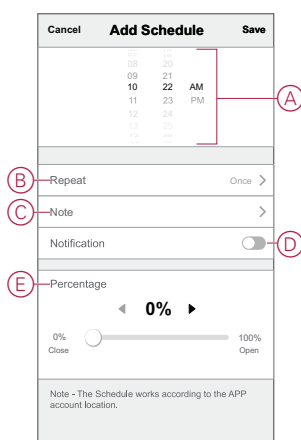

1. On the **Home** page, Tap **All devices** > **Blind Control Switch**.
2. Tap **Schedule** > **Add Schedule** to add a schedule.
3. In **Add Schedule** menu, set the time (A).
4. Tap **Repeat** (B) to select the days you want to set the schedule.
5. Tap **Note** (C), enter the note and tap **Confirm**.
6. Tap the toggle switch (D) to turn On the **Notification** for the schedule. The app will send a notification that the scheduled task is executed at the time of schedule.
7. Tap **Control** (E) and select any one option, **Shutter Open / Shutter Close**.



8. Tap **Save**

Creating a moment

A Moment allows you to group multiple actions that are usually done together. Using the Wiser app, you can create moments based on your needs. To create a moment:

1. On the **Home** page, tap .
2. Go to **Moment** > **+** to create a moment.
3. Tap **Edit name** , enter the name of the moment (A) and tap **Save**.
TIP: You can choose the cover image that represents your moment by tapping .

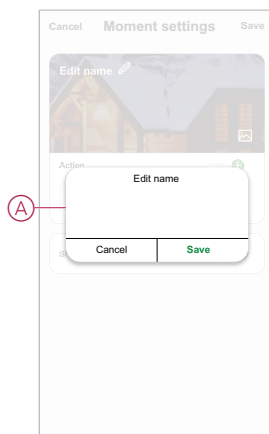

4. In the **Action** section, tap **Add task** (B) to open the slide-up menu.
5. In the **Add task** menu, you can do either or all of the following actions (C):
 - **Run the device** - Select the devices that you want in a moment.
 - **Select Automation** - Select the automation that you want to enable or disable.
 - **Delay** - Set the delay time.

NOTE: You can add one or more actions using .

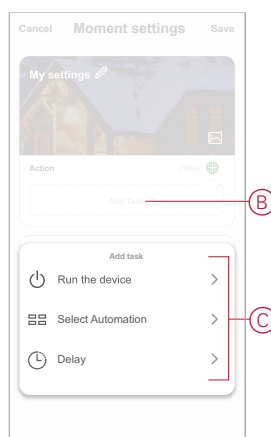

6. Tap **Run the device** > **Blind Control Switch** to select either or all the functions to add in the moment:
 - **Control** > **Shutter Open / Shutter Close** (D).
 - **Percentage** > Set the **percentage** (E) of moment required.

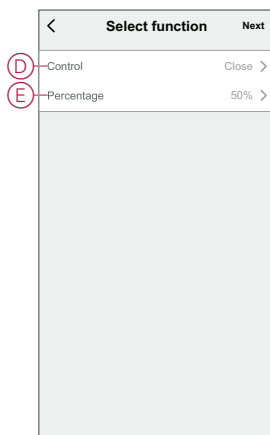

7. Once all the actions are set, tap **Save**.

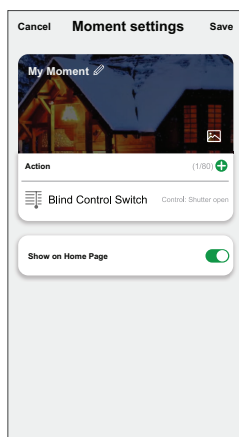

Editing a moment

To edit a moment:

1. On the **Moment** tab, locate the moment you want to edit and tap **⋮**.
2. On the **Edit** page, you can tap each item (such as dimmer, shutter, delay, temperature, etc.) to change the settings.

TIP:

- You can add one or more actions using **+**.
- To delete an existing action, slide the each item towards left and tap **Delete**.

Deleting a moment

To delete a moment:



1. On the **Moment** tab, locate the moment that you want to delete and then tap **⋮**.
2. Tap **Delete** and tap **Ok**.

NOTE: After deleting a moment, the device action can no longer be triggered.

Creating an automation

An automation allows you to group multiple actions that are usually done together, triggered automatically or at scheduled times. By using the Wiser app, you can create automations based on your needs.

To create an automation:

1. On the **Home** page, tap the .
2. Go to **Automation** > **+** to create an automation.
3. Tap **Edit name** , enter the name of the automation (A) and tap **Save**.
TIP: You can choose the cover image that represents your automation by tapping .

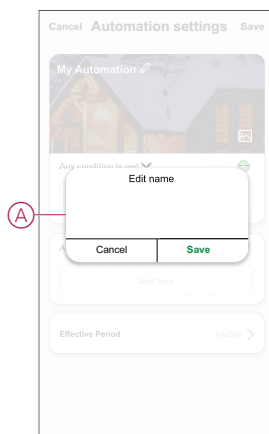

4. Tap **Any condition is met** to select any one of the condition type (B):
 - **All conditions are met** - The automation is triggered when all the conditions are met.
 - **Any condition is met** - The automation is triggered when at least one condition is met.

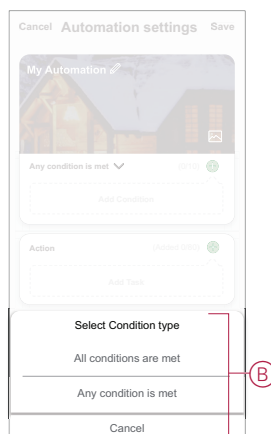

5. Tap **Add Condition** to open the slide-up menu.

6. In the **Add Condition** menu, you can do either or all of the following options (C):

- **When weather changes** - Select the various weather settings.
- **Schedule** - Set the time and day.
- **When device status changes** - Select the device and it's function.

Note: You can add one or more conditions using .

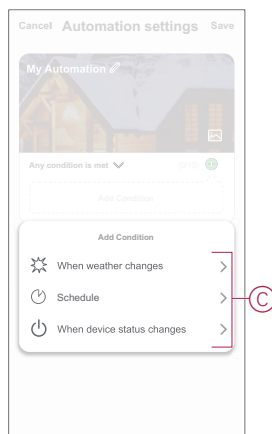

7. Tap **When device status changes > Blind Control Switch > Percentage** and update the percentage of closing and opening of shutter.

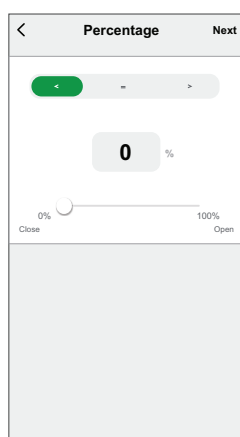

8. Tap **Add task** to open the slide-up menu.

9. In the **Add task** menu, you can do either or all of the following options (D):
- **Run the device** - Select the devices that you want to be triggered.
 - **Moment or Automation** - Select the moment which you want to trigger or select the automation that you want to enable or disable.
 - **Send notification** - Turn on notification for the automation.
 - **Delay** - Set the delay time.

NOTE: You can add one or more actions using .

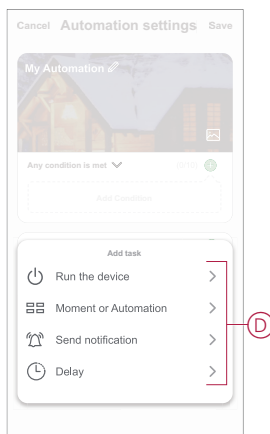

10. Tap on **Effective period** to set the time range for the automation. You can select any one of the following (E):
- **All-day** - 24 hours
 - **Daytime** - From sunrise to sunset
 - **Night** - From sunset to sunrise
 - **Custom** - User defined time period

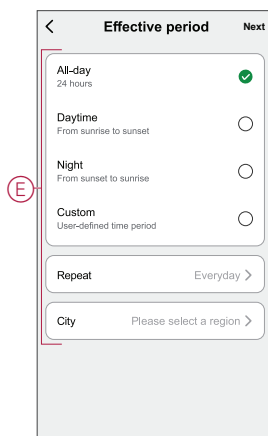

11. Once all the actions and conditions are set, tap **Save**.

Once the automation is saved, it is visible on the **Automation** tab. You can tap the toggle switch on the automation to enable it.

Example of an automation

This demonstration shows you how to create an automation to open the shutter at the scheduled time.

1. Go to **Automation** > **+** to create an automation.

2. Tap **Edit name** , enter the name of the automation and tap **Save**.

TIP: You can choose the cover image that represents your automation by tapping .

3. Tap **Add Condition > Schedule**.

- Tap **Repeat** (A), select the days you want to set the schedule and tap **Save**.
- Set the time (B) at which the automation must start and tap **Next**.

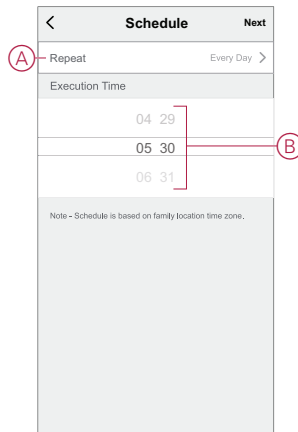
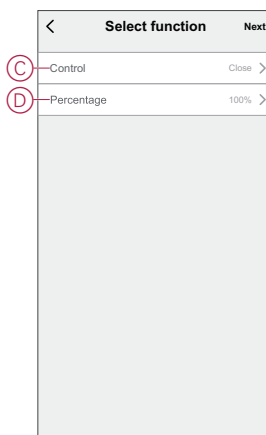
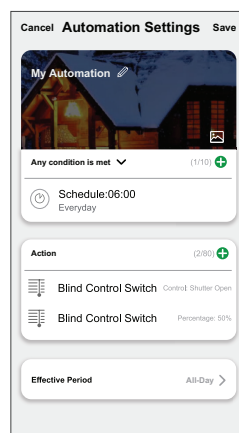
4. Tap **Add task > Run the device > Blind Control Switch**.5. Tap **Control > Shutter Open** (C) and tap **Save**.6. Tap **Percentage** (D) to update the percentage of shutter opening and tap **Save**.7. Tap **Next**.8. In the **Automation Settings** page, tap **Save**.

Once the automation is saved, it is visible on the **Automation** tab. You can tap the toggle switch on the automation to enable it.

Editing an automation

To edit an automation:

1. On the **Automation** tab, locate the automation you want to edit and tap **...**.
2. On the **Edit** page, you can tap each item (such as dimmer, shutter, delay, temperature, etc.) to change the settings.

TIP:

- You can add one or more actions using .
- To delete an existing condition or action, slide each item towards left and tap **Delete**.

Deleting an automation



To delete an automation:

1. On the **Automation** tab, locate the automation that you want to delete and then tap **...**.
2. Tap **Delete** and tap **Ok**.



NOTE: After deleting an automation, the device action can no longer be triggered.

LED Indication

Pairing

User Action	LED Indication	Status
Press the push button 3 times	LED blinks amber per second. 	Pairing mode is active for 30 seconds. When pairing is completed, LED glows green for some time before turning Off. 

Resetting

User Action	LED Indication	Status
Press the push button 3 times and hold it down once for > 10 s.	After 10 s, the LED blinks red. 	The device is in reset mode. It is reset to the factory settings after 10 seconds. The device then restarts and the LED blinks green for a few seconds and then stays amber. 

Troubleshooting

Symptom	Solution
Connected blinds cannot be controlled.	<ul style="list-style-type: none"> • Check power supply. • Remove power to the blinds control switch and then re-connect power again. • Check the load. • In the case of an external push button, check the wiring. • Re-couple devices.
Blinds is not driving to the desired position.	Reset to factory default settings, refer to Resetting the device , page 14

Technical Data

Nominal voltage	AC 230 V, 50 Hz		
Nominal power	Load type	Load name	Load value
		Motor	500 W
Standby	Maximum 0.4 W		
Connecting Terminals	Screw terminals for max. 2 x 2.5 mm ² , 0.5 Nm		
Extension unit	Mechanical Double push-buttons, unlimited number, max. 50 m		
Fuse protection	10 A circuit breaker		
Nominal current	4 A, $\cos\varphi = 0.6$		
Operating frequency	2405 - 2480 MHz		
Max. radio-frequency power transmitted	< 10 mW		
Communication protocol	Zigbee 3.0 certified		

Compliance

Compliance information for Green Premium products

Find and download comprehensive information about Green Premium products, including RoHS compliance and REACH declarations as well as Product Environmental Profile (PEP) and End-of-Life instructions (EOLI).

General information about Green Premium products

Click the link below to read about Schneider Electric's Green Premium product strategy.

<https://www.schneider-electric.com/en/work/support/green-premium/>

Find compliance information for a Green Premium product

Click the link below to search for a product's compliance information (RoHS, REACH, PEP and EOLI).

NOTE: You will need the product reference number or product range to perform the search.

<https://www.reach.schneider-electric.com/CheckProduct.aspx?cskey=ot7n66yt63o1xblflyfj>

Trademarks

This guide makes reference to system and brand names that are trademarks of their relevant owners.

- Zigbee® is a registered trademark of the Connectivity Standards Alliance.
- Apple® and App Store® are brand names or registered trademarks of Apple Inc.
- Google Play™ Store and Android™ are brand names or registered trademarks of Google Inc.
- Wi-Fi® is a registered trademark of Wi-Fi Alliance®.
- Wiser™ is a trademark and the property of Schneider Electric, its subsidiaries and affiliated companies.

Other brands and registered trademarks are the property of their respective owners.

Schneider Electric
35 rue Joseph Monier
92500 Rueil Malmaison
France

+ 33 (0) 1 41 29 70 00

www.se.com

As standards, specifications, and design change from time to time,
please ask for confirmation of the information given in this publication.

© 2022 – 2024 Schneider Electric. All rights reserved.

DUG_Unica Blind Control_WSE-02