

Unica - Connected Motion Sensor with Dimmer LED

Device user guide

11/2022

Information about features and functionality of the devices

Legal Information

The Schneider Electric brand and any trademarks of Schneider Electric SE and its subsidiaries referred to in this guide are the property of Schneider Electric SE or its subsidiaries. All other brands may be trademarks of their respective owners.

This guide and its content are protected under applicable copyright laws and furnished for informational use only. No part of this guide may be reproduced or transmitted in any form or by any means (electronic, mechanical, photocopying, recording, or otherwise), for any purpose, without the prior written permission of Schneider Electric.

Schneider Electric does not grant any right or license for commercial use of the guide or its content, except for a non-exclusive and personal license to consult it on an "as is" basis. Schneider Electric products and equipment should be installed, operated, serviced, and maintained only by qualified personnel.

As standards, specifications, and designs change from time to time, information contained in this guide may be subject to change without notice.

To the extent permitted by applicable law, no responsibility or liability is assumed by Schneider Electric and its subsidiaries for any errors or omissions in the informational content of this material or consequences arising out of or resulting from the use of the information contained herein.

Table of Contents

Safety information	4
Unica - Connected Motion Sensor with Dimmer LED	5
For your safety	5
About the device	6
Installing the device	6
Pairing the device	6
Pairing device manually	6
Pairing device with auto scan	8
Configuring the device	9
Changing the device icon	9
Renaming the device	10
Changing the device location	10
Removing the device	10
Resetting the device	11
Using the device	11
Switching/Dimming the device manually	13
Switching/Dimming the device using app	13
Creating a schedule	14
Managing motion sensor dimmer settings	15
Creating a moment	19
Creating an automation	21
LED Indication	26
Troubleshooting	26
Technical Data	26

Safety information

Important information

Read these instructions carefully and look at the equipment to become familiar with the device before trying to install, operate, service, or maintain it. The following special messages may appear throughout this manual or on the equipment to warn of potential hazards or to call attention to information that clarifies or simplifies a procedure.



The addition of either symbol to a “Danger” or “Warning” safety label indicates that an electrical hazard exists which will result in personal injury if the instructions are not followed.



This is the safety alert symbol. It is used to alert you to potential personal injury hazards. Obey all safety messages that accompany this symbol to avoid possible injury or death.

DANGER

DANGER indicates a hazardous situation which, if not avoided, **will result in** death or serious injury.

Failure to follow these instructions will result in death or serious injury.

WARNING

WARNING indicates a hazardous situation which, if not avoided, **could result in** death or serious injury.

CAUTION

CAUTION indicates a hazardous situation which, if not avoided, **could result in** minor or moderate injury.

NOTICE

NOTICE is used to address practices not related to physical injury.

Unica - Connected Motion Sensor with Dimmer LED

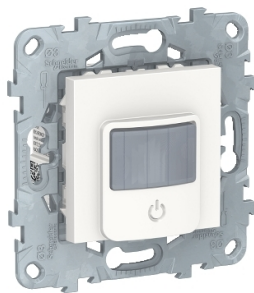

NU5527xx



NU3527xx

For your safety

⚠ DANGER

HAZARD OF ELECTRIC SHOCK, EXPLOSION, OR ARC FLASH

Safe electrical installation must be carried out only by skilled professionals. Skilled professionals must prove profound knowledge in the following areas:

- Connecting to installation networks.
- Connecting several electrical devices.
- Laying electric cables.
- Safety standards, local wiring rules and regulations.

Failure to follow these instructions will result in death or serious injury.

⚠ DANGER

RISK OF FATAL INJURY FROM ELECTRIC SHOCK

The output may carry electric current even when the load is switched Off.

Disconnect the device from the supply by means of the fuse in the incoming circuit before working on the device.

Failure to follow these instructions will result in death or serious injury.

⚠ CAUTION

THE DEVICE MAY BE DAMAGED

Only connect dimmable load.

Failure to follow these instructions can result in injury or equipment damage.

About the device

The Connected Motion Sensor with Dimmer LED (hereinafter referred to as Motion sensor dimmer) detects moving heat sources (e.g. persons) and can dim ohmic, inductive or capacitive loads and switch them on for a settable overtravel time.

Control options

Home control: To control the motion sensor through the Wiser app you will need the Wiser Gateway.

Direct operation: The motion sensor can always be controlled directly on-site. You can also connect any number of mechanical push-buttons.

Functions

- Detection range
- Automatic load detection
- Automatic mode, manual operation.

Installing the device

Refer to the installation instruction supplied with this product.

See [Connected Motion Sensor with Dimmer LED](#).

Pairing the device

Using the Wiser app, pair your device with the **Gateway/Hub** to access and control the device. You can either add the device manually or do an auto-scan to pair it.

Pairing device manually

To pair the device manually:

1. On **Home** page, tap **+**.
2. Tap  and select the required **Wiser Hub** on the slide-up menu.

3. Select an option to add the device (A):

- **Add Device with Install Code**
- **Add Device without Install Code**

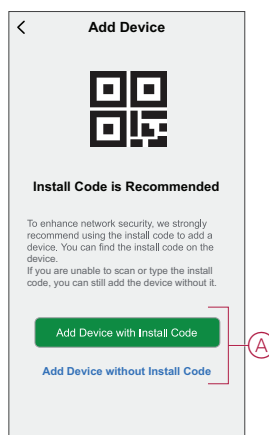

TIP: It is highly recommended to add the device with install code.

4. To pair the device with an install code, tap **Add Device with Install Code** to display the slide-up menu. Select any one of the options (B):

- **Scan Install Code** - you can scan the device for the install code.
- **Enter Install Code Manually** - you can manually enter the install code from the device.

After pairing the device with install code, proceed to **Step 6**.

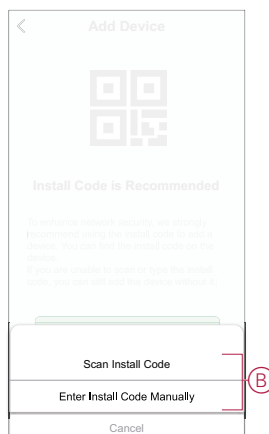

5. To pair the device without install code, tap **Add Device without Install Code**.

6. Short press the push button 3 times ($< 0,5$ s).

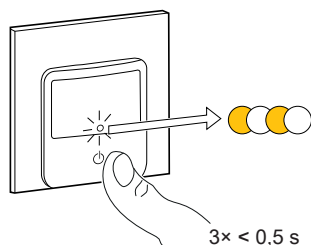

The LED blinks amber.

7. In the app, select **Confirm LED is blinking amber** and tap **Start configuration (C)**.

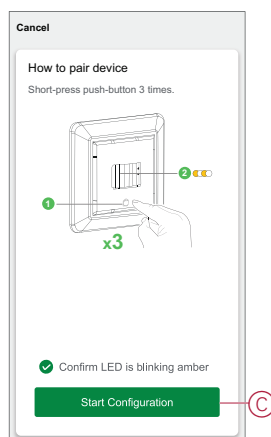

The app displays the progress of connecting the device.

8. After a few seconds, a solid green LED indicates that the device is successfully paired to the Gateway/Hub.

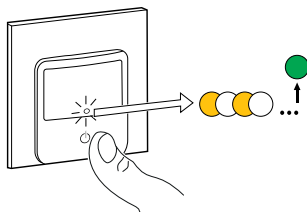

9. Tap **Done** when the pairing is successful.

Pairing device with auto scan

Pairing the device with auto scan automatically discovers the device when the corresponding device is powered on.
To pair the device:

1. On the **Home** page, tap **+**.
2. Tap **Auto scan** and then tap **Confirm**.
3. If you have multiple hubs, do Step 4 or proceed to Step 5.
4. Tap **Select hub** and select the Wiser hub from the slide-up menu.
5. Short press the push button 3 times (< 0,5 s).

NOTE:

- The LED blinks amber.
- Wait for a few seconds until the device search is complete.

TIP: If you want to pair multiple devices at once, perform step 5 on each device and wait for a few seconds.

6. Tap **Next** (A) and select **Motion Sensor Dimmer**.

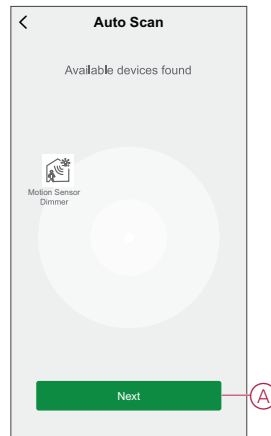



7. Tap **Done** when the pairing is successful.

Configuring the device

Changing the device icon

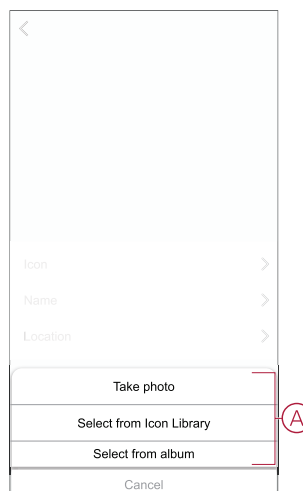

You can change the device icon using the Wisir app.

1. On the Home page, select and tap the device you wish to change the icon.
2. At the top right corner of the device screen, tap .
3. Tap edit  next to the device name.
4. Tap **Icon** to view the menu.
5. In the slide-up menu, select any one of the following (A) to change the device icon:
 - **Take photo** - allows you to click a photo from the mobile camera.
 - **Select from Icon Library** - allows you to select an icon from the app library.
 - **Select from Album** - allows you to select a photo from the mobile gallery.



Renaming the device

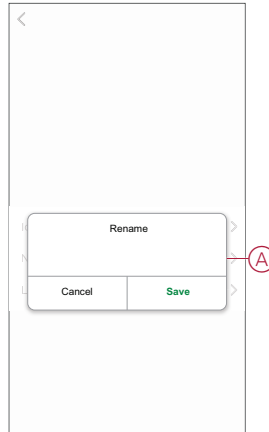

You can rename the device using the Wiser app.

1. On the Home page, select and tap the device you wish to rename.
2. At the top right corner of the device screen, tap .
3. Tap edit  next to the device name.
4. Tap **Name**, enter the new name (A) and then tap **Save**.



Changing the device location

You can change the device location using the Wiser app.

1. On the Home page, select and tap the device you wish to change the location.
2. At the top right corner of the device screen, tap .
3. Tap edit  next to the device name.
4. Tap **Location**.
5. Select the desired location from the list (A) and then tap **Save**.

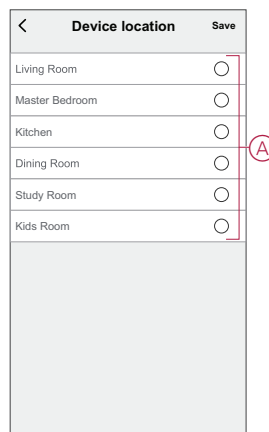

Removing the device

Using the Wiser app, you can remove a device from the device list.
To remove the device:

1. On the **Home** page, tap **All devices > Motion Sensor Dimmer**.
2. Tap  to display more details.
3. Tap **Remove and Factory Reset Device (A)**.

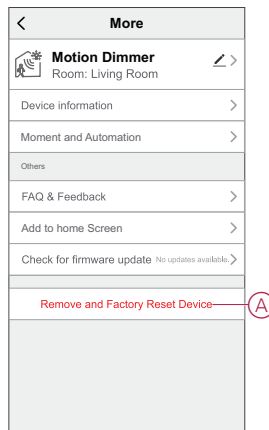

TIP: On the home page, you can tap and hold the **Motion Sensor Dimmer** to remove the device.

NOTE: By removing the device, you will reset the device. If you still have a problem with the reset, then refer to [resetting the device](#), page 11.

Resetting the device

You can reset the device to factory default manually.
To reset the device:

Short press push button 3 times (< 0.5 s) and then long press the push button once (> 10 s), LED starts blinking red then release the push button. The LED stops blinking upon successful reset of the device. The Motion Sensor Dimmer restarts and blinks green for a few seconds.

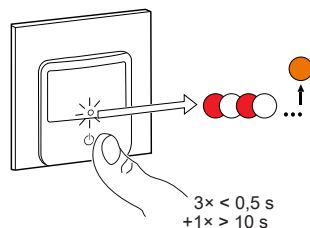

Using the device

On the **Home** page, tap **All devices > Motion Sensor Dimmer** to access the control panel.

On the control panel page, you can see the following:

- The motion detection and current Lux level (A)
- The current device state and brightness level (B)
- Sliding bar to adjust the brightness (C)
- Schedule, page 14 (D)
- Settings, page 15 (E)

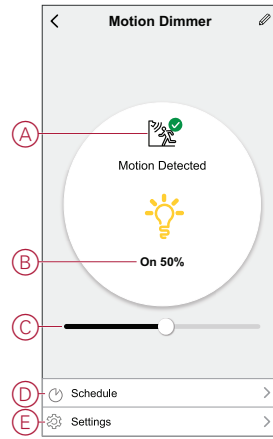

Switching/Dimming the device manually

You can switch On/Off and increase/decrease the brightness of the Dimmer manually. The Dimmer will provide power to the load connected to it. Short press the push button on the device once to switch On/Off the Motion Sensor Dimmer.

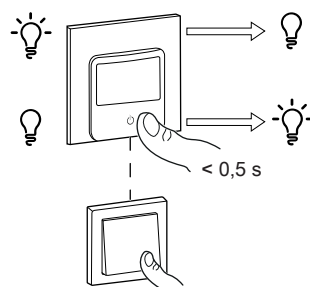

Long press the push button on the device to increase/decrease the brightness of the Dimmer.

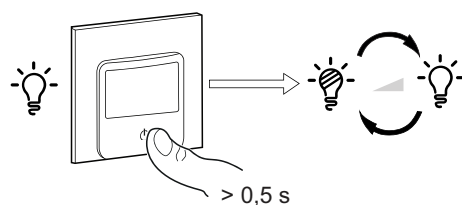

Switching/Dimming the device using app

Using the Wiser app, you can switch On/Off and increase/decrease the brightness of the device.

To switch the device On/Off:

1. On the **Home** page, tap the **power button** (A) to switch On/Off the Motion Sensor Dimmer.

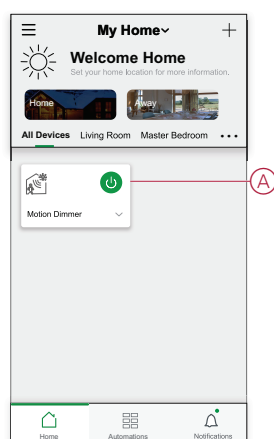

2. Tap the ▼ for common function and drag the slider (B) to adjust the brightness of the dimmer.

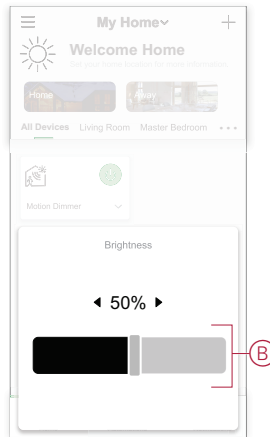

3. Alternatively, you can navigate to the control panel, page 11 of the device and tap  to switch On/Off the and use the slider to adjust the brightness of Motion Sensor Dimmer.

NOTE: The control panel shows the current state of the device.

Creating a schedule

The Motion Sensor Dimmer can be controlled and triggered by a schedule. Once the schedule is set, your system will follow the active schedule. You can create or modify the schedules at any time.

To create a schedule:

1. On the **Home** page, tap **All devices** > **Motion Sensor Dimmer**.
2. Tap **Schedule** > **Add schedule** to add a schedule.
3. Set the time (A).
4. Tap **Repeat** (B) to select the days you want to set the schedule.
5. Tap **Note** (C), enter the note and tap **Confirm**.
6. Tap the toggle switch (D) to turn On the **Notification** for the schedule. The app will send a notification that the scheduled task is executed at the time of schedule.

7. Adjust the **Brightness settings** (E) through sliding bar.

- **100%** - Turns On the Dimmer with maximum brightness on the scheduled time
- **Off** - Turns Off the Dimmer on the scheduled time

Drag the sliding bar anywhere in between to turn On the Dimmer with a set brightness level on the scheduled time.

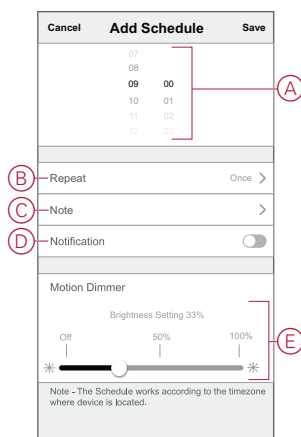

8. Tap **Save**.

Managing motion sensor dimmer settings

Using Wiser app, you can manage the settings.

To access the motion sensor dimmer settings:

1. On the **Home** page, tap **All devices** > **Motion Sensor Dimmer**.
2. On the device control panel page, tap **Settings**.

Dimmer setting

Dimming Mode

You can change the dimming mode in the app if you have problems with light flickering. This improves the dimming quality.

Tap **Dimming Mode** and select either of the following (A):

- **Auto** - When any other load is connected to the dimmer (e.g. filament bulb)
- **RL-LED** - When a LED is connected to the dimmer

NOTE: This mode uses 10 % of the nominal load to avoid overheating of the Dimmer.

Settings

Dimmer Settings

Dimming Mode

Auto

Dimming Range

Toggle Mode Setting

Last Level

Sensor Settings

Sensitivity Setting

High

Detection Delay

05:00

Lux Settings

Dimming Mode

Auto

✓

RL-LED

Cancel

Dimming Range

You can restrict the maximum and minimum brightness of the load connected to the device. This is done to avoid flickering and switching off the LED.

Tap **Dimming Range** and do either or both of the following (B):

- **Min Brightness** - Drag the sliding bar to restrict the minimum brightness

TIP: If you set the minimum brightness to the right most position on this sliding bar, then the load glows at the minimum brightness even if you drag the sliding bar to the lowest value in the control panel, page 11.

- **Max Brightness** - Drag the sliding bar to restrict the maximum brightness

TIP: If you set the maximum brightness to the left most position on this sliding bar, then the load glows at the maximum brightness even if you drag the sliding bar to the highest value in the control panel, page 11.

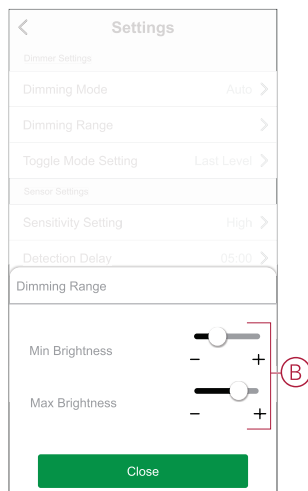

Toggle mode setting

Using this setting, the device will remember the last state of the device.

Tap **Toggle Mode Setting** and select any one of the following (C):

- **100%** - The LED glows at maximum brightness every time it is turned on
- **Last Level (Memory Function)** - The LED glows at the previously set brightness level whenever it is turned on

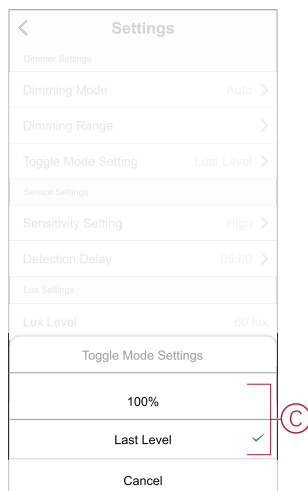

Sensor setting

Sensitivity Setting

Using the Wiser app, you can set the sensitivity of the sensor (such as High, Medium, Low).

Tap **Sensitivity Setting** and select one of the following levels (A):

- **High**
- **Medium**
- **Low**

NOTE: The high sensitivity level detects the slightest movement.

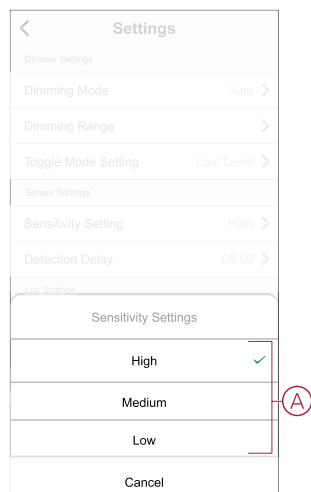

Detection Delay

Using the wiser app, you can set the detection delay time.

Tap **Detection Delay** and select the time duration (B) or tap **Detection delay custom** (C) to customize your detection delay time.

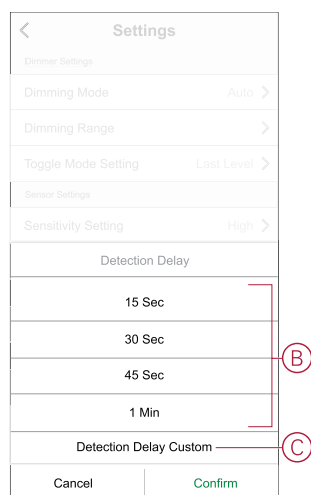

Lux Customization

Using the Wiser app, you can define the threshold value for lux ranges (such as very dark, dark, bright, very bright) of the environment. This will help to prevent the false alarm caused by changes in the light intensity.

Tap **Lux Customization** and drag the slider bar (A) to define its threshold value and tap **Confirm**.

- **Very dark level** - Lux value ranges from 1 lux to 100 lux
- **Dark level** - Lux level ranges from 6 lux to 300 lux
- **Bright level** - Lux level ranges from 101 lux to 2000 lux

NOTE: The **Current Lux Value** is the current light level present in the environment measured by the sensor.

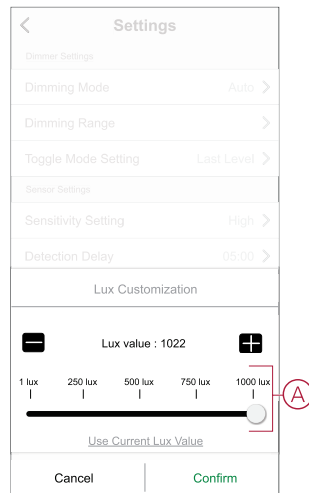

Creating a moment

A Moment allows you to group multiple actions that are usually done together. Using the Wiser app, you can create moments based on your needs (such as movie night).

To create a moment:

1. On the **Home** page, tap .
2. Go to **Moment** > **+** to create a moment.
3. Tap **Edit name**, enter the name of the moment (A) and tap **Save**.

TIP: You can choose the cover image that represents your moment by tapping .

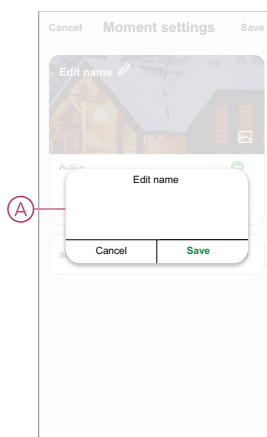

4. In the **Action** section, tap **Add task** (B) to display the slide-up menu.

5. In the **Add task** menu, you can do either or all of the following actions (C):
- **Run the device** - Select the devices that you want in a moment.
 - **Select Automation** - Select the automation that you want to enable or disable. For more info refer to [Automation](#), page 21.
 - **Delay** - Set the delay time.

NOTE: You can add one or more actions using .

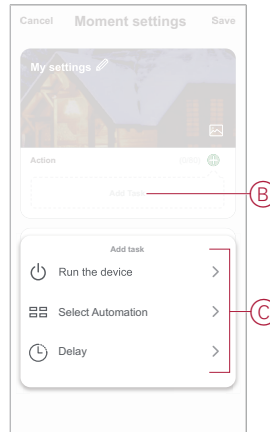

6. Tap **Run the device > Motion Sensor Dimmer** to select either or all the functions to add in the moment and tap **Save**:
- **Motion Dimmer (D)** : To set the device **On/Off**
 - **Brightness (E)** : To set the **percentage** of brightness required.

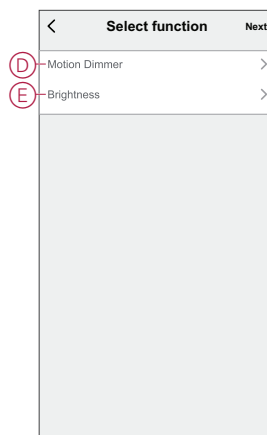

7. Once all the actions are set, tap **Save**.

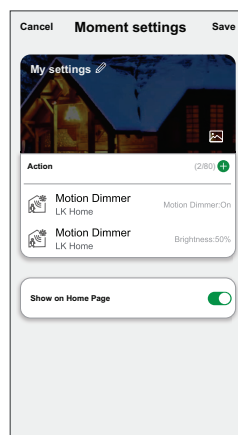

Editing a moment

To edit a moment:

1. On the **Moment** tab, locate the moment you want to edit and tap **...**.
2. On the **Edit** page, you can tap each item (such as dimmer, shutter, delay, temperature, etc.) to change the settings.

TIP:

- You can add one or more actions using .
- To delete an existing action, slide the each item towards left and tap **Delete**.

Deleting a moment

To delete a moment:

1. On the **Moment** tab, locate the moment that you want to delete and then tap **...**.
2. Tap **Delete** and tap **Ok**.

NOTE: After deleting a moment, the device action can no longer be triggered.

Creating an automation

An automation allows you to group multiple actions that are usually done together, triggered automatically or at scheduled times. By using the Wiser app, you can create automations based on your needs.

To create an automation:

1. On the **Home** page, tap .
2. Go to **Automation** > **+** to create an automation.
3. Tap **Edit name**, enter the name of the automation (A) and tap **Save**.

TIP: You can choose the cover image that represents your automation by tapping .

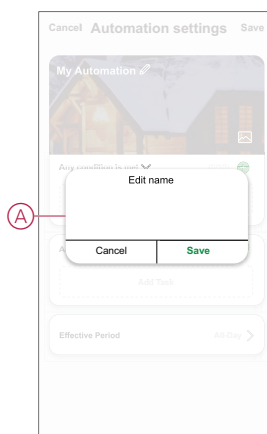

4. Tap **Any condition is met** to select any one of the condition type (B):
- **All conditions are met** - The automation is triggered when all the conditions are met.
 - **Any condition is met** - The automation is triggered when at least one condition is met.

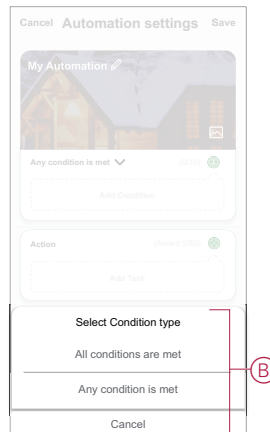

5. Tap **Add Condition** to display the slide-up menu.
6. In the **Add Condition** menu, you can do either or all of the following options (C):
- **When weather changes** - Select the various weather settings.
 - **Schedule** - Set the time and day.
 - **When device status changes** - Select the device and it's function.

Note: You can add one or more conditions using .

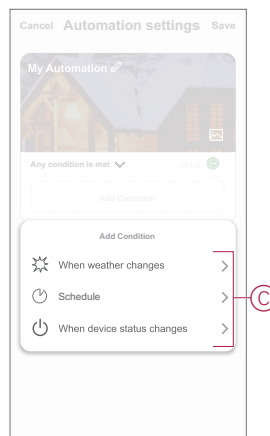

7. Tap **When device status changes > Motion Sensor Dimmer** and select either functions:

- **Motion Dimmer** - To set the dimmer On\Off (D)
- **Motion State** - Select the Occupy or Unoccupied state (E)
- **Lux Level** - Adjust the desired Lux Level (F)
- **Brightness** - Adjust the desired brightness level (G)

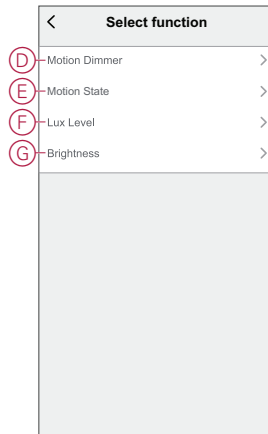

8. Tap **Add task** to open the slide-up menu.

9. In the **Add task** menu, you can do either or all of the following options (H):

- **Run the device** - Select the devices that you want to trigger
- **Moment or Automation** - Select the moment which you want to trigger or select the automation that you want to enable or disable
- **Send notification** - Turn On notification for the automation
- **Delay** - Set the delay time

NOTE: You can add one or more actions using .

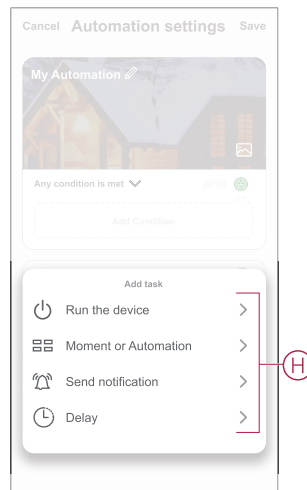

10. Tap on **Effective period** to set the time range for the automation. You can select any one of the following (I):
- **All-day** - 24 hours
 - **Daytime** - From sunrise to sunset
 - **Night** - From sunset to sunrise
 - **Custom** - User defined time period

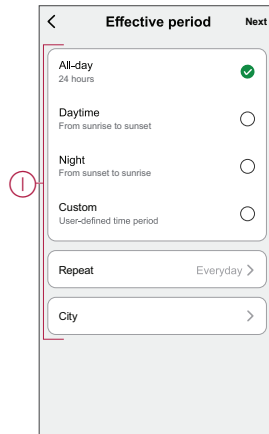

11. Once all the actions and conditions are set, tap **Save**.
Once the automation is saved, it is visible on the **Automation** tab. You can tap the toggle switch on the automation to enable it.

Example of an automation

This demonstration shows you how to create an automation to turn on the dimmer at the scheduled time..

1. Go to **Automation** > **+** to create an automation.
2. Tap **Edit name**, enter the name of the automation and tap **Save**.
TIP: You can choose the cover image that best represents your automation by tapping .
3. Tap **Add Condition** > **Schedule**.
 - Tap **Repeat** (A), select the days you want to set the schedule and tap **Save**.
 - Set the time (B) at which the automation must start and tap **Next**.

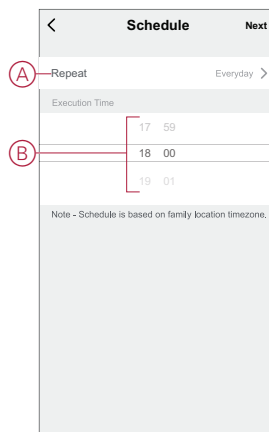

4. Tap **Add task** > **Run the device** > **Motion Sensor Dimmer**.

5. Tap **Motion Dimmer** in the slide-up menu, select **On** (C) and tap **Save**.

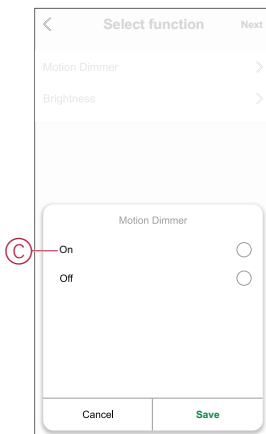

6. Tap **Next**.

7. In the **Automation Settings** page, tap **Save**.

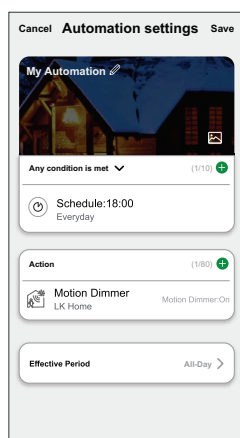

Once the automation is saved, it is visible on the **Automation** tab. You can tap the toggle switch on the automation to enable it.

Editing an automation

To edit an automation:

1. On the **Automation** tab, locate the automation you want to edit and tap **⋮**.
2. On the **Edit** page, you can tap each item (such as dimmer, shutter, delay, temperature, etc.) to change the settings.

TIP:

- You can add one or more actions using **+**.
- To delete an existing condition or action, slide each item towards left and tap **Delete**.

Deleting an automation



To delete an automation:

1. On the **Automation** tab, locate the automation that you want to delete and then tap **⋮**.
2. Tap **Delete** and tap **Ok**.



NOTE: After deleting an automation, the device action can no longer be triggered.

LED Indication

Pairing

User Action	LED Indication	Status
Press the push button 3 times	LED blinks amber per second. 	Pairing mode is active for 30 seconds. When pairing is completed, LED glows green for some time before turning Off. 



Resetting









User Action	LED Indication	Status
Press the push button 3 times and hold it down once for > 10 s.	After 10 s, the LED blinks red. 	The device is in reset mode. It is reset to the factory settings after 10 seconds. The device then restarts and the LED blinks green for a few seconds and then stays amber. 

Troubleshooting

Symptom	Solution
Dimming up not possible.	<ul style="list-style-type: none"> Reduce/increase load. Allow the Dimmer to cool in case of overheating. Change the load (if the load is incompatible with the Dimmer).
Switching On not possible.	<ul style="list-style-type: none"> Allow the Dimmer to cool in case of overheating. Reduce load. Change load. Check wiring between the push button and the Dimmer.
Flickering at minimum brightness.	<ul style="list-style-type: none"> Increase minimum brightness (if flickering still persists, install a 31LCDA load correction device). Change the load (if the minimum brightness is insufficient). Set to RL LED mode as it uses 10 % the of nominal load to avoid overheating of the Dimmer.
Flickering	<ul style="list-style-type: none"> Change load. Set to RL LED mode as it uses 10 % the of nominal load to avoid overheating of the Dimmer.
Only slight dimming capability	<ul style="list-style-type: none"> Change dimming range. Set to RL LED mode as it uses 10 % the of nominal load to avoid overheating of the Dimmer. Change the load (if the load is incompatible with the Dimmer).
The device is not ready to pair after the device is removed from the app.	Reset to factory default settings, refer to resetting the device , page 11.

Technical Data

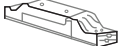
Nominal voltage	AC 230 V ~, 50 Hz		
Nominal power	Load type	Load name	Load value
	 LED	LED	7–100 VA  RC 7–20 VA  RL

		Iron core transformer	14–150 VA  RL
		Incandescent lamp	14–200 W  R
		Halogen lamp	14–150 W  R
		Electronic step-down converter	14–150 VA  RC
Standby	Max 0.4 W		
Neutral conductor	Not required		
Connecting Terminals	Screw terminals for max. 2 x 2.5 mm ² , 0.5 Nm		
Extension unit	Single Push-button, unlimited number, max. 50 m		
Fuse protection	16 A circuit breaker		
Operating frequency	2405 - 2480 MHz		
Max. radio-frequency power transmitted	< 10 mW		
Communication protocol	Zigbee 3.0 certified		

Compliance

Compliance information for Green Premium products

Find and download comprehensive information about Green Premium products, including RoHS compliance and REACH declarations as well as Product Environmental Profile (PEP) and End-of-Life instructions (EOLI).

General information about Green Premium products

Click the link below to read about Schneider Electric's Green Premium product strategy.

<https://www.schneider-electric.com/en/work/support/green-premium/>

Find compliance information for a Green Premium product

Click the link below to search for a product's compliance information (RoHS, REACH, PEP and EOLI).

NOTE: You will need the product reference number or product range to perform the search.

<https://www.reach.schneider-electric.com/CheckProduct.aspx?cskey=ot7n66yt63o1xblflyfj>

Trademarks

This guide makes reference to system and brand names that are trademarks of their relevant owners.

- Zigbee® is a registered trademark of the Connectivity Standards Alliance.
- Apple® and App Store® are brand names or registered trademarks of Apple Inc.
- Google Play™ Store and Android™ are brand names or registered trademarks of Google Inc.
- Wi-Fi® is a registered trademark of Wi-Fi Alliance®.
- Wiser™ is a trademark and the property of Schneider Electric, its subsidiaries and affiliated companies.

Other brands and registered trademarks are the property of their respective owners.

Schneider Electric
35 rue Joseph Monier
92500 Rueil Malmaison
France

+ 33 (0) 1 41 29 70 00

www.se.com

As standards, specifications, and design change from time to time,
please ask for confirmation of the information given in this publication.

© 2021 – 2022 Schneider Electric. All rights reserved.

DUG_Motion sensor with dimmer_WSE-01