

# Unica - Connected Universal Push-button Dimmer LED

## Device user guide

Information about features and functionality of the device.

03/2025

# Legal Information

The information provided in this document contains general descriptions, technical characteristics and/or recommendations related to products/solutions.

This document is not intended as a substitute for a detailed study or operational and site-specific development or schematic plan. It is not to be used for determining suitability or reliability of the products/solutions for specific user applications. It is the duty of any such user to perform or have any professional expert of its choice (integrator, specifier or the like) perform the appropriate and comprehensive risk analysis, evaluation and testing of the products/solutions with respect to the relevant specific application or use thereof.

The Schneider Electric brand and any trademarks of Schneider Electric SE and its subsidiaries referred to in this document are the property of Schneider Electric SE or its subsidiaries. All other brands may be trademarks of their respective owner.

This document and its content are protected under applicable copyright laws and provided for informative use only. No part of this document may be reproduced or transmitted in any form or by any means (electronic, mechanical, photocopying, recording, or otherwise), for any purpose, without the prior written permission of Schneider Electric.

Schneider Electric does not grant any right or license for commercial use of the document or its content, except for a non-exclusive and personal license to consult it on an "as is" basis.

Schneider Electric reserves the right to make changes or updates with respect to or in the content of this document or the format thereof, at any time without notice.

**To the extent permitted by applicable law, no responsibility or liability is assumed by Schneider Electric and its subsidiaries for any errors or omissions in the informational content of this document, as well as any non-intended use or misuse of the content thereof.**

---

# Table of Contents

Safety Information.....	4
Unica - Connected Universal Push-button Dimmer LED .....	5
For your safety .....	5
About the device.....	6
Installing the device .....	6
Quick Home Connect.....	7
Pairing Wireless Switch with Push-button Dimmer .....	8
Operating a Dimmer.....	8
Resetting the Device in Quick Home Connect .....	9
LED Indications in Quick Home Connect.....	9
Troubleshooting in Quick Home Connect .....	9
Pairing the device with the Wiser Gateway .....	10
Pairing device manually.....	10
Pairing device with auto scan .....	12
Configuring the device .....	13
Changing the device icon .....	13
Renaming the device .....	14
Changing the device location .....	14
Removing the device .....	15
Resetting the device .....	15
Using the device.....	15
Switching/Dimming the device manually .....	16
Switching/Dimming the device using app .....	17
Creating a schedule .....	18
Dimmer settings.....	18
Creating a moment .....	22
Creating an automation .....	24
LED Indication.....	29
Troubleshooting .....	30
Technical Data .....	30
Compliance .....	32
Product Environmental Data.....	32
Trademarks.....	32

# Safety Information

## Important Information

Read these instructions carefully and look at the equipment to become familiar with the device before trying to install, operate, service, or maintain it. The following special messages may appear throughout this manual or on the equipment to warn of potential hazards or to call attention to information that clarifies or simplifies a procedure.



The addition of either symbol to a “Danger” or “Warning” safety label indicates that an electrical hazard exists which will result in personal injury if the instructions are not followed.



This is the safety alert symbol. It is used to alert you to potential personal injury hazards. Obey all safety messages that accompany this symbol to avoid possible injury or death.

### **DANGER**

**DANGER** indicates a hazardous situation which, if not avoided, **will result in** death or serious injury.

**Failure to follow these instructions will result in death or serious injury.**

### **WARNING**

**WARNING** indicates a hazardous situation which, if not avoided, **could result in** death or serious injury.

### **CAUTION**

**CAUTION** indicates a hazardous situation which, if not avoided, **could result in** minor or moderate injury.

### **NOTICE**

NOTICE is used to address practices not related to physical injury.



# Unica - Connected Universal Push-button Dimmer LED

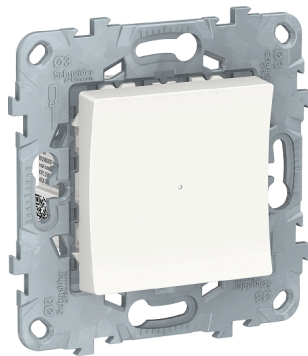

NU5517xx



NU3517xx  
NU3515xxW

## For your safety

### **⚠ DANGER**

#### **HAZARD OF ELECTRIC SHOCK, EXPLOSION, OR ARC FLASH**

Safe electrical installation must be carried out only by skilled professionals. Skilled professionals must prove profound knowledge in the following areas:

- Connecting to installation networks.
- Connecting several electrical devices.
- Laying electric cables.
- Safety standards, local wiring rules and regulations.

**Failure to follow these instructions will result in death or serious injury.**

**⚠ DANGER****RISK OF FATAL INJURY FROM ELECTRIC SHOCK**

The output may carry electric current even when the load is switched Off.

Disconnect the device from the supply by means of the fuse in the incoming circuit before working on the device.

**Failure to follow these instructions will result in death or serious injury.**

**⚠ CAUTION****THE DEVICE MAY BE DAMAGED**

Only connect dimmable load.

**Failure to follow these instructions can result in injury or equipment damage.**

## About the device

The Connected Universal Push Button Dimmer LED (hereinafter referred to as **dimmer**) is a push-button device that can be used to switch and dim LED, ohmic, inductive or capacitive loads manually or remotely.

## Control options

**Home control:** To control the dimmer through the Wiser app, you will need the Wiser Hub.

**Direct operation:** The dimmer can always be controlled directly on-site. You can also connect any number of mechanical push buttons.

## Functions

- The device can detect the load automatically.
- The device has internal self-protection, including thermal protection, overload resistance, short-circuit protection, soft start, and soft stop.

## Installing the device

Refer to the installation instruction supplied with this product.

See [Connected Universal Push Button Dimmer LED](#).

## Quick Home Connect

Quick Home Connect is a wireless connectivity solution for Zigbee devices without the need for a Hub/Gateway or smartphone application. Quick Home Connect is your starting point for wireless home automation. It performs functions like switching, dimming and shutter control using the Connected Wireless Switch (hereinafter referred to as Wireless switch) via a Zigbee network.

The **Wireless switch** is a battery-powered wireless push-button switch that is used to control Zigbee devices (such as dimmer, shutter, switch, and socket) within the same Zigbee network.

## Limitations

- Quick Home Connect serves only as a room control solution.
- With a 1-gang Wireless switch, you cannot mix lighting and shutter control. However, with a 2-gang Wireless switch, you can assign one gang for dimming/switching and the other for shutter control, or vice versa.
- This solution does not support remote control, smartphone app usage, or scheduling features.

## Pairing Wireless Switch with Push-button Dimmer

1. Short press the upper push button 5 times in quick succession on the Wireless switch.

The status LED blinks green.

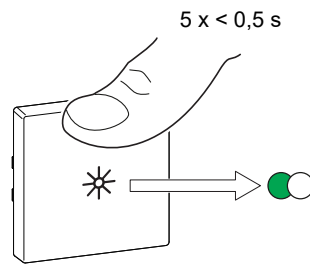

2. Short press the push-button of the Dimmer 5 times in quick succession.

The status LED blinks green.

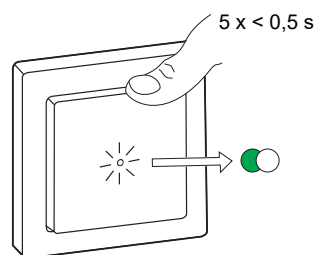

The light connected to the Push-button Dimmer blinks for a few times. The status LED stops blinking green on the Wireless switch and the Push-button Dimmer. The Push-button Dimmer can now be controlled by the Wireless switch.

## Operating a Dimmer

You can switch the dimmer ON/OFF and adjust its brightness using the paired Wireless switch.

- Short press the top or bottom of the Wireless switch (< 0,5 s) to turn ON/OFF the connected load (A).
- Long press the top or bottom of the Wireless switch (> 0,5 s) to increase or decrease the brightness of the connected load (B).

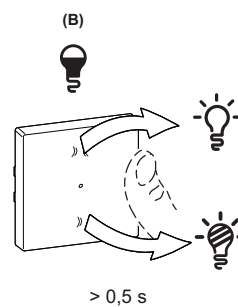
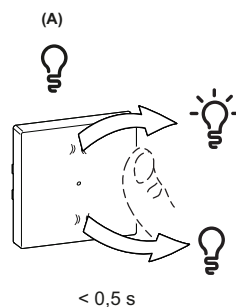

## Resetting the Device in Quick Home Connect

It is necessary to reset the devices in the following scenarios:



- Unpair the device in Quick Home Connect:
- Refer to
  - Resetting the Wireless switch
  - Resetting the Push-button dimmer

When reset is done successfully. The Wireless switch and device returns to factory default.

- Integrating into Wiser System
  - If you wish to integrate the devices into Wiser System, reset all the devices in Quick Home Connect and refer to pairing the device with Wiser Hub/ Gateway.

## LED Indications in Quick Home Connect

### Pairing the device in Quick Home Connect

User Action	LED Indication	Status
Press the push button 5 times in quick succession.	LED blinks green, once per second. 	Pairing mode is active for 60 seconds. When pairing is completed, LED stops blinking. 

## Troubleshooting in Quick Home Connect

Symptom	Possible cause	Solution
LED displays amber on the device.	Pairing not completed and returned to factory default.	Pair the Wireless switch and the device again. Refer to <ul style="list-style-type: none"> <li>• Push-button dimmer, page 8</li> </ul>
Wireless switch not able to control the device reliably.	The Wireless switch and the device are too far away from each other.	Place the Wireless switch in a position closer to the device.
	The Wireless switch lost pairing.	Pair the device again. Refer to <ul style="list-style-type: none"> <li>• Push-button dimmer, page 8</li> </ul>
	The Wireless switch battery is discharged.	Replace the battery of the Wireless switch

Scenario	Procedure
Control multiple devices with one Wireless switch.	To control multiple devices with a single Wireless switch, start by pairing it with one device. Then, use the same Wireless switch to pair with additional devices. <b>NOTE:</b> You can pair up to 7 devices to a single Wireless switch.
1-gang FLS with devices (relay switch, dimmer, shutter control, or socket outlet).	Pair the Wireless switch with any of the devices (relay switch, dimmer, shutter control, or socket outlet).
2-gang FLS with devices (relay switch, dimmer, shutter control, or socket outlet).	Pair either left or right Wireless switch with any of the devices (relay switch, dimmer, shutter control, or socket outlet). You can also pair another rocker of the Wireless switch with another device.

## Pairing the device with the Wiser Gateway

Using the Wiser app, pair your device with the **Gateway/Hub** to access and control the device. You can either add the device manually or do an auto-scan to pair it.

### Pairing device manually

To pair the device manually:

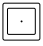
1. On **Home** page, tap **+**.
2. Tap  and select the required **Wiser Hub** on the slide-up menu.
3. Select an option to add the device (A):
  - **Add Device with Install Code**
  - **Add Device without Install Code**

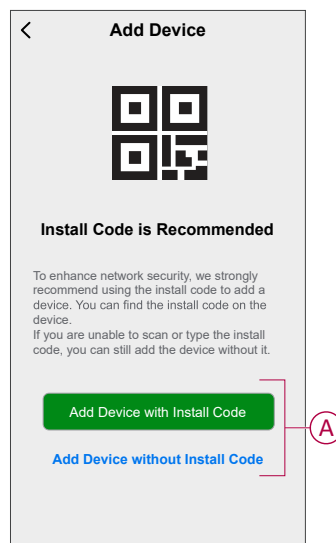

**TIP:** It is highly recommended to add the device with install code.

4. To pair the device with install code, tap **Add Device with Install Code** to display the slide-up menu. Select any one of the options (B):
  - **Scan Install Code** - you can scan the device for the install code
  - **Enter Install Code Manually** - you can manually enter the install code from the device

**TIP:** Install code is located on the rear side of the device.

After scanning or entering the install code, proceed to **Step 6**.

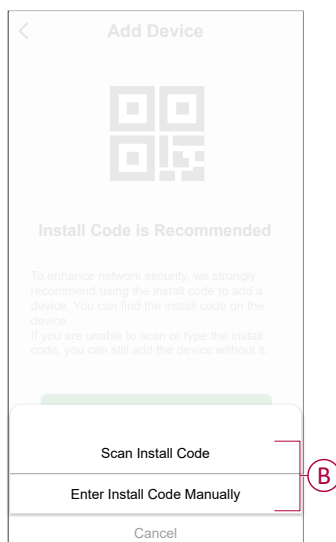

5. To pair the device without install code, tap **Add Device without Install Code**.
6. Short press upper part of the push-button 3 times ( $< 0,5$  s).

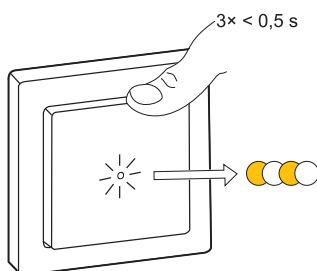

The LED blinks amber.

7. In the app, select **Confirm LED is blinking amber** and tap **Start configuration (C)**.

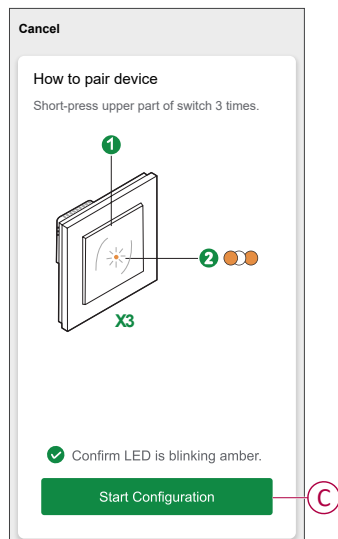

After a few seconds, a solid green LED indicates that the device is successfully paired to the Gateway/Hub.

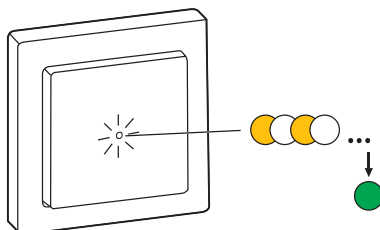

8. Once the device is added in the app, tap **Done**.

## Pairing device with auto scan

Pairing the device with auto scan automatically discovers the device when the corresponding device is powered on.

1. On the **Home** page, tap **+**.
2. Tap **Auto scan > Confirm**.
3. Enable permissions to **Access location** and **Wi-Fi** for scanning device and tap **Start scanning**.

**NOTE:** If you have multiple hubs, do Step 4 or proceed to Step 5.

4. Tap **Select hub** and select the Wiser hub from the slide-up menu.
5. Short press upper part of the push button 3 times (< 0,5 s) and wait for a few seconds until the device search is complete.

The LED blinks amber.

**TIP:** If you want to pair multiple devices at once, perform step 5 on each device and wait for a few seconds for them to be detected.



6. Tap **Next** (A) and select **Push Button Dimmer**.

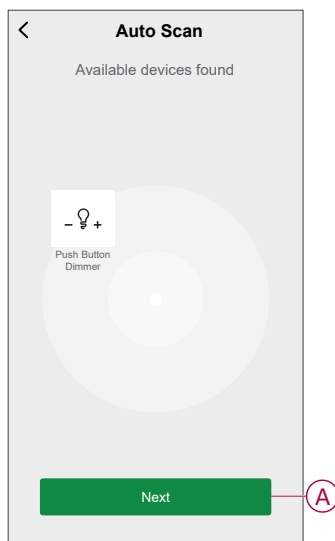



7. Once the device is added successfully, tap **Done**.

## Configuring the device

### Changing the device icon

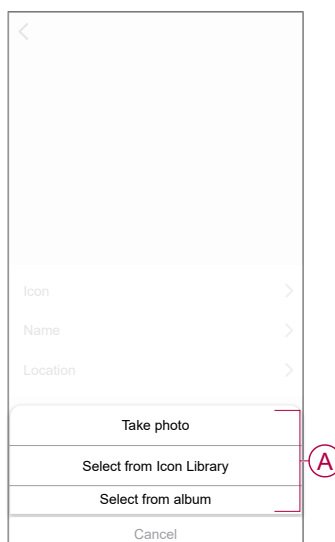

You can change the device icon using the Wiser app.

1. On the **Home** page, select the device for which you wish to change the icon.
2. At the top-right corner of the screen, tap .
3. Tap edit  next to the device name.
4. Tap **Icon** to view the menu.
5. In the slide-up menu, select any one of the following (A) to change the device icon:
  - **Take photo**: Allows you to take a photo with your mobile camera.
  - **Select from Icon Library**: Allows you to select an icon from the app library.
  - **Select from album**: Allows you to select a photo from the mobile gallery.



## Renaming the device

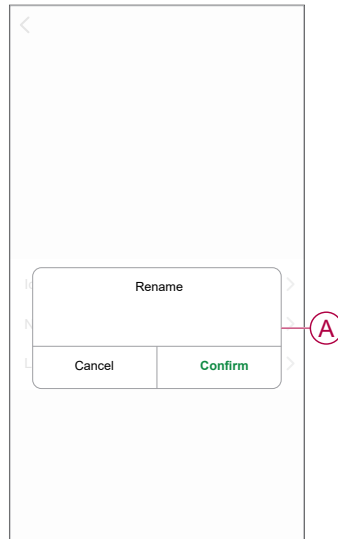

You can rename the device using the Wiser app.

1. On the **Home** page, select the device for which you wish to rename.
2. At the top-right corner of the screen, tap .
3. Tap edit  next to the device name.
4. Tap **Name**, enter the new name (A) and then tap **Confirm**.



## Changing the device location

You can change the device location using the Wiser app.

1. On the **Home** page, select the device for which you wish to change the location.
2. At the top-right corner of the screen, tap .
3. Tap edit  next to the device name.
4. Tap **Location**.
5. Select the desired location from the list (A) and then tap **Save**.

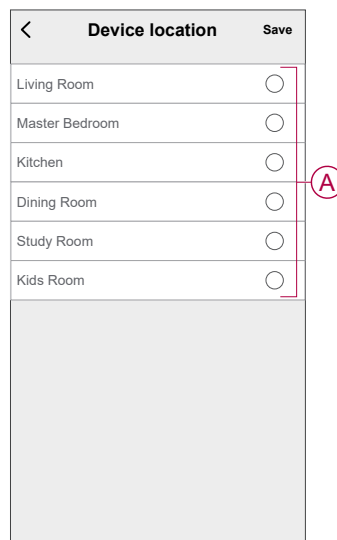

## Removing the device

Using the Wiser app, you can remove a device from the device list.

1. On the **Home** page, tap **All devices** > **Push-button Dimmer**.
2. Tap  to display more details.
3. Tap **Remove and Factory Reset Device (A)**.

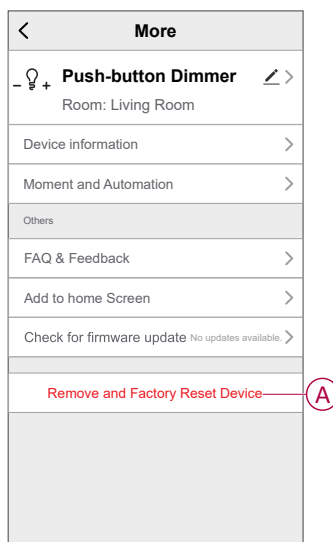

**TIP:** Alternatively, you can tap and hold the **Push-button Dimmer** on the **Home** page to remove the device.

**NOTE:** By removing the device, you will reset the device. If you still have a problem with the reset, then refer to [resetting the device](#), page 15.

## Resetting the device

You can reset the device to factory default manually.

- Short press push button 3 times ( $< 0.5$  s) and then long press the push button once ( $> 10$  s).
- After 10 s, the LED starts blinking red and then release the push button.
- The LED stops blinking upon successful reset of the device.
- The Push-button Dimmer restarts and blinks green for a few seconds.

**NOTE:** After reset, the LED turns amber indicating that it is ready for pairing.

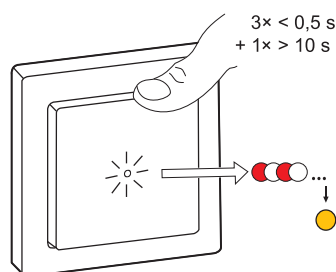

## Using the device

The Control Panel allows you to switch the Dimmer on/off, increase/decrease the brightness and control various settings.

On the **Home** page, tap **All devices** > **Push Button Dimmer** to access the control panel.

On the control panel page, you can see the following:

- The current state of the Dimmer (A)
- Sliding bar to adjust the brightness (B)
- The current brightness percentage (C)
- Schedule, page 18 (D)
- Settings, page 18 (E)

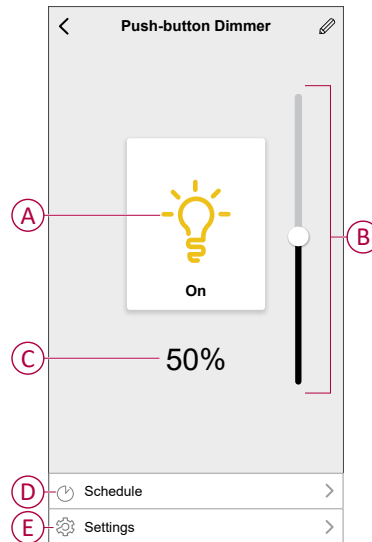

## Switching/Dimming the device manually

You can turn ON/OFF and increase/decrease the brightness of the dimmer manually. The dimmer will provide power to the load connected to it.

Short press the push button (< 0,5 s) once to switch ON/OFF the dimmer.

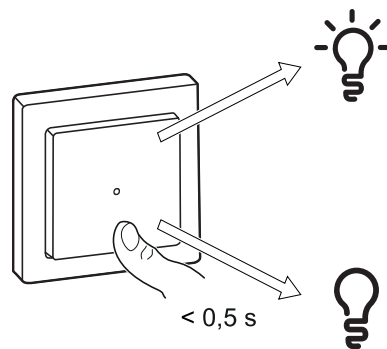

Long press the push button (> 0,5 s) on the device to increase/decrease the brightness of the dimmer.

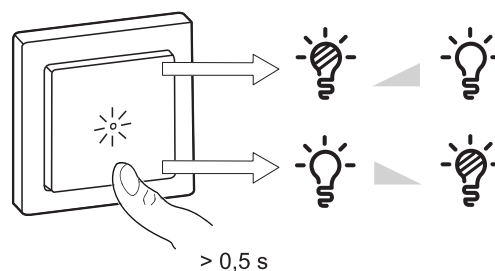



## Switching/Dimming the device using app

Using the Wiser app, you can switch on/off and increase/decrease the brightness of the device.

### Switching on/off the device

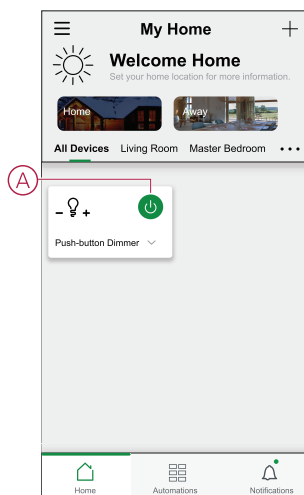
On the **Home** page, tap the power button (A) to switch on/off the Dimmer.



**NOTE:** You can also navigate to the control panel, page 15 of the device and tap  to switch on/off the Dimmer. The control panel shows the current state of the Dimmer.

### Adjusting the brightness of the device

To increase/decrease the brightness of the device:

On the **Home** page, tap  (B) and drag the slider to adjust the brightness of the Dimmer.

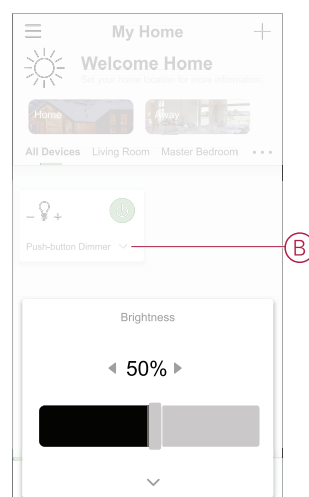

**NOTE:** You can also navigate to the control panel, page 15 of the device and drag the sliding bar up/down to increase/decrease the brightness. The control panel shows the current brightness percentage of the Dimmer.

## Creating a schedule

Using a schedule, you can control and trigger the dimmer. The system will follow the active schedule once it has been set. You can create or modify schedules at any time.

1. On the **Home** page, tap **All devices > Push-button Dimmer**.
2. Tap **Schedule > Add schedule** to add a schedule.
3. Set the time (A).
4. Tap **Repeat** (B) to select the days you want to set the schedule.
5. Tap **Note** (C), enter the note and tap **Confirm**.
6. Tap the toggle switch (D) to turn on the **Notification** for the schedule. The app will send a notification when the task is executed at the time of schedule.
7. In the Push-button Dimmer section, drag the **sliding bar** (E) to do one of the following:
  - **100%**: turns on the dimmer with maximum brightness on the scheduled time.
  - **Off**: turns off the dimmer on the scheduled time.
  - Drag the sliding bar anywhere in between to turn on the dimmer with a set brightness level on the scheduled time

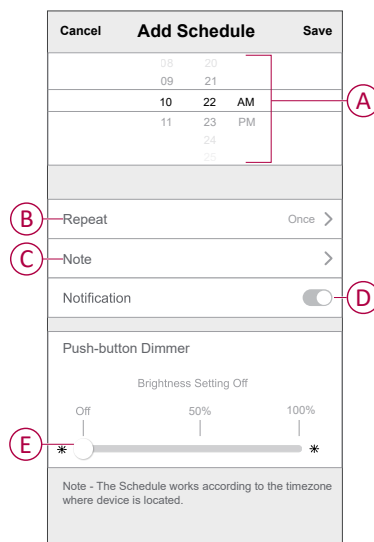

8. Tap **Save**.

## Dimmer settings

Using The Wiser app, you can manage the Dimmer modes and settings.

To access the dimmer settings:

1. On the **Home** page, tap **All devices > Push Button Dimmer**.
2. On the device control panel page, tap **Settings**.

## Dimming mode

You can change the dimming mode in the app if you have problems with light flickering. This improves the dimming quality.

Tap **Dimming Mode** (A) and select either of the following:

- **Auto** - When any other load is connected to the dimmer (e.g. filament bulb).
- **Leading Edge** - When a LED is connected to the dimmer. Only choose this mode if the LED is not working properly in Auto mode

**NOTE:** This mode uses 10 % of the nominal load to avoid overheating of the Dimmer, refer to technical data, page 30.

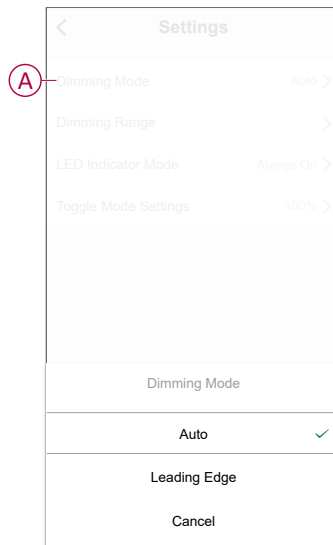

## Dimming range

You can restrict the maximum and minimum brightness of the load connected to the device. This is done to avoid flickering and switching off the LED.

Tap **Dimming Range** (B) and do either or both of the following:

- **Min Brightness** - Drag the sliding bar to restrict the minimum brightness.

**TIP:** If you set the minimum brightness to the right most position on this sliding bar, then the load glows at the minimum brightness even if you drag the sliding bar to the lowest value in the control panel, page 15.

- **Max Brightness** - Drag the sliding bar to restrict the maximum brightness.

**TIP:** If you set the maximum brightness to the left most position on this sliding bar, then the load glows at the maximum brightness even if you drag the sliding bar to the highest value in the control panel, page 15.

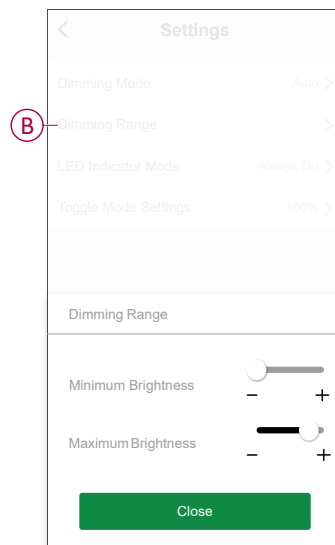



## LED indicator mode

You can select the LED indicator mode for easy identification of the device status.

Tap **Backlight Mode** (C) and select any one of the following:

- **Reverse With Load** - The LED on the dimmer is On when the connected load is Off.
- **Consistent With Load** - The LED on the dimmer is On when the connected load is On.
- **Always Off** - The LED on the dimmer is always Off.
- **Always On** - The LED on the dimmer is always On.

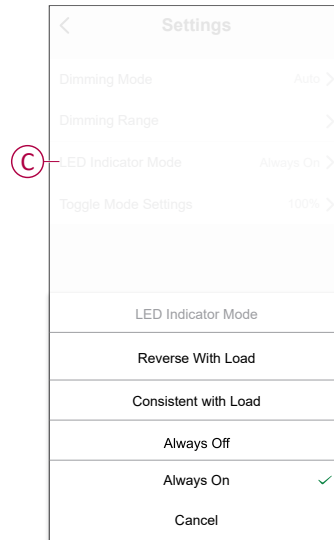

For information on LED color during each modes, refer to LED indication, page 29.

## Toggle mode setting

Using this setting, the device will remember the last state of the device.

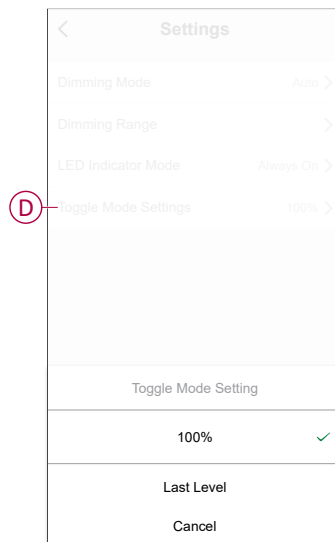

Tap **Toggle Mode Setting** (D) and select any one of the following:

- **100%** - The LED glows at maximum brightness every time it is turned on.
- **Last Level** (Memory Function) - The LED glows at the previously set brightness level whenever it is turned on.



## Creating a moment

A Moment allows you to group multiple actions that are usually done together. Using the Wiser app, you can create moments based on your needs (such as movie night).

1. On the **Home** page, tap .
2. Go to **Moment** > **+** to create a moment.
3. Tap **Edit name** , enter the name of the moment (A) and tap **Save**.  
**TIP:** You can choose the cover image that represents your moment by tapping .

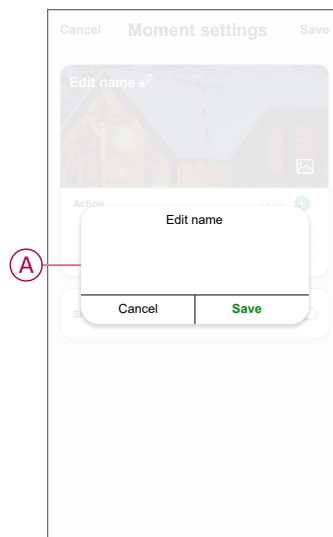

4. In the **Action** section, tap **Add task** (B) to display the slide-up menu.

5. In the **Add task** menu, you can do either or all of the following actions (C):

- **Run the device:** select the devices that you want in a moment.
- **Select Automation:** select the automation that you want to enable or disable. For more info refer to *Automation*, page 24.
- **Delay:** set the delay time.

**NOTE:** You can add one or more actions using .

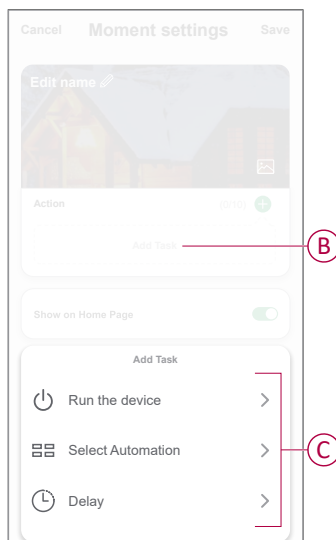

6. Tap **Run the device** > **Push-button Dimmer** and select either or both the functions to add in the moment:

- **Dimmer:** turn the Dimmer on/off (D).
- **Brightness:** adjust the brightness level (E).

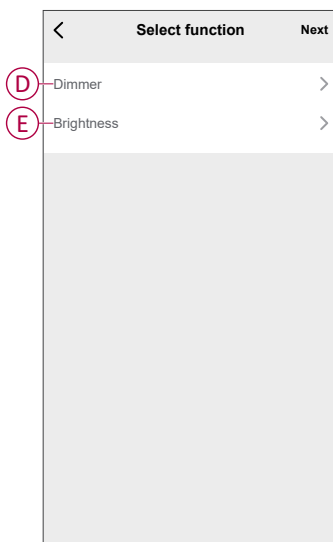

- Set all actions and tap **Save**.

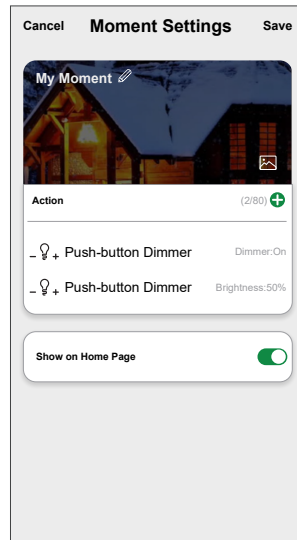

## Editing a moment

- On the **Moment** tab, locate the moment you want to edit and tap ●●●.
- On the **Edit** page, you can tap each item (such as dimmer, shutter, delay, temperature, etc.) to change the settings.

### TIP:

- You can add one or more actions using .
- To delete an existing action, slide each item towards left and tap **Delete**.

## Deleting a moment

To delete a moment:



- On the **Moment** tab, locate the moment that you want to delete and then tap ●●●.
- Tap **Delete** and then tap **Ok**.

**NOTE:** After deleting a moment, the device action can no longer be triggered.

## Creating an automation

An automation allows you to group multiple actions that are usually done together, triggered automatically or at scheduled times. By using the Wiser app, you can create automations based on your needs.

- On the **Home** page, tap .
- Go to **Automation** > **+** to create an automation.

3. Tap **Edit name** , enter the name of the automation (A) and tap **Save**.  
**TIP:** You can choose the cover image that represents your automation by tapping .

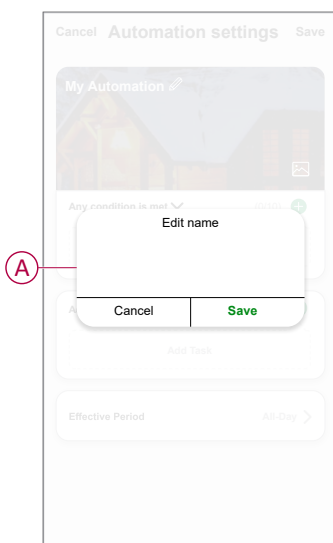

4. Tap **Any condition is met** to select any one of the condition type (B):
- **All conditions are met:** the automation is triggered when all the conditions are met.
  - **Any condition is met:** the automation is triggered when at least one condition is met.

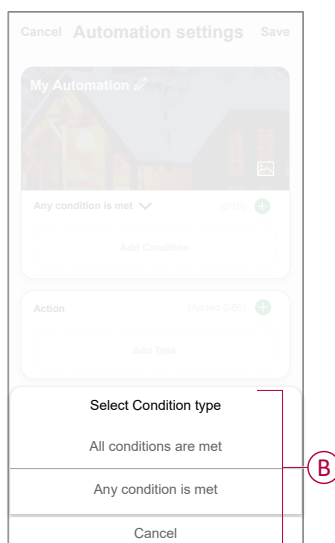

5. Tap **Add Condition** to display the slide-up menu.

6. In the **Add Condition** menu, you can do either or all of the following options (C):
- **When weather changes:** select the various weather settings.
  - **Schedule:** set the time and day.
  - **When device status changes:** select the device and it's function.

Note: You can add one or more conditions using .

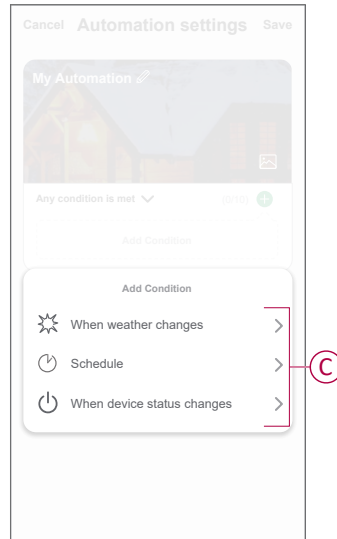

7. Tap **When device status changes** > **Push-button Dimmer** and select either or both the functions:
- **Dimmer:** turn the Dimmer On/Off (D)
  - **Brightness:** adjust the brightness level (E)

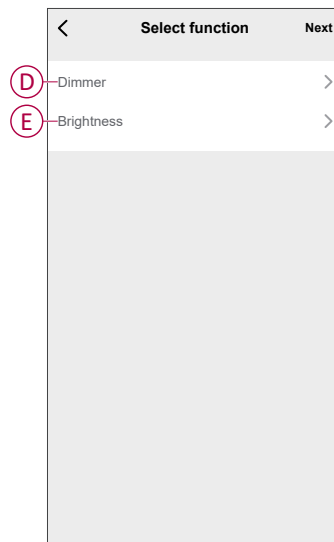

8. Tap **Add task** to open the slide-up menu.

9. In the **Add task** menu, you can do either or all of the following options (F):
- **Run the device:** select the devices that you want to trigger.
  - **Moment or Automation:** select the moment which you want to trigger or select the automation that you want to enable or disable.
  - **Send notification:** turn on notification for the automation.
  - **Delay:** set the delay time.

**NOTE:** You can add one or more actions using .

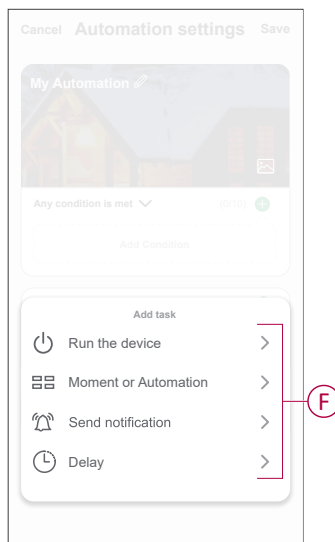

10. Tap on **Effective period** to set the time range for the automation. You can select any one of the following (G):
- **All-day:** 24 hours
  - **Daytime:** From sunrise to sunset
  - **Night:** From sunset to sunrise
  - **Custom:** User defined time period

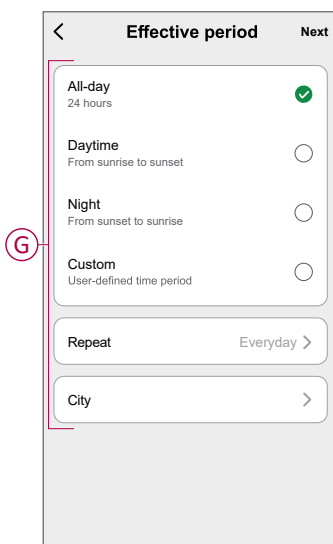



11. Set all the actions and conditions and tap **Save**.

Automation is now available under **Automation** tab. Use toggle switch to enable/disable automation.

## Example of an automation

This demonstration shows you how to create an automation to switch on the light with 50% brightness level when a motion is detected.

**NOTE:** The Dimmer will not be switched off automatically when the Sensor sends the "Unoccupied" message. To switch off the dimmer when there is no more motion, you must create a new automation.

1. Go to **Automation** > **+** to create an automation.
2. Tap **Edit name** , enter the name of the automation and tap **Save**.  
**TIP:** You can choose the cover image that represents your automation by tapping .
3. Tap **Add Condition** > **When device status changes** > **Motion Sensor**.
4. Tap **Motion State** > **Occupied (A)**.

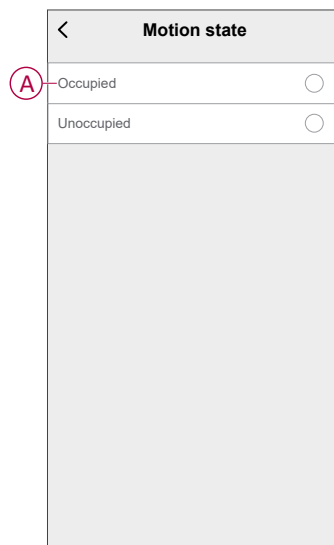

5. Tap **Add task** > **Run the device** > **Push-button Dimmer**.
6. Tap **Brightness (B)**, adjust the brightness to 50% and tap **Save**.  
**TIP:** Setting the brightness level turns on the light the light when the automation is triggered. You need not add a task to turn on the Dimmer separately.

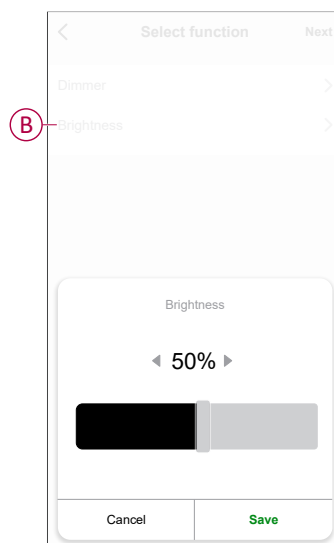

7. Tap **Next**.



8. In the **Automation Settings** page, tap **Save**.

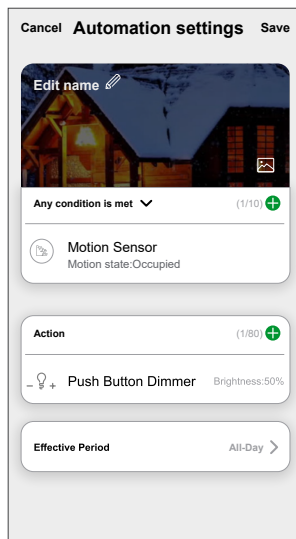

Automation is now available under **Automation** tab. Use toggle switch to enable/disable automation.

## Editing an automation

1. On the **Automation** tab, locate the automation you want to edit and tap ●●●.
2. On the **Edit** page, you can tap each item (such as dimmer, shutter, delay, temperature, etc.) to change the settings.

### TIP:

- You can add one or more condition or actions using .
- To delete an existing condition or action, slide each item towards left and tap **Delete**.



## Deleting an automation

1. On the **Automation** tab, locate the automation that you want to delete and then tap ●●●.
2. Tap **Delete** and then tap **Ok**.



**NOTE:** After deleting an automation, the device action can no longer be triggered.

## LED Indication





### Pairing

User Action	LED Indication	Status
Press the push-button 3 times	LED blinks amber per second. 	Pairing mode is active for 30 seconds. When pairing is completed, LED glows green for some time before turning off. 

## Resetting

User Action	LED Indication	Status
Press the push-button 3 times and hold it down once for > 10 s.	After 10 s, the LED blinks red. 	The device is in reset mode. It is reset to the factory settings after 10 seconds. The device then restarts and the LED blinks green for a few seconds and then stays amber. 



## LED Indicator Mode/Backlight Mode









Load Status	ON	OFF
Reverse with load	No LED	
Consistent with load		No LED
Always Off	No LED	No LED
Always On		

## Troubleshooting

Symptom	Solution
Dimming up not possible.	<ul style="list-style-type: none"> <li>Reduce/increase load.</li> <li>Allow the Dimmer to cool in case of overheating.</li> <li>Change the load (if the load is incompatible with the Dimmer).</li> </ul>
Switching On not possible.	<ul style="list-style-type: none"> <li>Allow the Dimmer to cool in case of overheating.</li> <li>Reduce load.</li> <li>Change load.</li> <li>Check wiring between the push button and the Dimmer.</li> </ul>
Flickering at minimum brightness.	<ul style="list-style-type: none"> <li>Increase minimum brightness (if flickering still persists, install a 31LCDA load correction device).</li> <li>Change the load (if the minimum brightness is insufficient).</li> <li>Set to RL LED mode.</li> </ul>
Flickering	<ul style="list-style-type: none"> <li>Change load.</li> <li>Set to RL LED mode.</li> </ul>
Only slight dimming capability	<ul style="list-style-type: none"> <li>Change dimming range.</li> <li>Set to RL LED mode.</li> <li>Change the load (if the load is incompatible with the Dimmer).</li> </ul>
The device is not ready to pair after the device is removed from the app.	Reset to factory default settings, refer to <a href="#">reset the device</a> , page 15.

## Technical Data

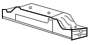
Nominal voltage	AC 230 V ~, 50 Hz		
Nominal power	Load type	Load name	Load value
	 LED	LED	7–100 VA  RC 7–20 VA  RL

		Iron core transformer	14–150 VA  RL
		Incandescent lamp	14–200 W  R
		Halogen lamp	14–150 W  R
		Electronic step-down converter	14–150 VA  RC
Standby	Max 0.4 W		
Neutral conductor	Not required		
Connecting Terminals	Screw terminals for max. 2 x 2.5 mm <sup>2</sup> , 0.5 Nm		
Extension unit	Single Push-button, unlimited number, max. 50 m		
Fuse protection	16 A circuit breaker		
Operating frequency	2405 - 2480 MHz		
Max. radio-frequency power transmitted	< 10 mW		
Communication protocol	Zigbee 3.0 certified		

# Compliance

## Product Environmental Data

Find and download comprehensive environmental data about your products, including RoHS compliance and REACH declarations as well as Product Environmental Profile (PEP), End-of-Life instructions (EOL) and much more.

<https://www.se.com/myschneider>



## General information about Schneider Environmental Data Program

Click the link below to read about Schneider Electric's Environmental Data Program.

<https://www.se.com/ww/en/about-us/sustainability/environmental-data-program/>



## Trademarks

This guide makes reference to system and brand names that are trademarks of their relevant owners.

- Zigbee® is a registered trademark of the Connectivity Standards Alliance.
- Apple® and App Store® are brand names or registered trademarks of Apple Inc.
- Google Play™ Store and Android™ are brand names or registered trademarks of Google Inc.
- Wi-Fi® is a registered trademark of Wi-Fi Alliance®.
- Wiser™ is a trademark and the property of Schneider Electric, its subsidiaries and affiliated companies.

Other brands and registered trademarks are the property of their respective owners.



Schneider Electric  
35 rue Joseph Monier  
92500 Rueil Malmaison  
France

+ 33 (0) 1 41 29 70 00

[www.se.com](http://www.se.com)

As standards, specifications, and design change from time to time, please ask for confirmation of the information given in this publication.

© 2021 – 2025 Schneider Electric. All rights reserved.

DUG\_Unica Push-button dimmer\_WSE-03