

Wiser Micromodule for Fil Pilote radiators

Device user guide

Information about features and functionality of the device.
03/2025



Legal Information

The information provided in this document contains general descriptions, technical characteristics and/or recommendations related to products/solutions.

This document is not intended as a substitute for a detailed study or operational and site-specific development or schematic plan. It is not to be used for determining suitability or reliability of the products/solutions for specific user applications. It is the duty of any such user to perform or have any professional expert of its choice (integrator, specifier or the like) perform the appropriate and comprehensive risk analysis, evaluation and testing of the products/solutions with respect to the relevant specific application or use thereof.

The Schneider Electric brand and any trademarks of Schneider Electric SE and its subsidiaries referred to in this document are the property of Schneider Electric SE or its subsidiaries. All other brands may be trademarks of their respective owner.

This document and its content are protected under applicable copyright laws and provided for informative use only. No part of this document may be reproduced or transmitted in any form or by any means (electronic, mechanical, photocopying, recording, or otherwise), for any purpose, without the prior written permission of Schneider Electric.

Schneider Electric does not grant any right or license for commercial use of the document or its content, except for a non-exclusive and personal license to consult it on an "as is" basis.

Schneider Electric reserves the right to make changes or updates with respect to or in the content of this document or the format thereof, at any time without notice.

To the extent permitted by applicable law, no responsibility or liability is assumed by Schneider Electric and its subsidiaries for any errors or omissions in the informational content of this document, as well as any non-intended use or misuse of the content thereof.

Table of Contents

Safety Information.....	4
Wiser Micromodule for Fil Pilote radiators	5
For your safety	5
About the device.....	6
Installing the device	6
Pairing the device with the Wiser Hub	6
Configuring the device	10
Renaming the device	10
Selecting the device location.....	10
Changing Nominal Power	11
Identifying the device	12
Tariff	13
Energy Centre	13
Using the device	13
Operating modes	13
Setting alarms	14
Creating a schedule	15
Automation.....	17
Moments	21
Removing the device	22
Resetting the device	23
LED indication	23
Troubleshooting	24
Technical data	24
Compliance.....	25
Product Environmental Data	25
EU Declaration of Conformity.....	25
Trademarks	26

Safety Information

Important Information

Read these instructions carefully and look at the equipment to become familiar with the device before trying to install, operate, service, or maintain it. The following special messages may appear throughout this manual or on the equipment to warn of potential hazards or to call attention to information that clarifies or simplifies a procedure.



The addition of either symbol to a “Danger” or “Warning” safety label indicates that an electrical hazard exists which will result in personal injury if the instructions are not followed.



This is the safety alert symbol. It is used to alert you to potential personal injury hazards. Obey all safety messages that accompany this symbol to avoid possible injury or death.

DANGER

DANGER indicates a hazardous situation which, if not avoided, **will result in** death or serious injury.

Failure to follow these instructions will result in death or serious injury.

WARNING

WARNING indicates a hazardous situation which, if not avoided, **could result in** death or serious injury.

CAUTION

CAUTION indicates a hazardous situation which, if not avoided, **could result in** minor or moderate injury.

NOTICE

NOTICE is used to address practices not related to physical injury.

Wiser Micromodule for Fil Pilote radiators



THG_CCTFR6710

For your safety

⚠️⚠️ DANGER

HAZARD OF ELECTRIC SHOCK, EXPLOSION, OR ARC FLASH

Safe electrical installation must be carried out only by skilled professionals. Skilled professionals must prove profound knowledge in the following areas:

- Connecting to installation networks.
- Connecting several electrical devices.
- Laying electric cables.
- Safety standards, local wiring rules and regulations.

Failure to follow these instructions will result in death or serious injury.

⚠️ DANGER

HAZARD OF ELECTRIC SHOCK

- Make sure that the terminal connection area does not come in contact with the metallic parts of any device installed in the same location.
- Do not short the outputs to neutral.

Failure to follow these instructions will result in death or serious injury.

About the device

The Wiser Micromodule for Fil Pilote radiators (hereinafter referred to as **module**) is intended for controlling FIP compatible electric heaters. In combination with the Wiser app and a Wiser compatible Thermostat, the room temperature can be regulated. Energy consumption can be measured and, if necessary, the load can be shed.

The room will have a (temp sensor) room thermostat. The user sets the room setpoint and the hub compares the temperature of the room. If its too low, the hub sends the command to the module to heat. Once the room is set to correct temperature, the hub sends the command to stop heating.

NOTE:

- Up to 4 modules can be added to one room.
- The electric heater must be set to automatic mode, as Wiser can only control the room temperature in automatic mode. We also recommend setting a higher set point temperature than usual, e.g. 25 °C.

Installing the device

Refer to the installation instruction supplied with this product.

Pairing the device with the Wiser Hub

Using the Wiser Home app, pair your module with the **Wiser Hub** to access and control the electric heater.

To pair the device:

1. On the **Home** screen, tap .
2. Tap **Devices** >  > **Climate** > **FIP Micromodule** > **Next**.

NOTE: The next screen shows the joining process of device.

3. Tap **Scan QR code** and allow the Wiser Home app to access your camera.

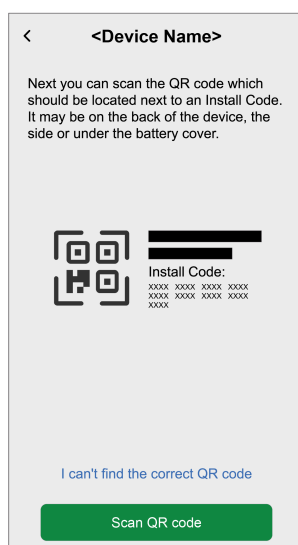

NOTE: If the dimmer doesn't have the QR code or **MAC Address** and **Install Code**, you can manually pair it by tapping **I can't find the correct QR code**.

However, it is highly recommended to use a QR code or **MAC Address** and **Install Code** for pairing.

4. If the QR code is incorrect, a message **Incorrect QR code scanned** will appear. Tap **I can't scan the QR code**, enter the **MAC Address** and **Install Code**, and then tap **Connect**.

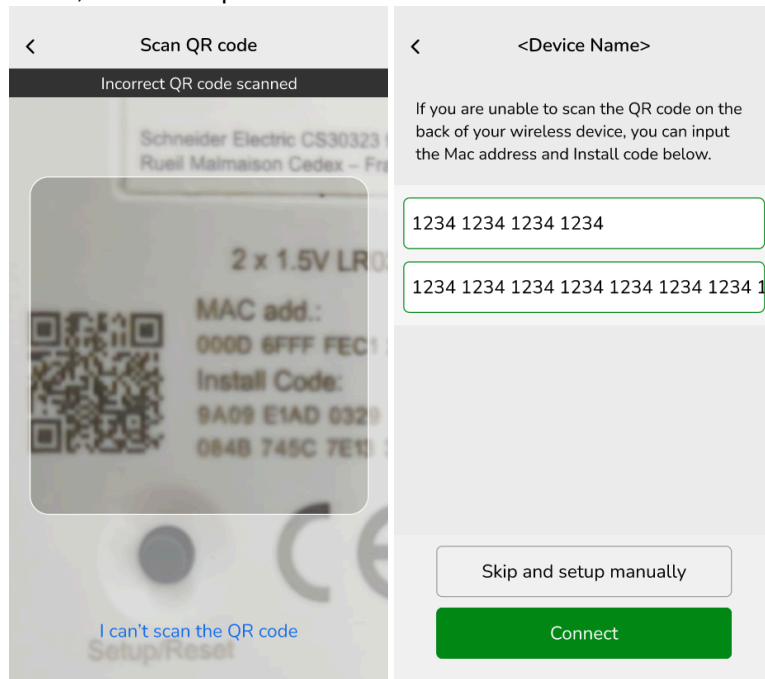

The Wiser Home app verifies as **Confirmed** if the **MAC Address** and **Install Code** are valid.

NOTE: If the **MAC Address** and **Install Code** are not visible, you can manually pair it by tapping **Skip and setup manually**.

5. Once the device is validated, Short press the Setup/Reset button of the module 3 times.

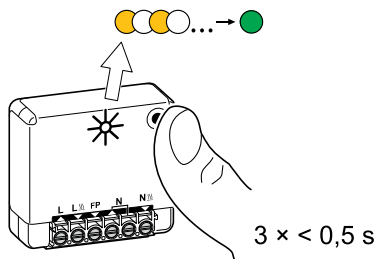

The LED first blinks amber.

6. Wait for a few seconds until the LED turns green.

The device is joined.

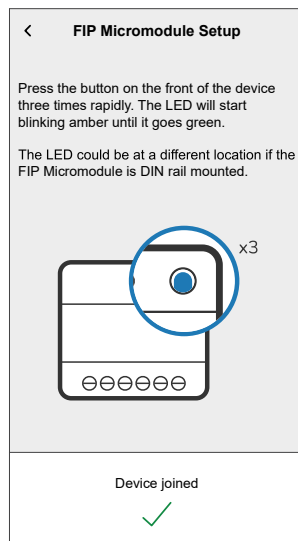

7. On the device setup page, tap  (A) and enter a name for the device.
8. Tap **Next** and assign the device to a new room or an existing room and tap **Submit**.

IMPORTANT:

- The next screen shows the **Device Settings** page, where you have the option to configure the settings during the pairing process or at a later time. If you prefer to configure it later, tap **Submit**. For more information on device settings, refer to [Configuring the device](#), page 10 section.
- The maximum power consumed by the appliance controlled by the module is known as **Nominal power**. It is the maximum power the module can manage.
- By default, the value is 2000 W. The nominal power must be between **1 and 4600 W**.

NOTE: The Nominal power value will only be used for the future updates in the Wiser Home app.

9. If you like to modify this value, proceed with step 7 else proceed with step 9.
10. Tap  (B).

11. Tap **OK** and enter a value between 1 to 4600 W based on the load connected.

12. Tap **Next** and assign the device to a new room or an existing room.

13. Tap **Submit**.

Once the pairing process is complete, the device name (example, Heating) is listed under **All** devices in **Home** screen.

Configuring the device

Renaming the device

Using the Wiser Home app, you can rename your device.

1. On the Home screen, tap .
2. Tap **Devices > Climate > FIP Micromodule > Name (A)** to rename the device.

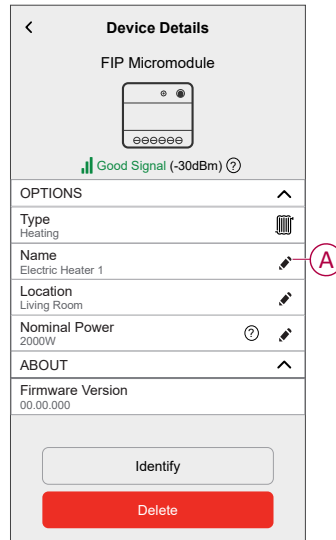

The settings will be saved automatically.

NOTE: The **Type** is available as **Heating** by default. You cannot edit it.

Selecting the device location

Using the Wiser Home app, add the device to any room (such as living room, bedroom, etc).

1. On the Home screen, tap .

2. Tap **Devices > Climate > FIP Micromodule > Location (A)** to assign the device to an existing room or a new room and tap **Submit**.

NOTE: Tap **Remove from Room** to remove the device from the existing room.

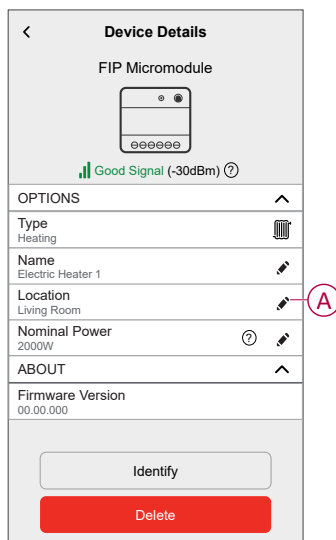

Changing Nominal Power

Nominal Power is the maximum power this device can manage. By default, the value is 2000 W. Using the Wiser Home app you can change the value if required. To change the Nominal Power value:

1. On the Home screen, tap .
2. Tap **Devices > Climate > FIP Micromodule > Nominal Power (A)**.

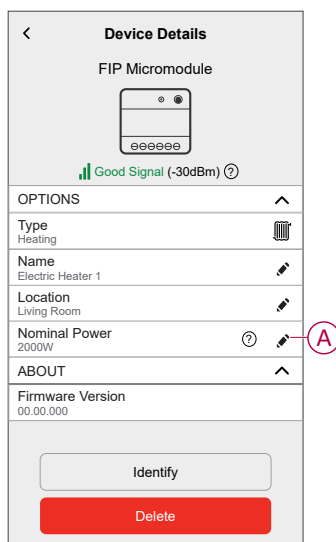

3. Tap **OK** and enter a value between 1 to 4600 W based on the load connected. The settings will be saved automatically.

NOTE: The Nominal power value will only be used for the future updates in the Wiser Home app.

Identifying the device

Using the Wiser Home app, identify the module among the devices available in a home.

1. On the Home screen, tap .
2. Tap **Devices > Climate > FIP Micromodule > Identify (A)**.

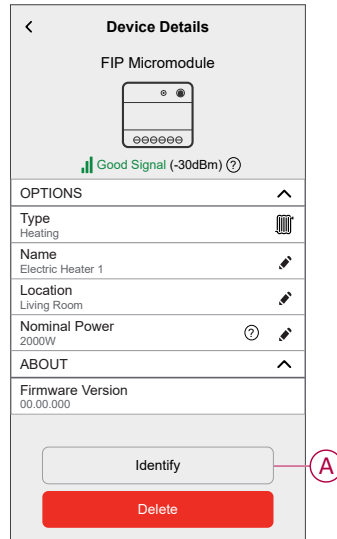

The status LED blinks green, upon successful identification of the module.

3. Tap **OK** to finish identifying the device.

Tariff

You can set tariff in the Wiser Home app to access your energy cost and billing data.

To accurately deliver real-time information on energy consumption, it is essential to include the relevant tariff information. The cost associated with energy consumption is determined by your specific contract type. The different contracts will have varying rates, which can affect how much you pay for the energy you use. By providing the tariff details, we can make sure that the energy consumption data reflects the most accurate costs, helping you better understand your energy usage and manage your expenses effectively.

The cost of energy consumption is based on below contract type:

- Flat rate
- Peak/Off-Peak Hours rate
- No contract

For more information on **Setting Tariff** refer to the respective [System User Guide](#).

Energy Centre

You can monitor your energy consumption and production even without a grid monitoring device (PowerTag E). If standalone energy devices are installed in your home, the Energy Center will be available to help you manage and monitor your energy usage.

For more information on **Energy Centre**, refer to the respective [System User Guide](#).

Using the device

Operating modes



Using the Wiser Home app, you can control the Heating devices.

1. On the **Control** tab, tap **All** devices or a room tab where the Plug is located > **Heating device**.
2. On the Device Control tab, the current temperature is shown.

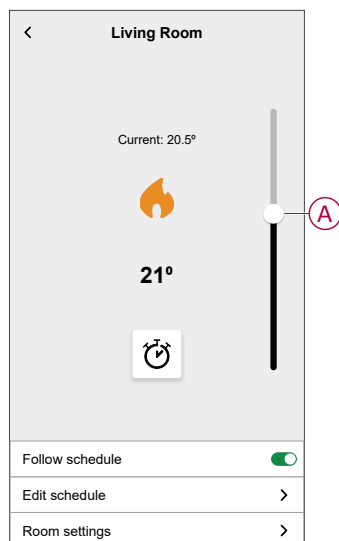
3. Drag the sliding bar up/down (A) to adjust the set-point temperature (Heating).



The current operating mode indicates the mode in which the system is working.

- **Off** : Turns the system off, available in **Home** screen.
- **Heating** : System operates in heating mode when the set-point temp > room temp.
- **Boost mode** : Boost Mode will apply a boost of +2 °C for one hour to every room in the system. For more information on different modes, refer to [Wiser Modes](#).
- **Room settings**: You can edit the room name for the device.

NOTE: To access live, history and energy insights, it's recommended to install PowerTag on the module loads. Refer to [Checking device consumption](#).

TIP: You can also turn the device ON/OFF when you add it to your **Favourites**. To know more about **Favourites**, refer to the [Manage Favourites](#) topic in the respective **System User Guide**.

Setting alarms

Using Wiser Home app, you can set alarms to notify overconsumption or no consumption of loads.

NOTE: Each device can have one overconsumption and one no consumption alarm.

To configure alarms:

1. On the Home screen, tap .
2. Tap **Account > Notifications and Alarms > Create a new alarm**.
3. Select an alarm type
 - Overconsumption
 - No consumption

4. Select a device from the list (A) and tap **Next**.

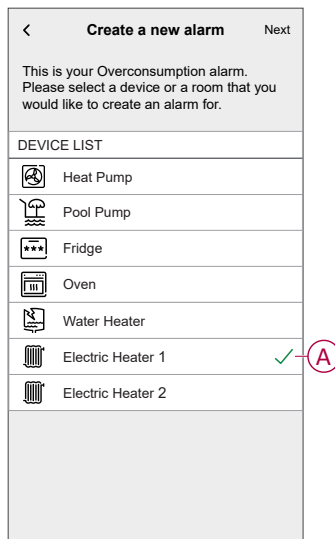

5. Enable the toggle switch (B) to set the alarm.

6. Tap  (**Watts**) and enter a value to set a power limit.

7. Tap  (**During**), select a time limit (C) and tap **Set**.

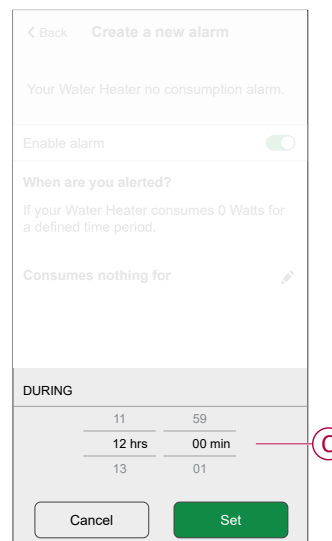
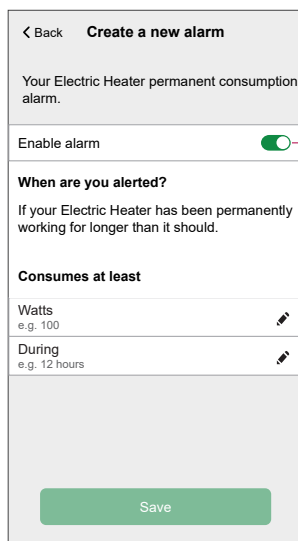



8. Tap **Save**.

Creating a schedule

The Heater can be controlled and triggered by a schedule. Once the schedule is set, your system will follow the active schedule. You can create or modify the schedules at any time.

To create a schedule:

1. On the **Home** screen, tap  > **Schedules** > .
2. Enter a name of the schedule (A).
3. Select a device type (B).
4. Select the list of devices (C) to which the schedule must apply.

5. Tap **Create**.

A notification window is shown - **The Wiser Home app creates an automatic schedule for your home. You can either keep or change it to suit your routine.**

6. Tap **See my schedule**.

If you wish to create a new schedule, follow these steps:

- a. Tap to add an event.
- b. Select a temperature (D), time period (E) and tap **Set**.

TIP:

- If you want to edit the existing event, tap and make the changes.
- You can add multiple schedules based on your requirement. Select days, tap , set on/off state and time.
- You can copy the existing schedule to another schedule or to the days of your choice. Tap .
 - Tap **Schedule** and select an existing schedule and tap **Copy**.
 - Tap **Day** and select the days you want to assign and tap **Copy**.
- When the schedule begins, you can see the **until time** on the **control** tab under the device name.



Automation

An automation allows you to trigger an action automatically or at scheduled times. By using the Wiser Home app, you can create automations based on your needs. This example demonstrates how a device works when the condition is met.

Creating an automation

The following is an example of creating an automation to boost for few hours when the heater is set to certain temperature.

To create an automation:

1. On the **Home** screen, tap  > **Automation** > .
2. Tap  and choose an icon that best represents your automation.
3. Enter a name of the automation (A) and select any of the following conditions to meet (B).
 - **All conditions:** All conditions must be met to trigger an automation
 - **Any condition:** Any one of the condition must be met to trigger an automation.
4. Tap **Add conditions** (C) and select any of the following (D):
 - **Device status change** (Select the device)
 - **Away Mode** (Enable or Disable)

NOTE: Maximum 10 conditions can be added.

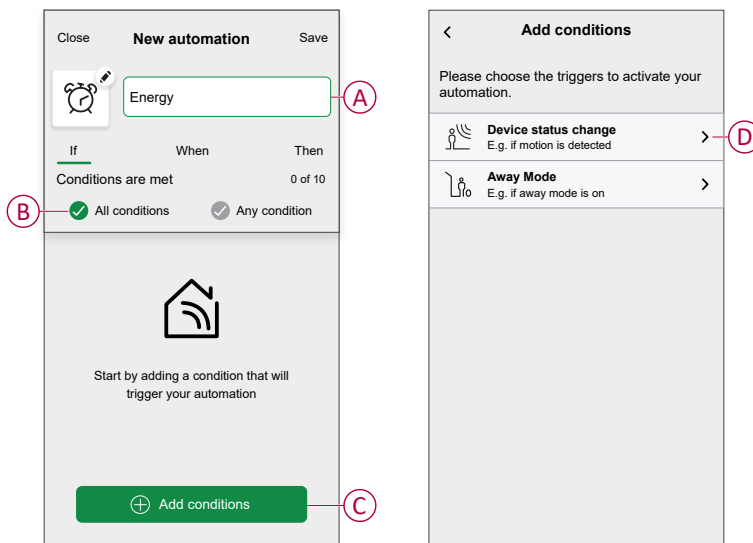

5. Select a device (E) that will set the condition and then select **Set point** (F).

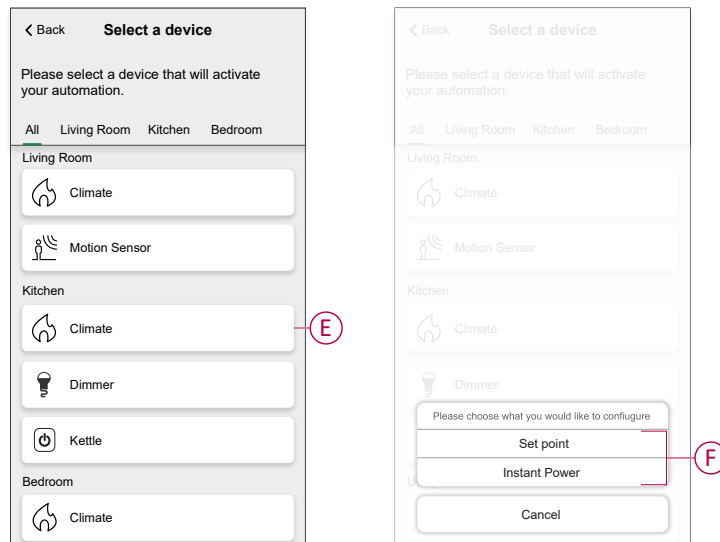

6. Select **less than** (G) and drag the sliding bar (H) up/down to set the temperature.

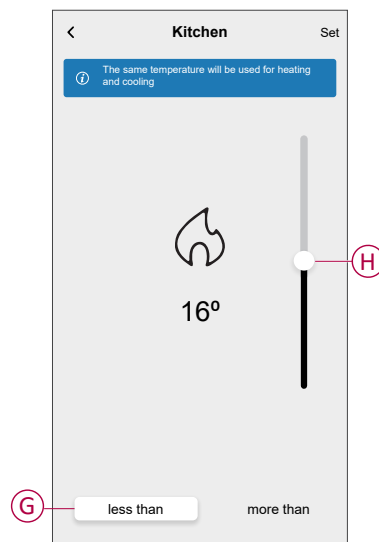

NOTE: To remove an added condition on the **Edit automation** screen, swipe left and tap .

7. To add an action, tap **Then > Add an action** and select any of the following: (1).

NOTE: Maximum 10 actions can be added.

- **Control a device:** Select a device that you want to trigger.
- **Send notification:** Turn on the notification for the automation.
- **Activate a moment:** Select the moment that you want to trigger.
- **Wait:** This option allows you to add a delay in an automation sequence. You can set the wait time in increments of 1 hour and 1 minute, up to a maximum of 24 hours. This feature is useful for delaying actions within an automation.

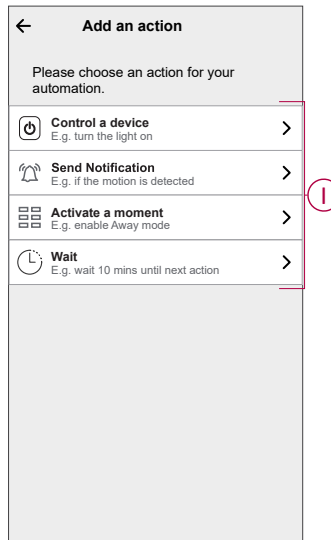

8. Tap **Control a device > Heater**, tap to turn ON/OFF and then tap **Set**.
9. Tap **Heater > Boost**, select the hour and tap **Set**.

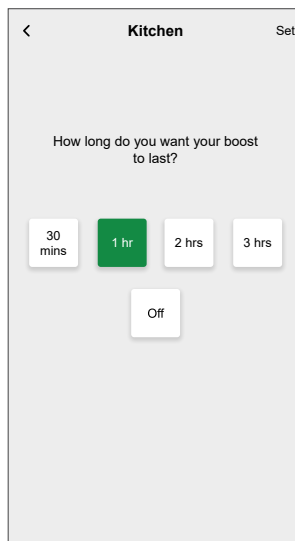



10. Tap **Save**.

The saved Automation is displayed on the **Automation** page. Tap the toggle switch to enable/disable the Automation.

Editing an automation

1. On the **Home** screen, tap **Automations** .
2. Go to **Automation**, tap the automation you want to edit.

3. On the **Edit automation** page, you can perform following changes:

- Change the icon .
- Rename the automation.
- Tap each condition to change the settings.
 - To remove a condition, slide the condition towards left and then tap  (A) to delete it.
 - Tap  **Add conditions** (B) to add new condition.
- To change the order of actions, tap the **Then** option, and hold an action then drag and drop to the desired position.

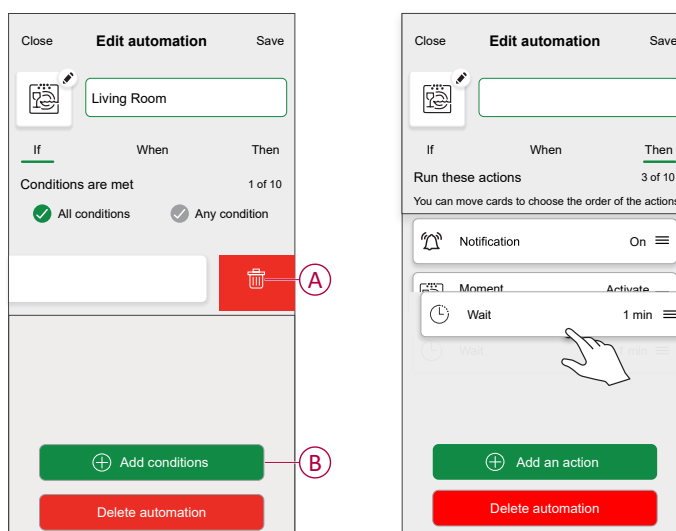

4. Tap **Save** to save the changes.

Deleting an automation

1. On the **Home** screen, tap **Automations** .
2. Go to **Automation**, tap the automation you want to delete.
3. On the **Edit automation** page, tap **Delete automation** (A) and read the confirmation message and then tap **OK** (B).

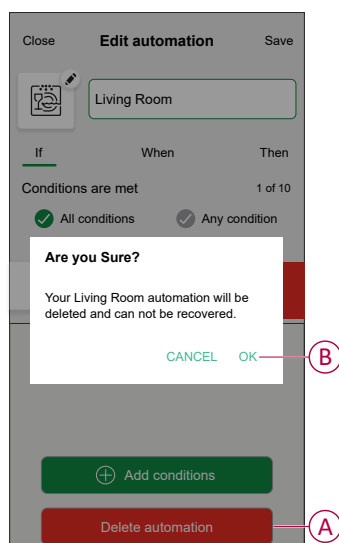



Moments

Moment allows you to group multiple actions that are usually performed together. By using the Wiser Home app, you can create moments based on your needs.

Creating a moment

To create a moment:

1. On the **Home** screen, tap  > **Moments** > .
2. Enter the name of the moment (A).
3. Tap **Add actions** (B) to select the list of devices.

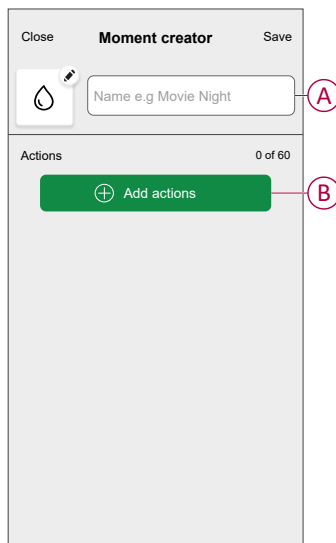

4. Select the devices (C) you want to set an action and tap **Done**.

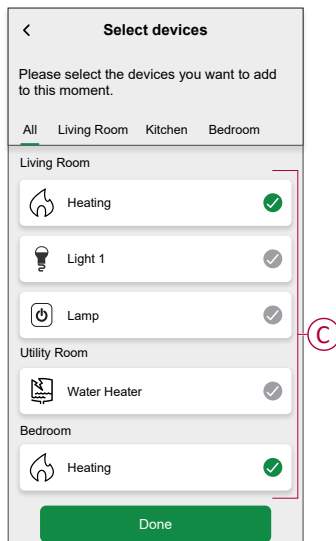

5. On the **Moment creator** page, select any one of the following device (D) and set actions.

6. Drag the sliding bar (E) up/down to set the temperature and tap **Set**.

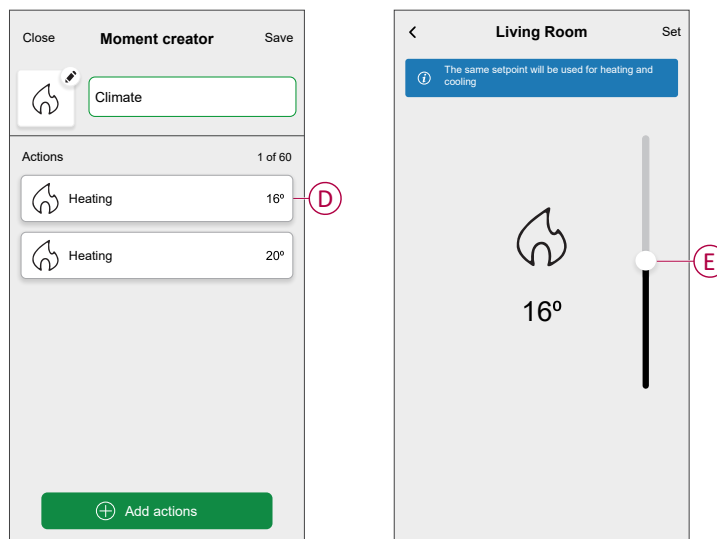

7. Once all conditions are set, tap **Save**.



The saved moment is shown on the **Moments** tab.

You can tap on the moment to enable it.

TIP:

- If you want to see the created moments on the **Home** screen, go to **Home** >  > **Home Screen** > **Moments**. Enable the toggle button to view moments on the **Home** screen.
- You can also rearrange the moments by tapping **Edit** from the Moments tab on the Home screen, or by tapping **Automation** > **Moments** > **Reorder**.

Editing a moment

1. On the Home screen, tap  > **Moments**.
2. Select the moment you want to edit .
3. On the **Moment Editor** page, you can tap each item to change the settings and tap **Save**.

Deleting a moment

1. On the Home screen, tap  > **Moments**.
2. Select the moment you want to delete .
3. On the **Moment Editor** page, tap **Delete** and tap **Ok**.

Removing the device

Using the Wiser Home app, you can remove the device from the Wiser system.

1. On the Home screen, tap .
2. Tap **Devices** > **Climate** > **FIP Micromodule** > **Delete**.
A confirmation window is prompted.

3. Tap **Remove from System**.

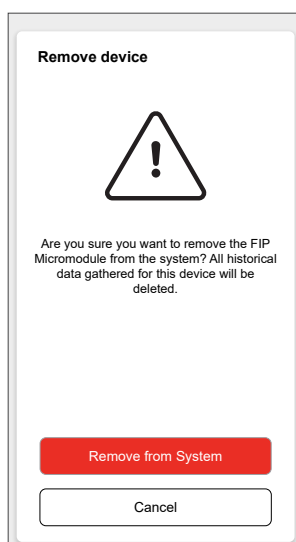

Removing the device will delete all the historical data.

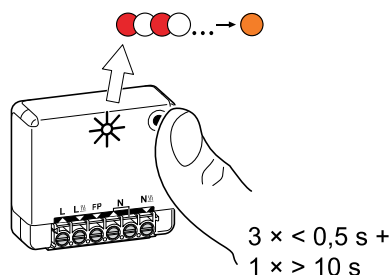

Resetting the device

You can reset the device to factory default manually.
Short press the Setup/Reset button of the module 3 times and then long press once (>10 s) on the module.





LED indication



Pairing the device

User Action	LED Indication	Status
Short press the push-button (PRESS) 3 times.	LED blinks amber once per second. 	Pairing mode is active for 30 seconds. When pairing is completed, LED displays green for a few seconds before turning Off. 

Resetting the device

User Action	LED Indication	Status
Short press the push-button (PRESS) 3 times and hold it down once for > 10 s.	LED blinks red once per second. 	The device is in reset mode. The device then restarts and LED turns amber indicating that the device is ready for pairing. 

Troubleshooting

Error	Possible cause	Solution
The device is not ready to pair after the device is removed from the app.	The device is not reset correctly.	Reset to factory default settings, refer to Resetting the device manually, page 23.
 Data not available in the Device Control Screen.	<ul style="list-style-type: none"> The device is offline. System/Hub is unable to receive data from the device. Ethernet connection is incorrect 	Restart the device. Also, ensure to correct the Ethernet connection.
 We are unable to implement your schedule and are working on fixing it as soon as possible. displayed in the Reduce My Bill page.	Internet or technical issue.	Wait for sometime until the schedule is available.

Technical data

Power supply	230 V AC, 50 Hz
Switching capabilities	230 V AC, 16 A
Power consumption	< 1 W
Max. Power	3680 W, Integrated Zero crossing
Operation Ambient temperature	-20 °C to 35 °C
Connecting terminals	Screw terminals: 1 x 1 - 2.5 mm ²
Protection rating	IP20
Communication Protocol	Zigbee 3.0 (certified)
Radio frequency range	2.4 GHz
Dimensions (W x L x H)	40 x 44 x 16.9 mm
Max. radio-frequency power transmitted	< 10 mW

Compliance

Product Environmental Data

Find and download comprehensive environmental data about your products, including RoHS compliance and REACH declarations as well as Product Environmental Profile (PEP), End-of-Life instructions (EOLi) and much more.

<https://www.se.com/myschneider>



General information about Schneider Environmental Data Program

Click the link below to read about Schneider Electric's Environmental Data Program.

<https://www.se.com/ww/en/about-us/sustainability/environmental-data-program/>



EU Declaration of Conformity

Hereby, Schneider Electric Industries, declares that this product is in compliance with the essential requirements and other relevant provisions of RADIO DIRECTIVE 2014/53/EU. Declaration of conformity can be downloaded on [se.com/docs](https://www.se.com/docs).

Trademarks

This guide makes reference to system and brand names that are trademarks of their relevant owners.

- Zigbee® is a registered trademark of the Connectivity Standards Alliance.
- Apple® and App Store® are brand names or registered trademarks of Apple Inc.
- Google Play™ Store and Android™ are brand names or registered trademarks of Google Inc.
- Wi-Fi® is a registered trademark of Wi-Fi Alliance®.
- Wiser™ is a trademark and the property of Schneider Electric, its subsidiaries and affiliated companies.
- Amazon Alexa™ is a trademark of AMAZON TECHNOLOGIES, INC.
- Google Home™ is a trademark of Google INC.

Other brands and registered trademarks are the property of their respective owners.

Printed in:
Schneider Electric
35 rue Joseph Monier
92500 Rueil Malmaison - France
+ 33 (0) 1 41 29 70 00

Schneider Electric
35 rue Joseph Monier
92500 Rueil Malmaison
France

+ 33 (0) 1 41 29 70 00

www.se.com

As standards, specifications, and design change from time to time, please ask for confirmation of the information given in this publication.

© 2024 – 2025 Schneider Electric. All rights reserved.

DUG_Wiser_Micromodule for Fil Pilote radiators_WH-03