

# Iconic Connected Switch 2 AX

## Device user guide

Information about features and functionality of the device.

09/2024



# Legal Information

The information provided in this document contains general descriptions, technical characteristics and/or recommendations related to products/solutions.

This document is not intended as a substitute for a detailed study or operational and site-specific development or schematic plan. It is not to be used for determining suitability or reliability of the products/solutions for specific user applications. It is the duty of any such user to perform or have any professional expert of its choice (integrator, specifier or the like) perform the appropriate and comprehensive risk analysis, evaluation and testing of the products/solutions with respect to the relevant specific application or use thereof.

The Schneider Electric brand and any trademarks of Schneider Electric SE and its subsidiaries referred to in this document are the property of Schneider Electric SE or its subsidiaries. All other brands may be trademarks of their respective owner.

This document and its content are protected under applicable copyright laws and provided for informative use only. No part of this document may be reproduced or transmitted in any form or by any means (electronic, mechanical, photocopying, recording, or otherwise), for any purpose, without the prior written permission of Schneider Electric.

Schneider Electric does not grant any right or license for commercial use of the document or its content, except for a non-exclusive and personal license to consult it on an "as is" basis.

Schneider Electric reserves the right to make changes or updates with respect to or in the content of this document or the format thereof, at any time without notice.

**To the extent permitted by applicable law, no responsibility or liability is assumed by Schneider Electric and its subsidiaries for any errors or omissions in the informational content of this document, as well as any non-intended use or misuse of the content thereof.**

---

# Table of Contents

Safety Information.....	4
Iconic Connected Switch 2AX.....	5
For your safety .....	5
About the device.....	5
Installing the device .....	6
Pairing the device .....	6
Configuring the device .....	7
Setting the device location .....	7
Setting up the LED Indicator Behaviour .....	8
Using the device .....	9
Switching on/off the device manually .....	9
Turning On/Off device using app .....	10
Schedule.....	10
Moments.....	12
Automation.....	15
Resetting the device manually .....	21
LED Indication.....	22
Troubleshooting .....	22
Technical data .....	23
Compliance.....	24
Compliance information for Green Premium products.....	24
Trademarks.....	24

# Safety Information

## Important Information

Read these instructions carefully and look at the equipment to become familiar with the device before trying to install, operate, service, or maintain it. The following special messages may appear throughout this manual or on the equipment to warn of potential hazards or to call attention to information that clarifies or simplifies a procedure.



The addition of either symbol to a “Danger” or “Warning” safety label indicates that an electrical hazard exists which will result in personal injury if the instructions are not followed.



This is the safety alert symbol. It is used to alert you to potential personal injury hazards. Obey all safety messages that accompany this symbol to avoid possible injury or death.

### **DANGER**

**DANGER** indicates a hazardous situation which, if not avoided, **will result in** death or serious injury.

**Failure to follow these instructions will result in death or serious injury.**

### **WARNING**

**WARNING** indicates a hazardous situation which, if not avoided, **could result in** death or serious injury.

### **CAUTION**

**CAUTION** indicates a hazardous situation which, if not avoided, **could result in** minor or moderate injury.

### **NOTICE**

NOTICE is used to address practices not related to physical injury.



# Iconic Connected Switch 2AX



**41E2PBSWMZ-VW**  
**PDL356PB2MBTZ-VW**

## For your safety

### **⚠ DANGER**

#### **HAZARD OF ELECTRIC SHOCK, EXPLOSION, OR ARC FLASH**

- It is illegal for persons other than an appropriately licensed electrical contractors or other persons authorised by legislation to work on the fixed wiring of any electrical installation.
- To comply with all safety standards, the device must be used only for the purpose described in this instruction and must be installed in accordance with the wiring rules and regulation in the location where it is installed.
- Lock out and tag the input circuit before accessing the wiring connections.
- The Locking Bar on the grids must be set to the Closed position to ensure that the device cannot be removed during normal operation.
- There are no user serviceable parts inside the device.

**Failure to follow these instructions will result in death or serious injury.**

### **NOTICE**

#### **EQUIPMENT DAMAGE HAZARD (LOAD AND OPERATION)**

- Operation of the device at elevated temperatures or voltages outside of specification (240 V A.C. and 25 °C) may cause the over-temperature protection circuitry to operate.
- Reduce the size of the connected load or use a different brand of fan to prevent recurrence.
- Do not operate the product for prolonged periods in extreme conditions.

**Failure to follow these instructions can result in equipment damage.**

## About the device

The Iconic Connected Switch 2AX(hereinafter referred to as **relay switch**) operates as a switch “out-of-the-box”, with no configuration needed. The relay switch is available with Zigbee connectivity and can be used as a single device within a Wiser network. To do this, the relay switch must be paired to the Wiser Hub using the Wiser Home app.



## Installing the device

Refer to the installation instruction supplied with this product.

See Iconic Connected Switch 2AX, Zigbee/BLE.

## Pairing the device

Using the Wiser Home app, pair your relay switch with the **Wiser Hub** to access and control the relay switch.

1. On the Home page, tap .
2. Tap **Devices** >  > **Lights** >  **Iconic switch/dimmer** > **Next**.

**NOTE:** The next screen shows the joining process of relay switch.

3. Short press the push button 3 times and make sure that the LED blinks amber.

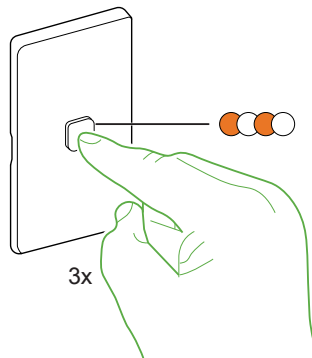

4. Wait for a few seconds until the LED turns green. You can also see in the app that the device is joined.

**NOTE:** If the LED is blinking green and red, see the instructions by tapping the link **LED blinking green and red?**

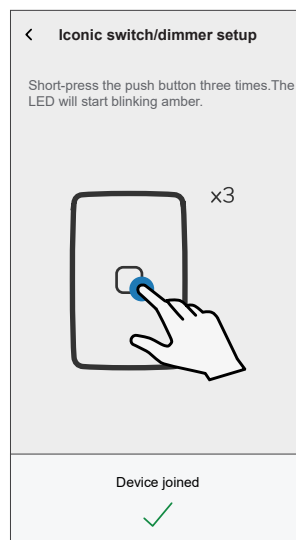

5. Tap **Next** to enter the name of the device and assign the device to a new room or an existing room.





The relay switch is now listed under **All** devices.

## Configuring the device

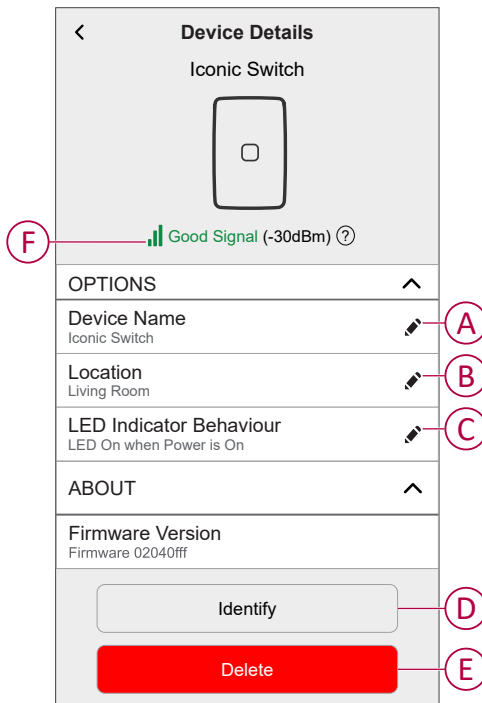
Using the Wiser home app, you can configure the device according to your preferences.



1. On the Home page, tap .
2. Tap **Devices > Lights > Relay switch** to locate to the **Device Details** screen.



<b>A</b>	<b>Device Name:</b> Tap to change the name of the device.
<b>B</b>	<b>Location:</b> Tap to assign the Device to any room (such as living room, bedroom, kitchen etc). Refer to <a href="#">Setting the device location</a> , page 7 for more details on how to set the location.
<b>C</b>	<b>LED Indicator Behaviour:</b> Tap to set the LED indicator behaviour of the device as per your preference. Refer to <a href="#">Setting up the LED Indicator Behaviour</a> , page 8 for detailed information on each option.
<b>D</b>	<b>Identify:</b> Tap to identify the device. The status LED blinks red and connected lighting devices blinks On/Off, upon successful identification of the switch. Tap <b>OK</b> when you finish identifying the device.
<b>E</b>	<b>Delete:</b> Tap to remove the device from the system. <b>NOTE:</b> <ul style="list-style-type: none"> <li>• Removing the device will also reset the switch. After reset, the LED turns amber indicating that the switch is ready for pairing.</li> <li>• If there is a problem while pairing or resetting the switch, refer to <a href="#">Resetting the device manually</a>, page 21</li> </ul>
<b>F</b>	<b>Zigbee Signal Strength Indicator:</b> Zigbee Signal Strength indicator which displays the current signal strength of the device. <ul style="list-style-type: none"> <li>•  Good Signal (between 0 &amp; -54dBm)</li> <li>•  Normal Signal (between -54 &amp; -79dBm)</li> <li>•  Poor Signal (&lt;-79dBm)</li> <li>•  No Signal (device is offline)</li> </ul>

## Setting the device location

You can change the device location using Wiser Home app (such as bedroom, living room, dining room etc.).

1. On the Home page, tap .
2. Tap **Devices**, select the device from the list for which you wish to change the location.
3. Tap **Location**  to open setup page.
4. On setup page, you can enter **New room name** (A) or select an existing room from the list (B).

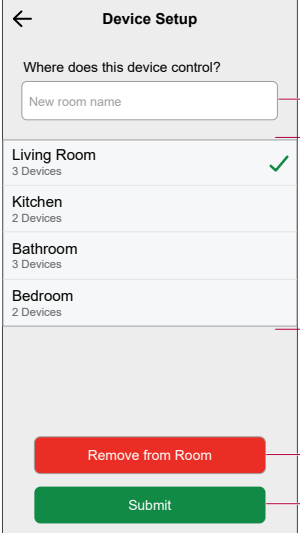

**TIP:** If the device is already assigned, you can remove it from the existing room. Tap **Remove from Room** (C).

5. Once changes are done, tap **Submit** (D).

## Setting up the LED Indicator Behaviour

Using the Wiset Home app, you can set the behaviour of the LED indicator on your device to identify the device status.

1. On the Home page, tap .
2. Tap **Devices > Lights**.
3. Select the device you want to update and tap **LED Indicator Behaviour**.

**NOTE:** If you are unable to find the option in your app, reset the device to factory default and perform the pairing process.

4. Select one of the following options as per your preference.

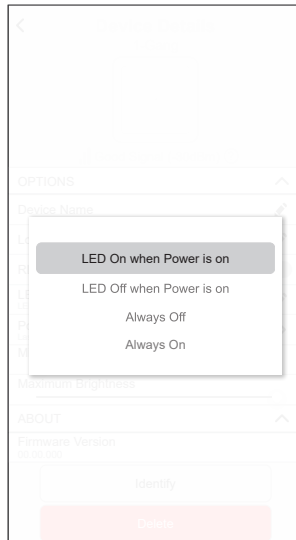

<b>LED On when Power is on</b>	The LED turns On when the device is On.
<b>LED Off when Power is on</b>	The LED turns Off when the device is On.
<b>Always Off</b>	The LED stays Off all the time.
<b>Always On</b>	The LED stays On all the time.

## Using the device

### Switching on/off the device manually

You can switch on/off the device manually. The device will provide power to the electrical appliance connected to it.

Short press the push button once to turn on/off the iconic switch.

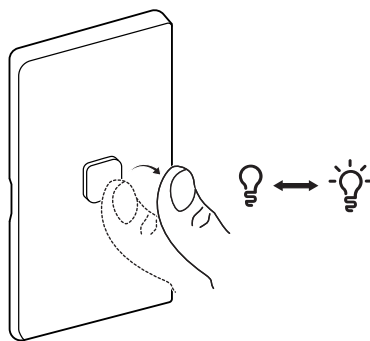

## Turning On/Off device using app

Using the Wiser Home app, you can turn On/Off the relay switch remotely.

Follow the steps to turn On/Off the relay switch using the app:

1. Go to the Home page, tap **All** and find the device.
2. Tap  (A) to turn On/Off relay switch.

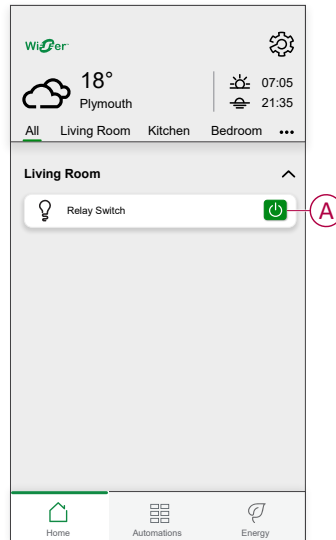



## Schedule

You can set up schedules to specify the times at which a state of the device changes.

### Setting up a schedule

The relay switch can be fully controlled by a schedule. Once the schedule is set, the relay switch operates at a given time.

1. On the **Home** page, tap .
2. Go to **Schedules** and tap  to create a schedule.
3. Enter the name of the schedule (A).
4. In the **TYPE** menu, select **Lights** (B).
5. In the **APPLIES TO** menu, select **Relay Switch** (C) from the listed devices.

6. Tap **Create** to setup events.



The screenshot shows a 'New schedule' form with the following fields and callouts:

- NAME:** A text input field labeled 'Schedule Name' with a red circle 'A' next to it.
- TYPE:** A section with two radio buttons: 'Lights' (selected) and 'Shutters'. A red circle 'B' is next to the 'Lights' option.
- APPLIES TO:** A section with a radio button labeled 'Relay Switch' which has a green checkmark next to it. A red circle 'C' is next to the checkmark.
- Create:** A green button at the bottom of the form.

7. Under **EVENTS** menu, select a day and then Tap  to add an event such as **STATE** (lights On/Off) and **WHEN** (sunrise/sunset or specific time range).

8. Tap **Set** to save the schedule.

**TIP:**

- You can add multiple schedules based on your requirement. Select days, tap , set on/off state and time.
- You can copy the existing schedule to another schedule or to the days of your choice. Tap .
  - Tap **Schedule** and select an existing schedule and tap **Copy**.
  - Tap **Day** and select the days you want to assign and tap **Copy**.

## Editing a schedule

- On the Home page, tap  > **Schedules**
- Tap the schedule you want to edit.



3. Tap the **SCHEDULE DETAILS** and you can do the following actions:
  - Rename the schedule (A).
  - Within the **Applies to** (B) menu, you have the option to select from the listed devices or deselect those that are already selected.
  - Under the **EVENTS** (C) menu, you can edit the day and then tap  to edit an event such as **STATE** (lights Off or dimming level in %) and **WHEN** (sunrise/sunset or specific time range).

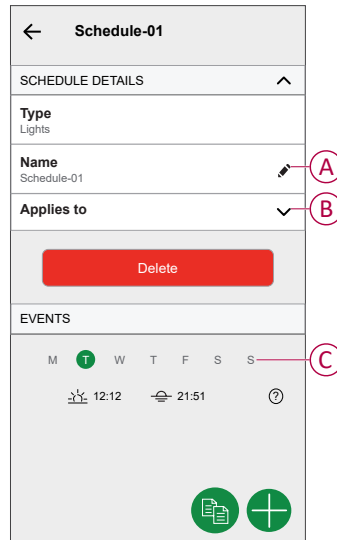

**NOTE:** When the above changes are edited, the schedule is saved automatically.



## Deleting a schedule

1. On the Home page, tap **Automations**  > **Schedules**.
2. Tap the schedule you want to delete.
3. Tap the **SCHEDULE DETAILS** and then tap **Delete**.

## Moments

Moment allows you to group multiple actions that are usually performed together. By using the Wiser Home app, you can create moments based on your needs.

## Creating a moment

1. On the **Home** page, tap .
2. Go to **Moments** and tap  to create a moment.
3. Enter the name of the moment (A).

**TIP:** You can choose the cover image that represents your moment by tapping .

4. Tap **Add actions** (B) to select the list of devices.

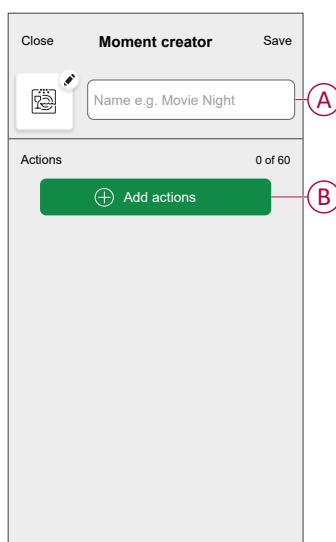

5. In the **Add actions** menu, you can select the devices (C).

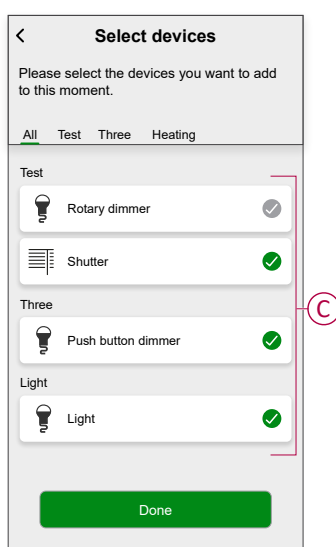



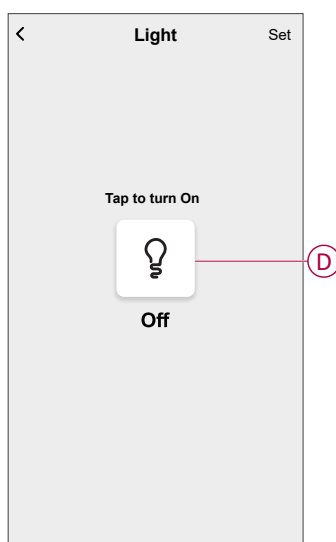

6. Once the device are selected, tap **Done**.
7. On the **Moment creator** page, tap the device to set the condition. For example, it is a relay switch:
- Tap to turn on (D) and tap **Set** on the upper right corner.



- After setting all conditions, tap **Save**.

Once the moment is saved, it will appear on the **Moments** tab. Tap on the moment to enable it.

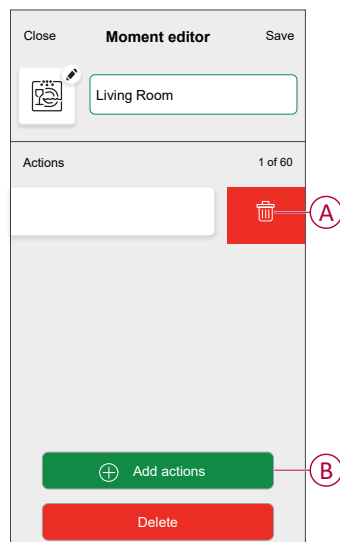

## Editing a moment

- On the **Home** page, tap **Automations** .
- Go to **Moments**, locate the moment you want to edit and tap .
- On the **Moment editor** page, you can perform following changes:
  - Change the icon .
  - Rename the moment.
  - Tap each action to change the settings.
    - To remove an action, slide the action to the left and then tap  (A) to delete it.
    - Tap  **Add actions** (B) to add new action.



- Tap **Save**, to save the changes.

## Deleting a moment

- On the **Home** page, tap **Automations** .
- Go to **Moments**, locate the moment you want to delete and tap .

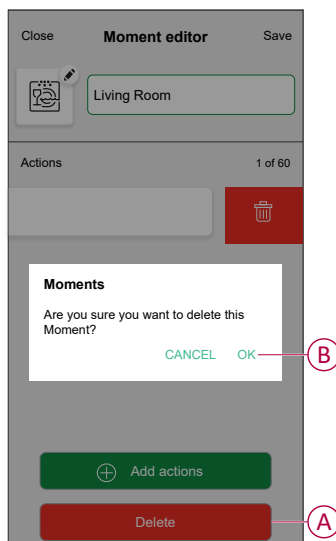

3. On the Moment editor page, tap **Delete** (A) and then tap **Ok** (B).



## Automation

An automation allows you to trigger an action automatically or at scheduled times. By using the Wiser Home app, you can create automations based on your needs. This example demonstrates how a device works when the condition is met.

### Creating an automation

1. On the **Home** page, tap .
2. Go to **Automation** and then tap  to create an automation.
3. Enter a name of the automation (A) and select any of the following conditions to trigger an automation.
  - **All conditions:** All conditions must be met to trigger an automation
  - **Any condition:** Any one of the condition must be met to trigger an automation.

**TIP:** You can choose the cover image that represents your automation by tapping .

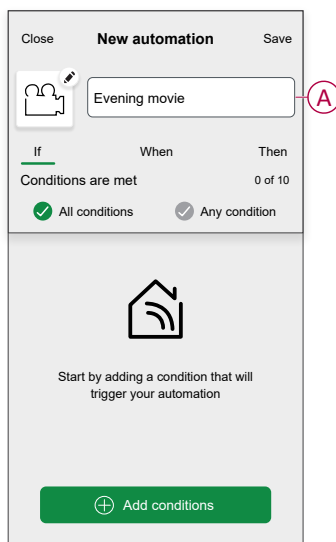

4. Tap **Add conditions** (B) and select any of the following (C):

- **Device status change** (Select the device): An automation will be triggered based on a device status, such as the opening of a shutter or the detection of movement by a motion sensor.
- **Away Mode** (Enable or Disable): Away mode can also trigger an automation to turn on the lights, close the shutter etc. For more information about **Away Mode**, refer to the system user guide.

**NOTE:** Maximum 10 conditions can be added.

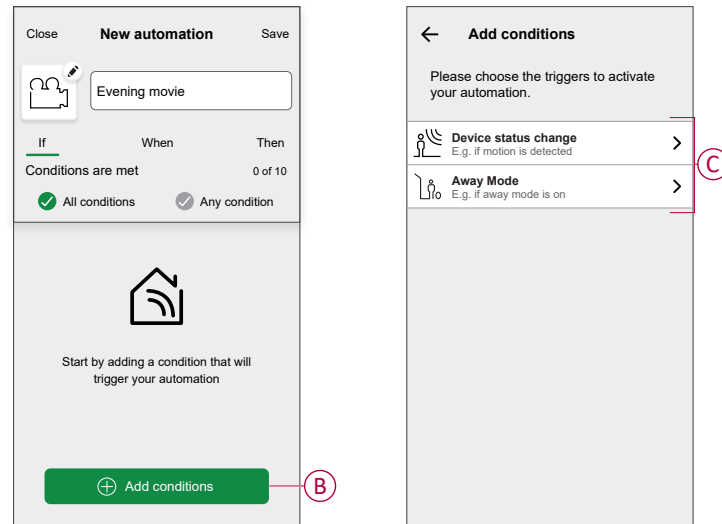

- a. In this example, we will select **Device status change** and choose a device to set the condition. Then, we will select the state of the device that will trigger the automation, such as the closed state of a .

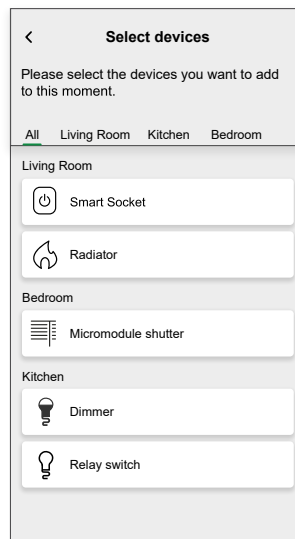

- b. After selecting the device, tap **Set** on the upper right corner.

**TIP:** If you want to change the condition, swipe it to the left and tap the bin icon. Then add a new condition with the required parameters.

5. To start your automation at a particular time, tap **When > Add time** and select any of the following (D):

**NOTE:** Maximum 10 time entries can be added.

- **Specific time of day** - The automation will trigger at a specific time of the day, such as at sunrise, sunset, or at 8:00 AM.
- **Period of time** - The automation will be trigger during time periods such as from sunrise to sunset, from sunset to sunrise, or from 8:00 AM to 5:00 PM.

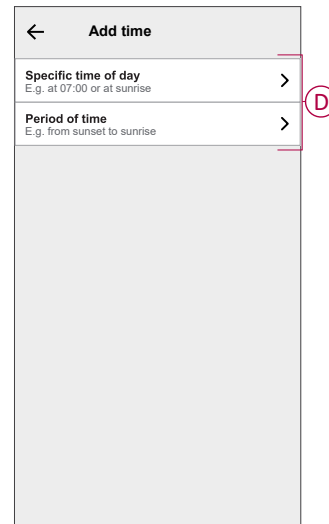
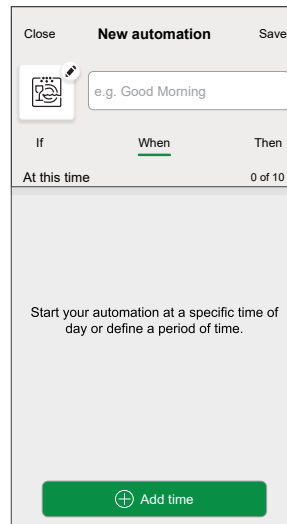

6. To add an action, tap **Then > Add an action** and select any of the following (E):

**NOTE:** Maximum 10 actions can be added.

- **Control a device** - Select the device and set the desired state of the device.
- **Send notification** - You will be notified if the condition is met.
- **Activate a moment** - Select a Moment to activate during the automation.
- **Wait** - This option allows you to add a delay in an automation sequence. You can set the wait time in increments of 1 hour and 1 minute, up to a maximum of 24 hours. This feature is useful for delaying actions within an automation.

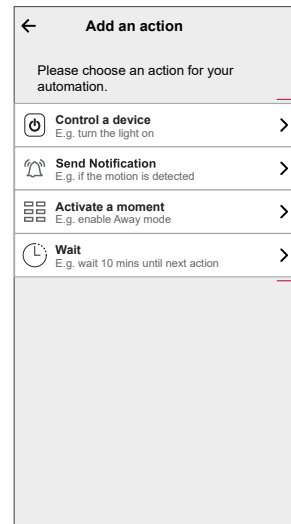
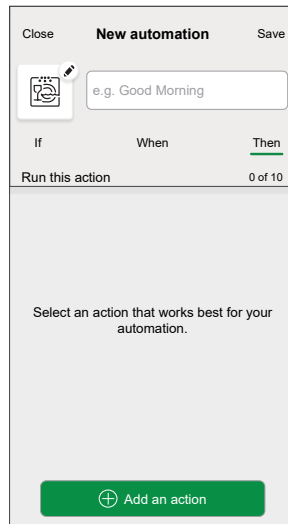

- a. In this example, we will select for **Control a device** and choose **Relay switch** (F) as the device to trigger an action.

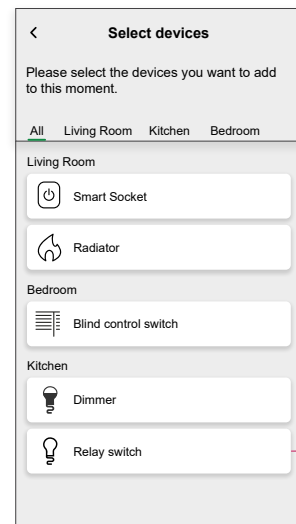
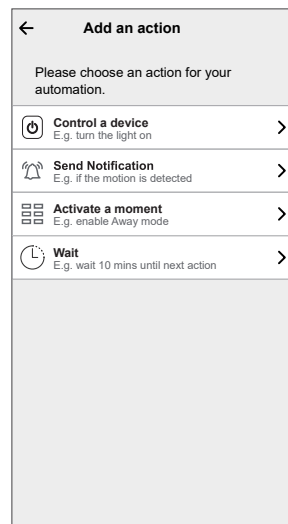

- b. Set the state, such as turning the relay switch On/Off. Then, tap **Set** located on the upper right corner



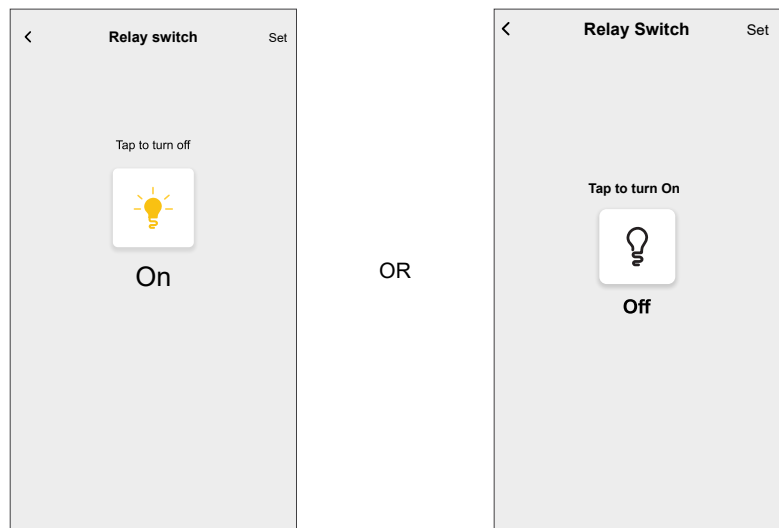

- c. Again, tap **Add an action** and select **Wait** option.
- d. Scroll through the minutes and set the wait time to 1 minute. Then, tap **Set** located on the upper right corner.

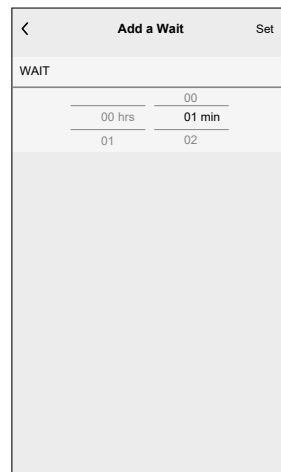



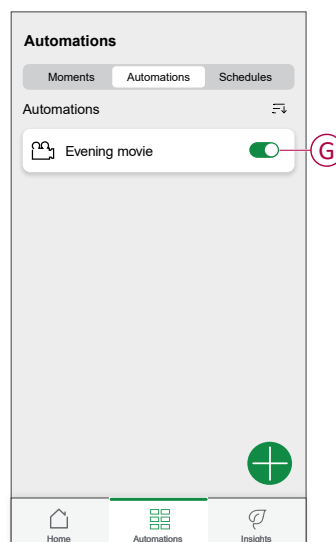

7. Tap **Save**.

The saved automation is displayed on the **Automation** page. Tap the toggle switch (G) on the Automation page to enable/disable the Automation.



## Editing an automation

- On the **Home** page, tap **Automations** .
- Go to **Automation**, tap the automation you want to edit.
- On the **Edit automation** page, you can perform following changes:
  - Change the icon .
  - Rename the automation.
  - Tap each condition to change the settings.
    - To remove a condition, slide the condition towards left and then tap  (A) to delete it.
    - Tap  **Add conditions** (B) to add new condition.
  - To change the order of actions, tap the **Then** option, and hold an action then drag and drop to the desired position.

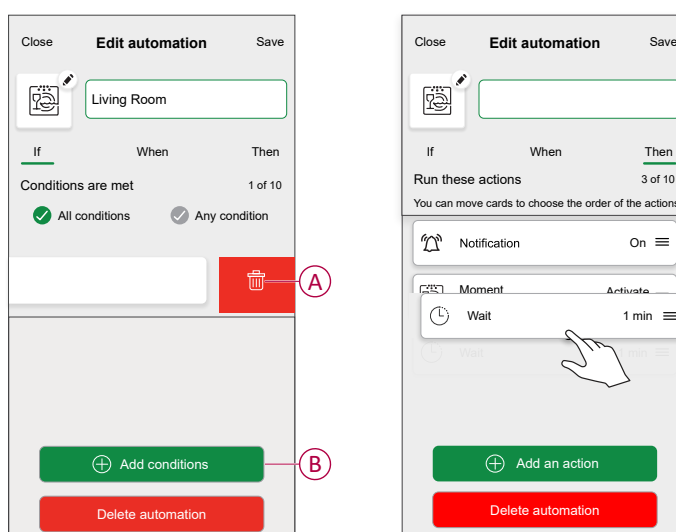

- Tap **Save** to save the changes.

## Deleting an automation

- On the **Home** page, tap **Automations** .
- Go to **Automation**, tap the automation you want to delete.

3. On the **Edit automation** page, tap **Delete automation** (A) and read the confirmation message and then tap **OK** (B).

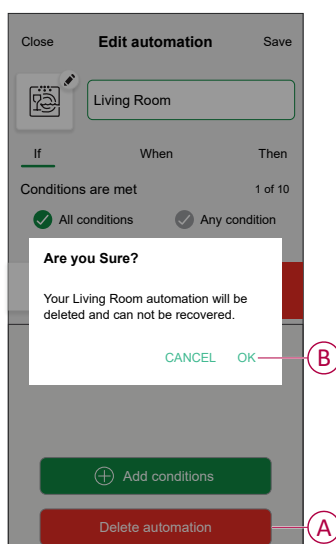

## Resetting the device manually

You can reset the device to factory default manually.

Short press the push button three times ( $<0,5$  s) and then long press the push button once ( $>10$  s).



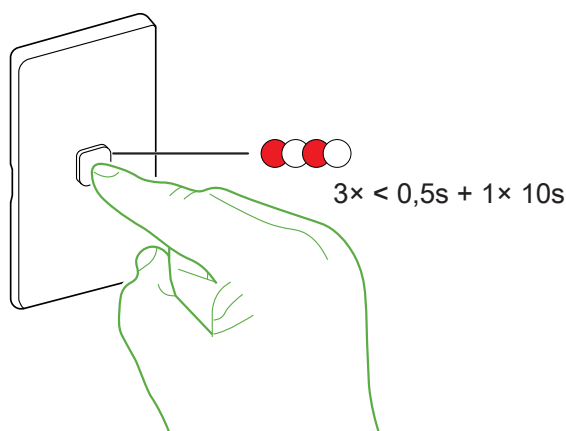

After 10 s, release the push button when the LED starts blinking red.



**NOTE:** After reset, the LED turns amber/orange indicating that device is ready for pairing.

## LED Indication



### Pairing

User Action	LED Indication	Status
Press the push-button 3 times	<p>LED blinks amber/orange</p>  <p>LED blinks orange for Zigbee.</p>  <p>LED blinks red green, for Bluetooth.</p> 	<p>Pairing mode is active for 30 seconds. When pairing is completed, LED glows green for some time before turning off.</p> 

### Changing protocol

User Action	LED Indication	Status
Short press the push-button 3 times and long press once for > 20 s.	LED blinks red rapidly indicating commence of protocol change. 	<p>On successful change in protocol:</p> <ul style="list-style-type: none"> <li>Zigbee to Bluetooth - No colour indication, white back light only.</li> <li>Bluetooth to Zigbee - Flashing Amber LED (Indicating that device is in pairing mode), if pairing is not completed will become solid Amber</li> </ul>

### Resetting

User Action	LED Indication	Status
Press the push-button 3 times and long press once for > 10 s.	<p>After 10 s, the LED blinks red.</p> 	<p>The device resets to the factory default after 10 seconds. The device then restarts and the LED blinks amber/orange indicating that it is ready for pairing.</p>  <p>For Zigbee, the device is reset to the factory settings after 10 seconds. The device then restarts and the LED blinks orange indicating that it is ready for pairing.</p>  <p>For Bluetooth, the device is reset to the factory settings after 10 seconds and the device turns off.</p>



### LED Indicator Mode

Load Status	ON	OFF
Reverse with load	No LED	White LED is on
Consistent with load	White LED is on	No LED
Always Off	No LED	No LED
Always On	White LED is on	White LED is on

## Troubleshooting

Error	Possible cause	Solution
The device is not ready to pair after the device is removed from the app.	The device is not reset correctly.	Reset to factory default settings, refer to Resetting the device manually, page 21.

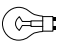
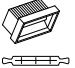
## Technical data

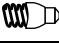
Nominal power rating for load type		
Load type	Load name	Load value
	Incandescent lamp	2 A
	Halogen lamp	2 A
	lighting transformer	2 A
	Fluorescent lamp	2 A
L	Inductive load	2 A @ 0.6 PF

Nominal voltage	AC 220-240 V, 50 Hz
Nominal current	2 A
Switching technique	Relay
Protection	Over temperature: Yes Short circuit: No Over-current fuse: No Thermal protection: Yes
LED indicator	Yes
Supported protocols	Zigbee, BLE
Mutli-gang plate capacity	Max 6 primary mechs per plate
Compatible plate ranges	Iconic, Iconic Styl, Iconic Essence, Pro Series
Mounting centers	84 mm pattern plate
Safety compliance	AS/NZS 60669.2.1
EMC emission compliance	
IP rating	IP20
Communication protocol	Zigbee, BLE
Operating humidity	5%-90% RH, non-condensing
Specifications typical at 25 °C	

### Compliance

Safety	AS/NZS 60669.2.1
EMC	AS/NZS 60669.2.1
RF	AS/NZS 4268

# Compliance

## Compliance information for Green Premium products

Find and download comprehensive information about Green Premium products, including RoHS compliance and REACH declarations as well as Product Environmental Profile (PEP) and End-of-Life instructions (EOLI).

<https://checkaproduct.se.com/>



## General information about Green Premium products

Click the link below to read about Schneider Electric's Green Premium product strategy.

<https://www.schneider-electric.com/en/work/support/green-premium/>



## Trademarks

This guide makes reference to system and brand names that are trademarks of their relevant owners.

- Zigbee® is a registered trademark of the Connectivity Standards Alliance.
- Apple® and App Store® are brand names or registered trademarks of Apple Inc.
- Google Play™ Store and Android™ are brand names or registered trademarks of Google Inc.
- Wi-Fi® is a registered trademark of Wi-Fi Alliance®.
- Wiser™ is a trademark and the property of Schneider Electric, its subsidiaries and affiliated companies.

Other brands and registered trademarks are the property of their respective owners.





Schneider Electric (Australia) Pty Ltd  
33-37 Port Wakefield Road  
Gepps Cross SA 5094  
Australia

Customer Care: 13 73 28

[www.clipsal.com](http://www.clipsal.com)

As standards, specifications, and design change from time to time,  
please ask for confirmation of the information given in this publication.

© 2024 – 2024 Schneider Electric. All rights reserved.

DUG\_Iconic Switch 2 AX\_WHP-01